

# Semoran Shopping Center

**DEMETREE**  
GLOBAL

**FOR LEASE | RESTAURANT**



**490 N SEMORAN BLVD, WINTER PARK, FL 32792**

Semoran Shopping Center proudly presents a 2,850 SF second-generation restaurant space with a drive-thru, located at the prime intersection of Aloma Ave and Semoran Blvd (SR 426/SR 436). Offering excellent frontage and visibility on SR 436, this location provides easy access and abundant parking, with cross-access to Semoran Shopping Center. Just minutes from downtown Winter Park and less than a mile from Full Sail University, this is an ideal opportunity for a restaurant looking to capitalize on a high-traffic area with growing residential and commercial developments.

## PROPERTY HIGHLIGHTS:

- Prime 2,850 square foot second-generation restaurant space with drive-thru available for lease.
- Highly traveled, prominent intersection of Aloma Ave and Semoran Blvd (SR 426/SR 436).
- Offering excellent frontage and visibility on SR 436, with pylon signage available.
- Combined traffic count reaching 96,500 AADT.
- Minutes from Downtown Winter Park, located between Rollins College and Full Sail University.
- Co-tenants include: Advance Auto Parts, Friendly Confines, and Habaneros Mexican Grill.
- New 178-unit Calirosa Winter Park 55+ senior living luxury community located across the street.
- Less than 1 mile from Full Sail University.
- Abundant parking.

2023 DEMOGRAPHICS	1 MILE	3 MILES	5 MILES
Population	14,308	96,552	263,952
Total Daytime Population	12,056	70,975	211,479
Median Age	37.1	37.1	38.0
Average HH Income	\$77,419	\$102,883	\$98,219



**21,000+** Full Sail Univ. Students

2023 total



**70,975** Employees

in 3 miles



**\$102,883** HH Income

in 3 miles

**Contact us now for more information**

**RUSTY STOECKEL**  
BROKER/ASSOCIATE  
(407) 440-5424  
rusty@dresi.com

**LUC PICOTTE**  
SALES ASSOCIATE  
(425) 275-3346  
lpicotte@demetreeglobal.com

Demetree Global  
941 W. Morse Blvd, Suite 315 | Winter Park, FL 32789  
[DemetreeGlobal.com](http://DemetreeGlobal.com)

No warranty or representation, expressed or implied, is made as to the accuracy of the information contained herein, and same is submitted subject errors, omissions, change of price, rental or other conditions, withdrawal without notice, and to any special listing and conditions imposed by our principals.

# Trade Area Aerials

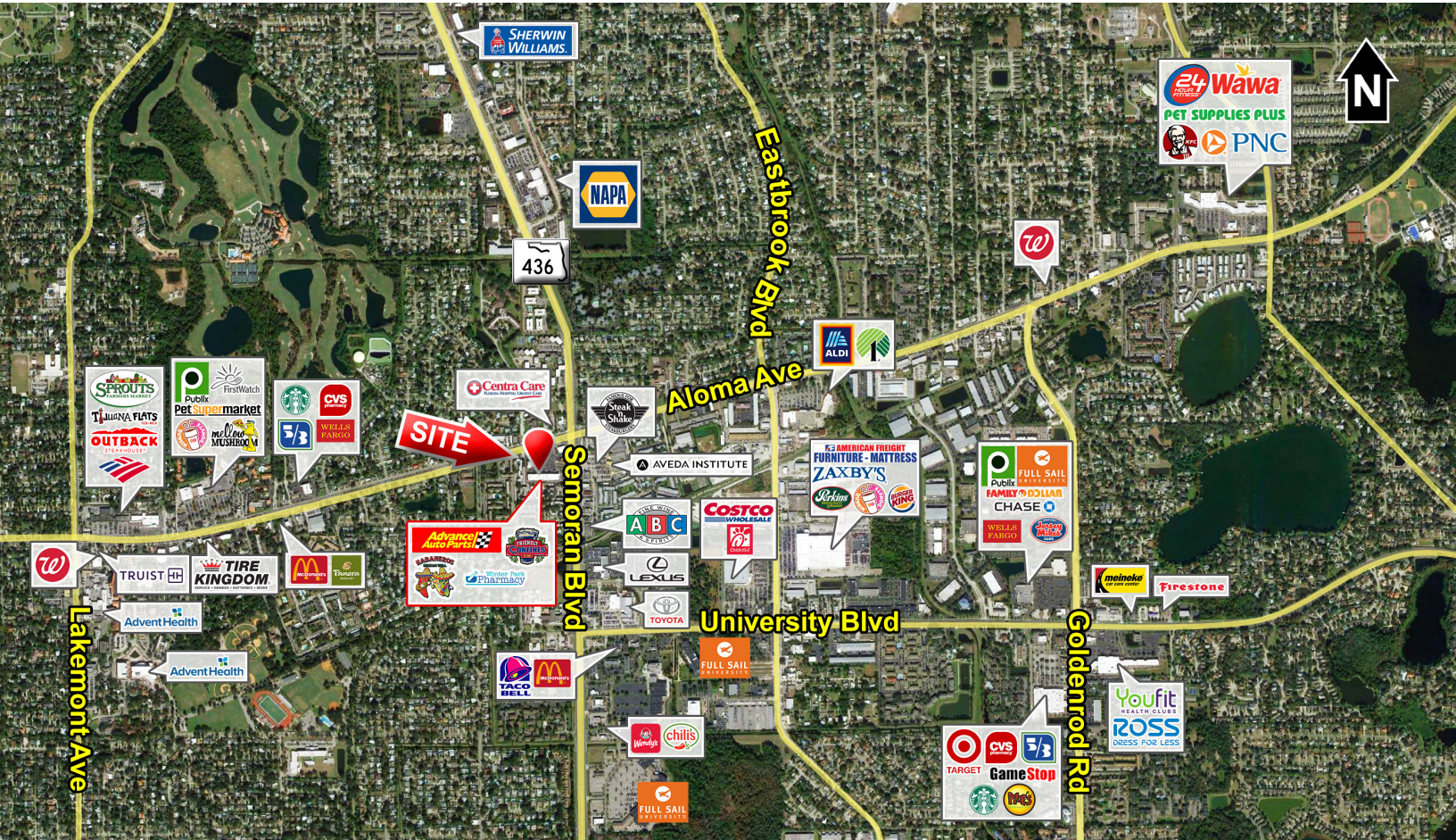

# Space 490 Photos (2,850 SF)



# Site Plan

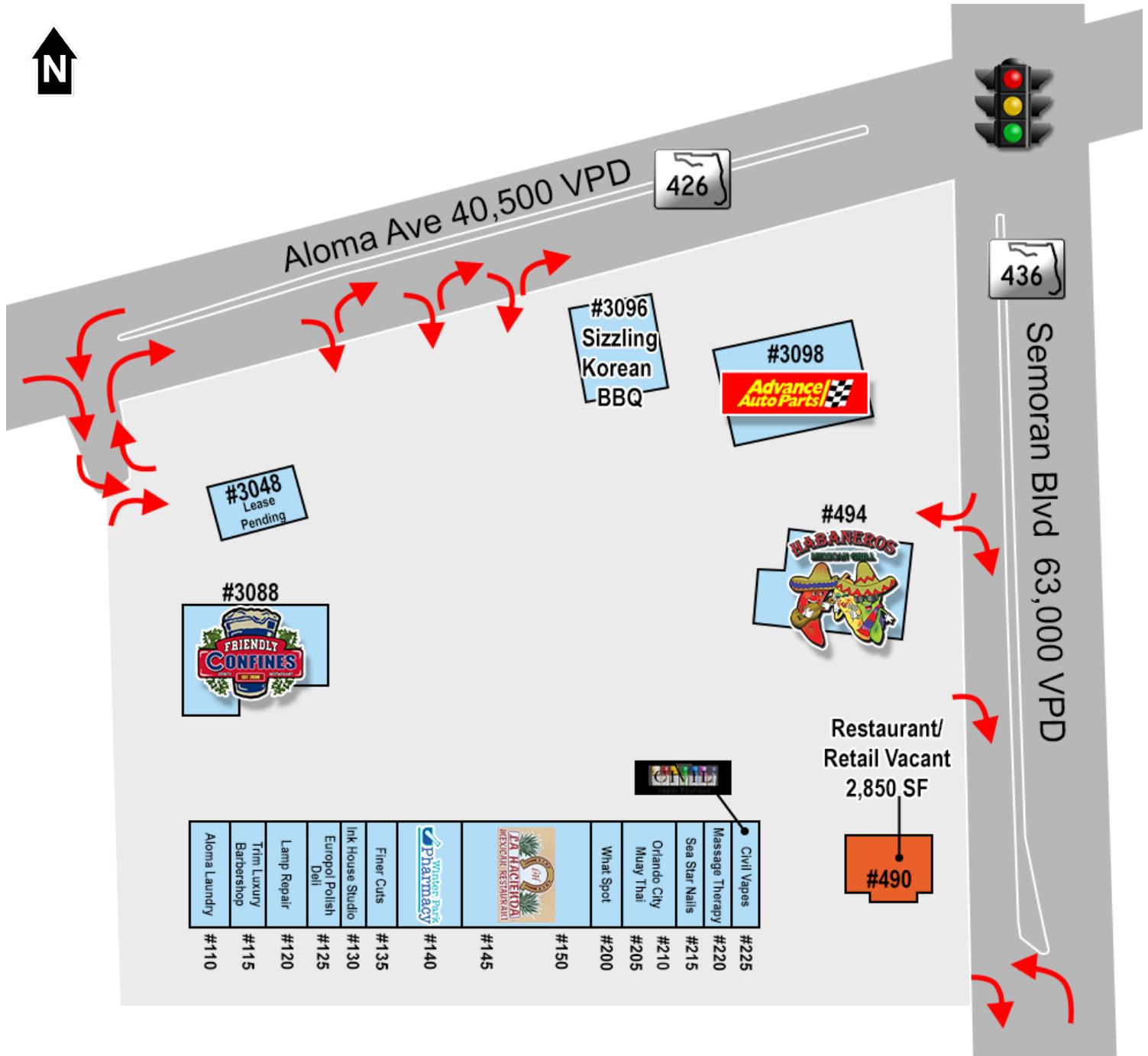

**LEGEND**

- Existing Tenant
- Vacant

# Space 490 Site Plan (2,850 SF)

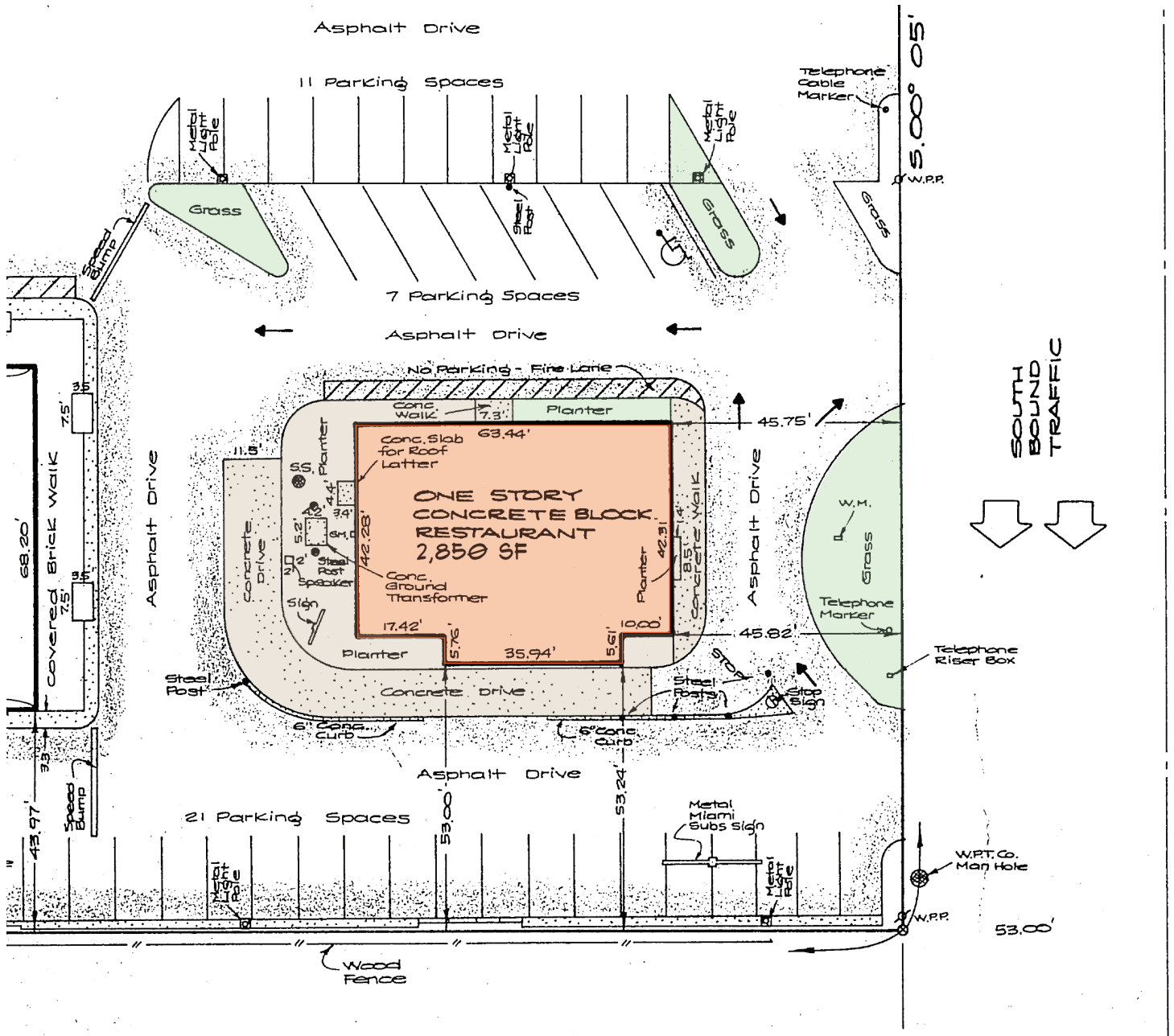

Contact us now for more information

**RUSTY STOECKEL**  
 BROKER/ASSOCIATE  
 407.440-5424  
 rusty@dresi.com

Demetree Global  
 941 W. Morse Blvd, Suite 315 | Winter Park, FL 32789  
 DemetreeGlobal.com

No warranty or representation, express or implied, is made as to the accuracy of the information contained herein, and same is submitted subject errors, omissions, change of price, rental or other conditions, withdrawal without notice, and to any special listing and conditions imposed by our principals.