

8,545 SF Office Space Available for Lease

Medical, Office, or Retail



EAST ELEVATION
SCALE: 3/32" = 1'-0"



WEST ELEVATION
SCALE: 3/32" = 1'-0"



NORTH ELEVATION
SCALE: 3/32" = 1'-0"



SOUTH ELEVATION
SCALE: 3/32" = 1'-0"

Property Details

- New construction
- 8,454 SF available for lease
- Subdividable to 3,000 SF
- 23,780 SF total building size
- Located on 6.8 acres
- Close proximity to both Old Saybrook and Westbrook Commuter Rails (Shore Line East)



For further information, please contact:

Maury Smith | D 860.327.8304 | C 860.748.2508 | maury.smith@avisonyoung.com

Avison Young | 225 Asylum Street, 16th Floor | Hartford, CT 06103 | T 860.327.8330

Location Details

- Commuter Rails (Shore Line East)
- Full interchange at Exit 66 off of I-95
- Convenient access from Route 1

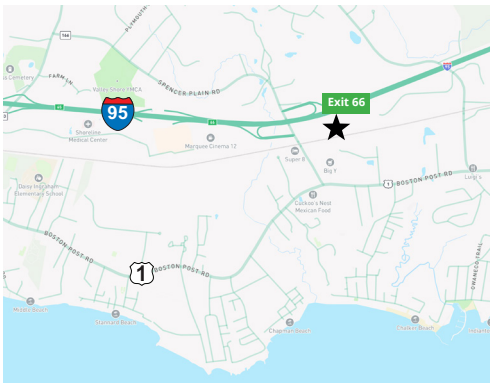

Floor Plan | 8,454 SF

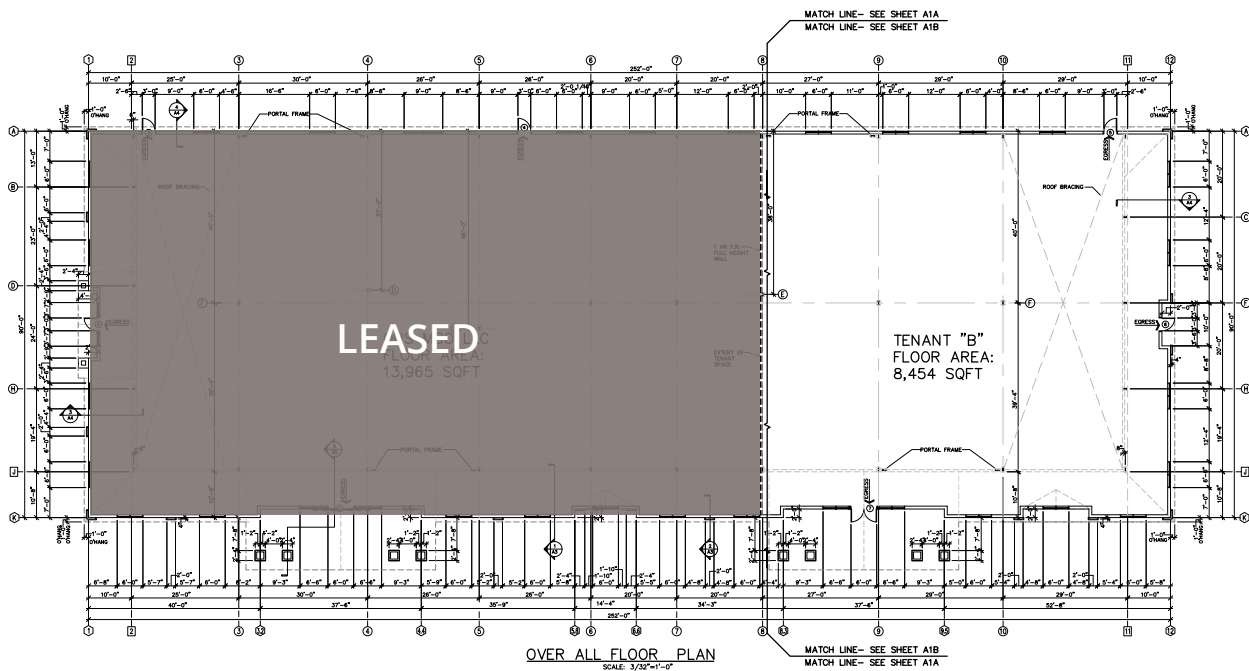

For further information, please contact:

Maury Smith | D 860.327.8304 | C 860.748.2508 | maury.smith@avisonyoung.com

Avison Young | 225 Asylum Street, 16th Floor | Hartford, CT 06103 | T 860.327.8330