

FOR LEASE

1.688 Acres Yard/Storage Area

Minnehaha Corporate Center

4201 NE Minnehaha St. • Vancouver, WA 98661

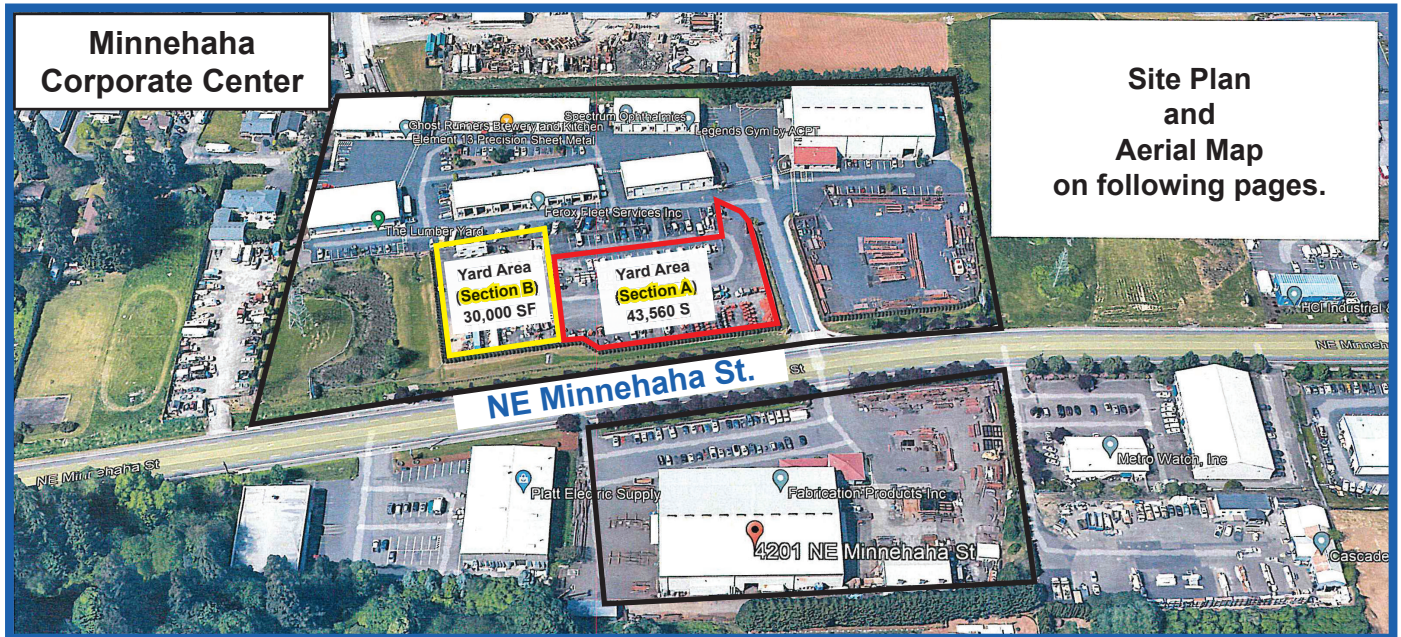

Features:

Section A:

- 43,560 SF (1 Acre) - **Available Now**
- Paved and Fenced with 1 - 20' Entry Gate

Section B:

- 30,000 SF - **Available Now**
- Paved and Fenced with 2 - 20' Entry Gates
- Power to the Site

2,650 SF Warehouse Space
also Available.

CLICK HERE to view the flyer.

Easy Access to I-5 and I-205
Located in Central Vancouver

Rate:

\$0.20/PSF per Month

Section A - \$8,712 per Month

Section B - \$6,000 per Month

For more information contact

Coleman Brown, CCIM

(360) 952-4758

Coleman@CCPprop.com



**Columbia
Commercial**
Commercial Leasing | Sales | Property Management

9120 NE Vancouver Mall Loop, Suite 266, Vancouver, WA 98662
www.CCPprop.com • (360) 735-8001

The information contained herein has been obtained from sources we deem reliable. We do not, however, guarantee its accuracy. All information should be verified prior to purchase or lease.

Site Map

Minnehaha Corporate Center - 4201 NE Minnehaha St., Vancouver, WA 98661

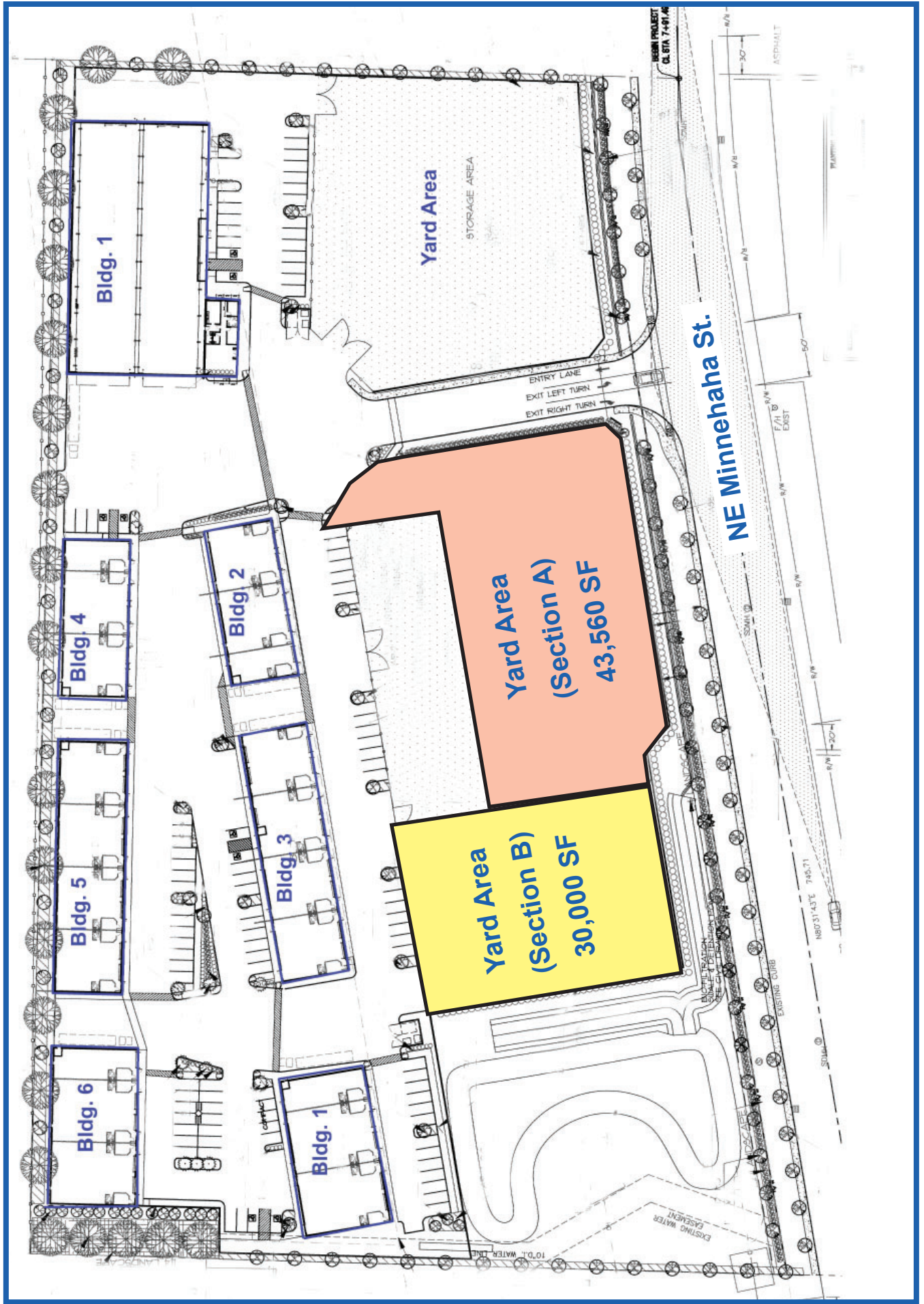

Aerial Map

Minnehaha Corporate Center - 4201 NE Minnehaha St., Vancouver, WA 98661

