

RSP Environmental, LLC

8475 Lanierland Farms Drive
 Gainesville, GA 30506
 470-590-1967
 ryan@rspenv.com

LEVEL 3 SOIL REPORT

Property Information	
Report Date: 4/24/2024	Job No.: SS-2412-2
Address: Burruss Mill Road	Client: West Allis Investment, LLC
Parcel ID: 268 008	Contact: 404-229-9802 (Reha Guven, Agent)
City, County: Cumming, Forsyth	Map Scale: 1:100

Map Unit Properties						
SOIL SERIES	SLOPE %	DEPTH TO REFUSAL/ BEDROCK (INCHES)	DEPTH TO SEASONAL HIGH OR PERCHED WATER TABLE (INCHES)	ESTIMATED ABSORPTION RATE AT RECOMMENDED TRENCH DEPTH (MIN/IN)	RECOMMENDED TRENCH DEPTH (INCHES)	SUITABILITY CODE
Appling	10-15	>72	>72	75	24-30	A
Cecil	15-25	>72	>72	60	36-42	A
Louisburg	25-35	>72	>72	50	30	R
Madison	6-10	>72	>72	50	30-42	A
Madison	15-25	>72	>72	50	30-42	A
Madison (Rocky)	25-35	55-63	>55	50	30	R

Map Unit Suitability Codes	
A	These soils are suitable for installation of on-site systems with proper system design, installation, and maintenance. Position of the site or other soil and landscape considerations may require the drainfield area to be greater than the minimum and/or the drainfield design to require equal distribution or level field installation.
R	These soils are suitable for installation of an on-site system. However, they are very rocky or stony which may require design modifications including increased drainfield area and special measures for excavations and system installation.

Notes	
<ul style="list-style-type: none"> Disturbance of soil by cutting or filling prior to drainfield installation may void the suitability of the soil. Soil boring locations, soil boundaries, and site features are shown on the attached Level 3 Soil Map. Property boundaries were obtained from a survey by McClure Surveying, Inc. Topographic contours and flood zone boundary were obtained from the Forsyth County Geographic Information System. Soil borings were located with a ublox ZED-F9P GNSS. 	



LEGEND

- B1 ● SOIL BORING
- AUGER REFUSAL
- ~ SOIL BOUNDARY
- - - LEVEL 3 SOIL SURVEY AREA
- - - PROPERTY BOUNDARY (GRAY IS PROPOSED PL)
- 1250- 2-FT CONTOUR
- ~ DITCH / DRAINAGE FEATURE
- SB SEPTIC SETBACK
- ISB IMPERVIOUS SURFACE SETBACK
- RCP REINFORCED CONCRETE PIPE

TOTAL LEVEL 3 SOIL SURVEY AREA = ~6.3 AC

NOTE: SOIL BORINGS, SOIL BOUNDARIES, AND SOIL SERIES IN GRAY ARE FROM LEVEL 2 SOIL SURVEY COMPLETED BY RSP, DATED 1/24/2024.

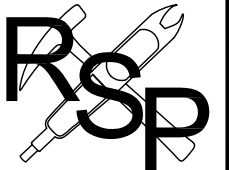
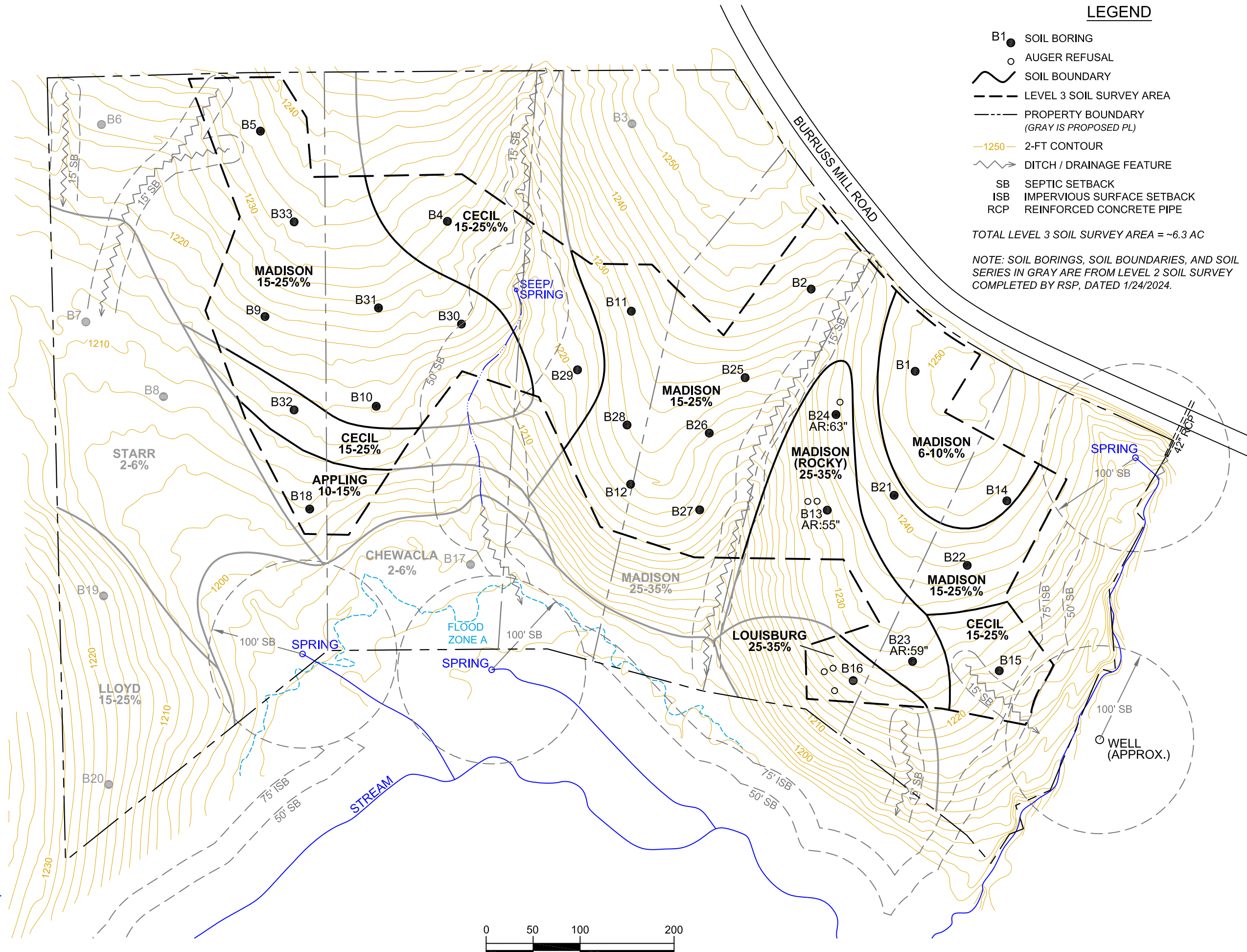

8475 LANIERLAND FARMS DR
GAINESVILLE, GA 30506
(470) 590-1967

LEVEL 3 SOIL MAP

BURRUSS MILL ROAD
PARCEL ID 268 008
CUMMING, FORSYTH COUNTY, GEORGIA 30041
REPORT DATE: 1/24/2024

PARCEL	268 008
LAND LOT	607,608,652,653
DISTRICT	14-1
CITY	CUMMING
COUNTY	FORSYTH
STATE	GEORGIA

JOB NO.	DATE
SS-2412-2	4/24/2024

LEVEL 3 SOIL SURVEY

DATE	#	REVISION

