

3320
CHURN CREEK
REDDING | CA

[CLICK TO TAKE A
VIRTUAL TOUR](#)

For Sale

±3,744 SF Building

Modern dental practice leased through 2034 with an additional five-year renewal option in Redding, CA.

- Triple-net (NNN) lease with zero maintenance responsibilities.
- Net operating income (NOI): \$93,000 annually; 7.6% cap rate.
- Located in a professional office park off Churn Creek Road, south of Del Sol Place.

RYAN HAEDRICH, CCIM

Vice President of Sales & Leasing
530.221.1127
ryan.h@capitalrivers.com
DRE #01747622

REALTY
RESOURCES
MEMBER



CAPITAL RIVERS
— HAEDRICH GROUP —



OVERVIEW



PROPERTY HIGHLIGHTS

Asking Price: \$1,220,000
Price Per Square Foot: \$325.85
Space Size: ±3,744 square feet
Address: 3320 Churn Creek Road | Redding, CA 96003

PROPERTY DESCRIPTION

This ±3,744 square foot dental building in Redding, CA presents a strong investment opportunity with a triple-net (NNN) lease in place through July 2034. Fully remodeled in 2015, the building was updated to meet the needs of a modern dental practice, ensuring functionality and durability. Situated within a professional office park just south of Del Sol Place, the property benefits from its strategic location on the west side of Churn Creek Road, an area known for professional and medical offices. The tenant pays market rent at \$7,750 per month, generating a net operating income (NOI) of \$93,000 annually with zero maintenance responsibilities for the owner.

The property's triple-net lease structure offers predictable and reliable cash flow, with the tenant covering taxes, insurance, and maintenance costs. Investors will benefit from the 7.6% cap rate, as well as the rising costs of dental office construction, which make this fully operational space an attractive asset in a supply-constrained market. The combination of a remodeled, professional-grade building and consistent rental income ensures this property remains a solid addition to any investment portfolio.



© Capital Rivers Commercial. This information has been obtained from sources believed reliable. We have not verified it and make no guarantee, warranty or representation about it. DRE #01522447

RYAN HAEDRICH, CCIM

Vice President of Sales & Leasing
530.221.1127
ryan.h@capitalrivers.com
DRE #01747622



CAPITAL RIVERS
— HAEDRICH GROUP —

OFFERING SUMMARY

3320
CHURN CREEK
REDDING | CA

Asking Price: \$1,220,000
Actual Cap Rate: 7.6%
Net Operating Income (NOI): \$93,000
Lease Type: Triple Net (NNN)
Lease Expiration: July 31, 2034
Option to Extend: One, 5 year option at fair market rate



© Capital Rivers Commercial. This information has been obtained from sources believed reliable. We have not verified it and make no guarantee, warranty or representation about it. DRE #01522447

RYAN HAEDRICH, CCIM

Vice President of Sales & Leasing
530.221.1127
ryan.h@capitalrivers.com
DRE #01747622

REALTY
RESOURCES
MEMBER



CAPITAL RIVERS
— HAEDRICH GROUP —

TENANT BACKGROUND



Dr. Farnaz Chegini brings over 13 years of experience in dentistry, recognized for her exceptional skill, compassion, and dedication to patient care. Specializing in general dentistry, her expertise includes esthetic, preventive, pediatric, prosthodontic, and endodontic treatments. Known for connecting with patients from diverse backgrounds, she inspires excellence among her dental staff.

Dr. Chegini holds advanced education in general dentistry from East Carolina University and a doctoral degree from Western University of Health Sciences. Her career includes work with esteemed organizations like the U.S. Department of Veterans Affairs, solidifying her reputation as a skilled and compassionate provider.

In 2024, Dr. Chegini took over Dr. Jason Cass's well-established family dental practice. Originally founded by Dr. Cass's father, the office boasts 4+ star ratings and a loyal patient base. Under Dr. Chegini's leadership, the practice continues its legacy while introducing fresh energy and a commitment to advancing care standards.

With strong community ties, a dedicated patient base, and an established location, Dr. Chegini's modern, patient-centered approach positions her practice as a stable and reliable tenant—a valuable asset for commercial real estate investments.

For more information, visit cheginifamilydentistry.com



© Capital Rivers Commercial. This information has been obtained from sources believed reliable. We have not verified it and make no guarantee, warranty or representation about it. DRE #01522447

RYAN HAEDRICH, CCIM

Vice President of Sales & Leasing
530.221.1127
ryan.h@capitalrivers.com
DRE #01747622



CAPITAL RIVERS
— HAEDRICH GROUP —

FLOOR PLAN

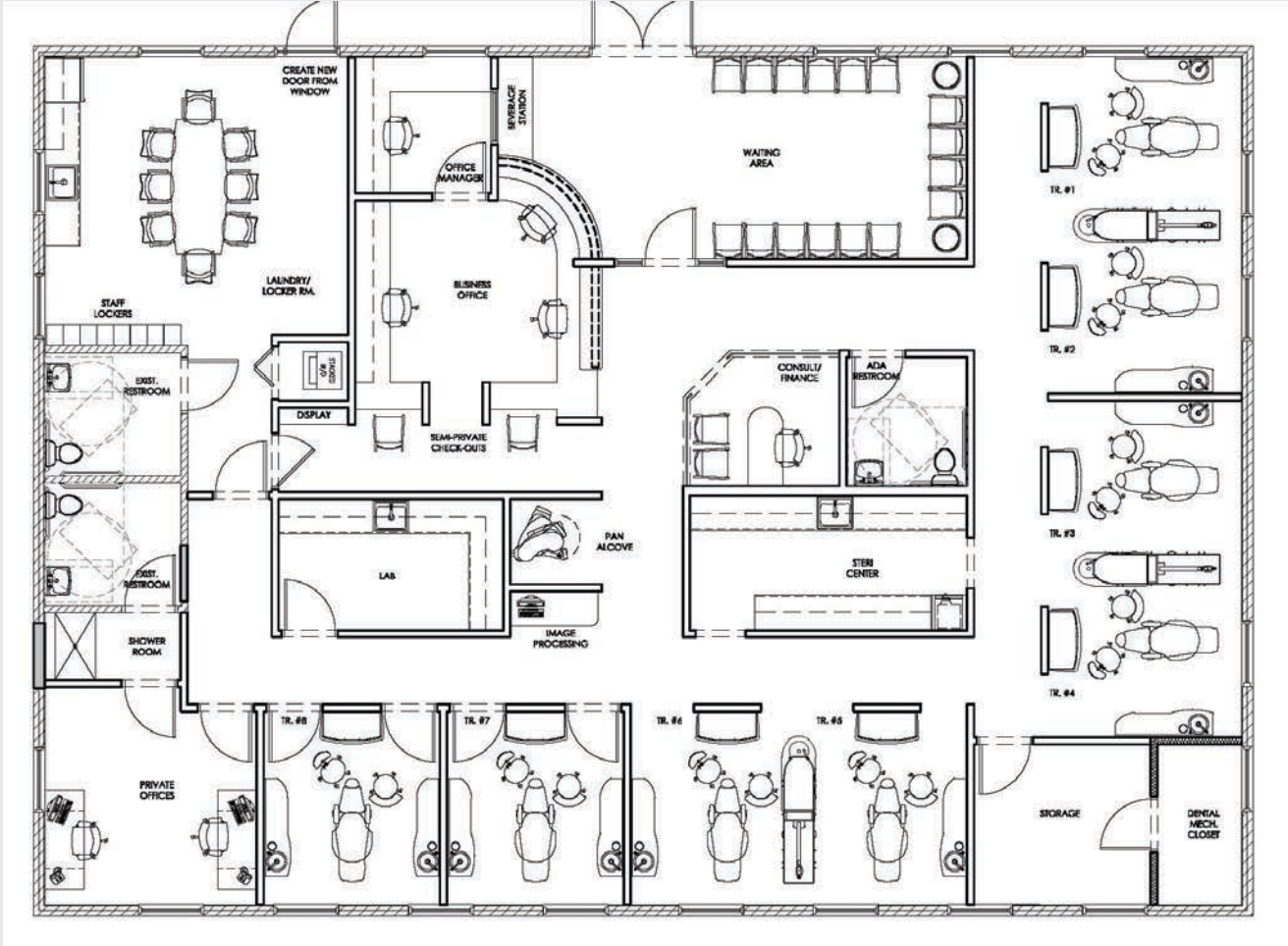

© Capital Rivers Commercial. This information has been obtained from sources believed reliable. We have not verified it and make no guarantee, warranty or representation about it. DRE #01522447

RYAN HAEDRICH, CCIM

Vice President of Sales & Leasing
530.221.1127
ryan.h@capitalrivers.com
DRE #01747622



CAPITAL RIVERS
— HAEDRICH GROUP —

INTERIOR PROPERTY PHOTOS

3320
CHURN CREEK
REDDING | CA



RYAN HAEDRICH, CCIM

Vice President of Sales & Leasing

530.221.1127

ryan.h@capitalrivers.com

DRE #01747622

REALTY
RESOURCES
MEMBER



CAPITAL RIVERS
— HAEDRICH GROUP —

REGIONAL DEMOGRAPHICS



| DEMOGRAPHICS | 1 MILE | 3 MILES | 5 MILES |
|---|----------|----------|-----------|
| POPULATION | | | |
| 2024 Estimated Population | 12,205 | 57,884 | 95,180 |
| 2029 Projected Population | 11,775 | 57,009 | 93,946 |
| 2020 Census Population | 12,536 | 59,012 | 96,774 |
| 2010 Census Population | 12,208 | 56,525 | 93,244 |
| 2024 Median Age | 34.4 | 37.0 | 38.8 |
| HOUSEHOLDS | | | |
| 2024 Estimated Households | 4,771 | 23,205 | 38,550 |
| 2029 Projected Households | 4,571 | 22,802 | 37,928 |
| 2020 Census Households | 4,768 | 23,257 | 38,798 |
| 2010 Census Households | 4,607 | 22,228 | 37,234 |
| INCOME | | | |
| 2024 Estimated Average Household Income | \$90,546 | \$97,959 | \$101,543 |
| 2024 Estimated Median Household Income | \$67,283 | \$73,700 | \$75,813 |
| 2024 Estimated Per Capita Income | \$35,703 | \$39,588 | \$41,403 |
| BUSINESS | | | |
| 2024 Estimated Total Businesses | 759 | 3,901 | 5,565 |
| 2024 Estimated Total Employees | 5,448 | 34,071 | 46,515 |

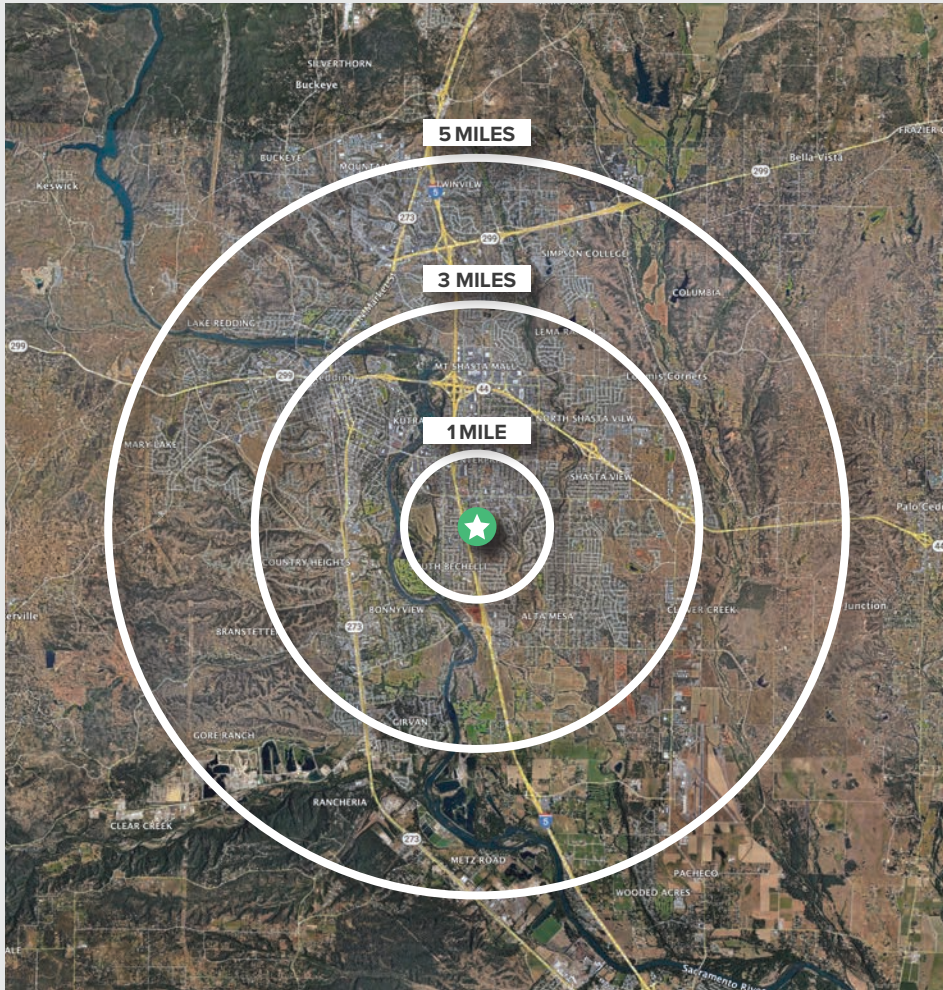

Source: Applied Geographic Solutions 05/2024, TIGER Geography - RS1

RYAN HAEDRICH, CCIM
 Vice President of Sales & Leasing
 530.221.1127
 ryan.h@capitalrivers.com
 DRE #01747622



CAPITAL RIVERS
 — HAEDRICH GROUP —

ABOUT CAPITAL RIVERS



CHOOSE EXCELLENCE OVER ORDINARY

Our team of brokerage, property management, and development professionals work together with you to deliver creative solutions that meet your goals and reduce risk.

Creating a great experience is what we are all about.

Here at Capital Rivers we are dedicated to our core values helping make our real estate transactions and your brokerage experience more successful. We'll approach your project with loyalty, forward thinking, hard work, and passion. These are the values that drive everything we, as commercial real estate professionals do.

When you contact Capital Rivers, expect a response.

As commercial brokers and agents we believe in building strong partnerships with each other and our clients through creativity, collaboration, and gratitude. Our combined experience lets us build long lasting relationships with our team as well as everyone who comes through our front door. Capital Rivers' commercial brokerage team caters to clients not only in Northern California, including Sacramento, Chico, and Redding, but also across the United States.

Learn more at capitalrivers.com



PROPERTY MANAGEMENT

We understand that every property is unique requiring a comprehensive strategy to optimize performance.

[Learn more about Property Management](#)



COMMERCIAL BROKERAGE

Our goal is to deliver a complete real estate solution designed specifically to meet your needs.

[Learn more about Commercial Brokerage](#)



DEVELOPMENT

With a wealth of unique ideas and industry experience, we're well equipped to bring your projects to life.

[Learn more about Development](#)

Sacramento, CA Office:

1821 Q Street
Sacramento, CA 95811
916.514.5225
info@capitalrivers.com

Redding, CA Office:

280 Hemsted Drive, Suite 104
Redding, CA 96002
530.221.1127
info@capitalrivers.com

© Capital Rivers Commercial. This information has been obtained from sources believed reliable. We have not verified it and make no guarantee, warranty or representation about it. DRE #01522447

RYAN HAEDRICH, CCIM

Vice President of Sales & Leasing
530.221.1127
ryan.h@capitalrivers.com
DRE #01747622



CAPITAL RIVERS
— HAEDRICH GROUP —