

Available SF 17,396 SF

Industrial For Lease

Building Size 24,188 SF



Address: 1249 E 58th Pl, Los Angeles, CA 90011

Cross Streets: S Hooper Ave/E 58th Pl

Great Building for Manufacturing or Distribution

Amenities Includes:

*3 Dock Loading Positions *Grade Level Loading via Ramp

*Sprinklers *Foil Insulation *Fenced Parking for 17 Cars

3,000 SF Bonus Storage Mezzanine

Minutes from DTLA with Great Proximity to 110 Fwy Ramps

Lease Rate/Mo:	\$17,918	Sprinklered:	Yes	Office SF / #:	2,980 SF / 7
Lease Rate/SF:	\$1.03	Clear Height:	14'-18'	Restrooms:	4
Lease Type:	Gross / Op. Ex: \$0.03	GL Doors/Dim:	1 / 8'x12'	Office HVAC:	Heat & AC
Available SF:	17,396 SF	DH Doors/Dim:	3 / (1) 28'x14'	Finished Ofc Mezz:	0 SF
Minimum SF:	17,396 SF	A: 200 V: 240 O: 3 W: 4		Include In Available:	
Prop Lot Size:	POL	Construction Type:	Masonry	Unfinished Mezz:	3,000 SF
Term:	3-5 Years	Const Status/Year Blt:	Existing / 1969	Include In Available:	
Sale Price:	NFS	Whse HVAC:	No	Possession:	Now
Sale Price/SF:	NFS	Parking Spaces: 17 / Ratio: 1.0:1		Vacant:	Yes
Taxes:		Rail Service:	No	To Show:	Call broker
Yard:	Fenced / Paved	Specific Use:	Manufacturing	Market/Submarket:	Outlying Los Angeles
Zoning:	M-1			APN#:	6008002009,6008002011,60
Listing Company:	Dorin Realty Company				
Agents:	Mark Whitman 213-627-0007				
Listing #:	38011655	Listing Date:	05/05/2023	FTCF:	CB250N000S000
Notes:	All details must be verified. Parking in lot on South side of East 58th Place. CAM Fees: \$0.025 PSF.				

Mark Whitman
 mwhitman@dorinrealty.com
 213-627-0007



1247-1249 E. 58th Place
Unincorporated Los Angeles, CA 90001

E. Slauson Avenue

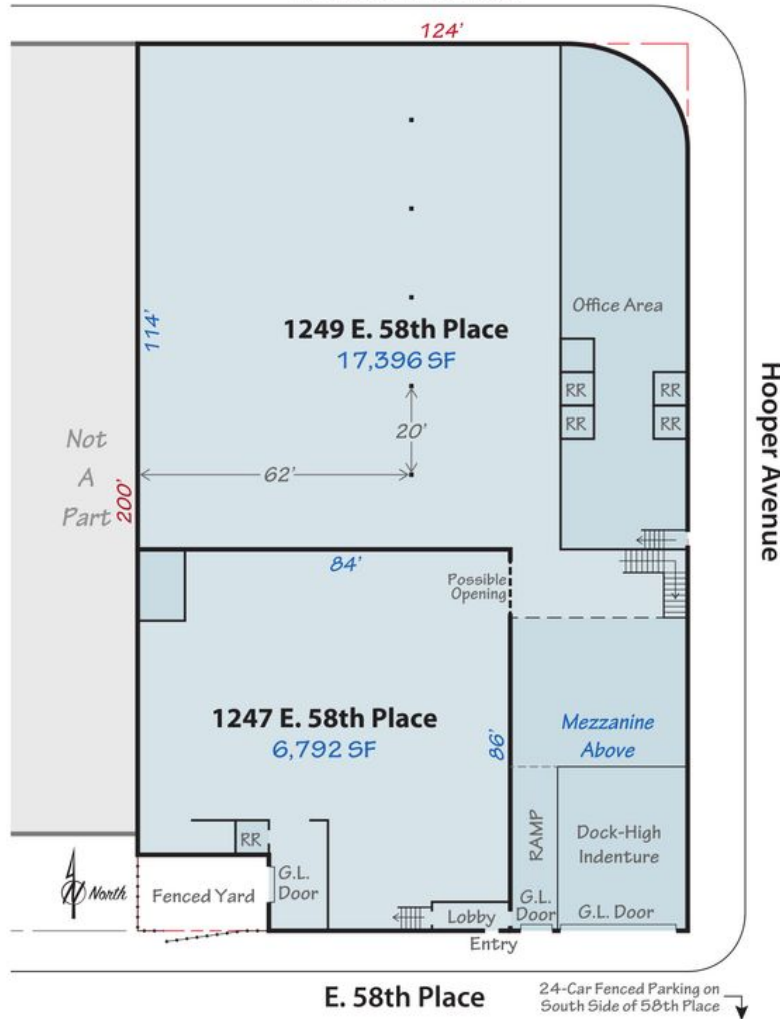



DORIN REALTY
COMPANY, INC.

Contact exclusive agent:
Mark Whitman
 mwhitman@dorinrealty.com
213-627-0007 Ext 124
 4555 Pacific Blvd., Vernon, CA 90058-2207

Industrial and Commercial Real Estate Specialists
Since 1959
www.dorinrealty.com

The information contained herein is from sources we believe to be reliable but, we do not guarantee its accuracy. All measurements & dimensions are approximations and are not to scale. Clients are encouraged to verify their accuracy.

Mark Whitman
 mwhitman@dorinrealty.com
 213-627-0007

