



OFFICE/WAREHOUSE FOR LEASE

For more information:

Fall River Investments, Inc.
7700 E. Iliff Avenue, Suite F
Denver, Colorado 80231
(303) 752-2051
Fax (303) 696-9506

ILIFF BUSINESS PARK
7700/7770 EAST ILIFF AVENUE

FEATURES

- Located in Southeast Denver
- Easy Access to I-25 and I-225
- Units Available from 2000 to 7000 Square Feet
- Skylights
- 14' Clear Ceiling Height
- 10 x 12 Drive-In Doors
- Arapahoe County Tax Base
- Zoning I-1

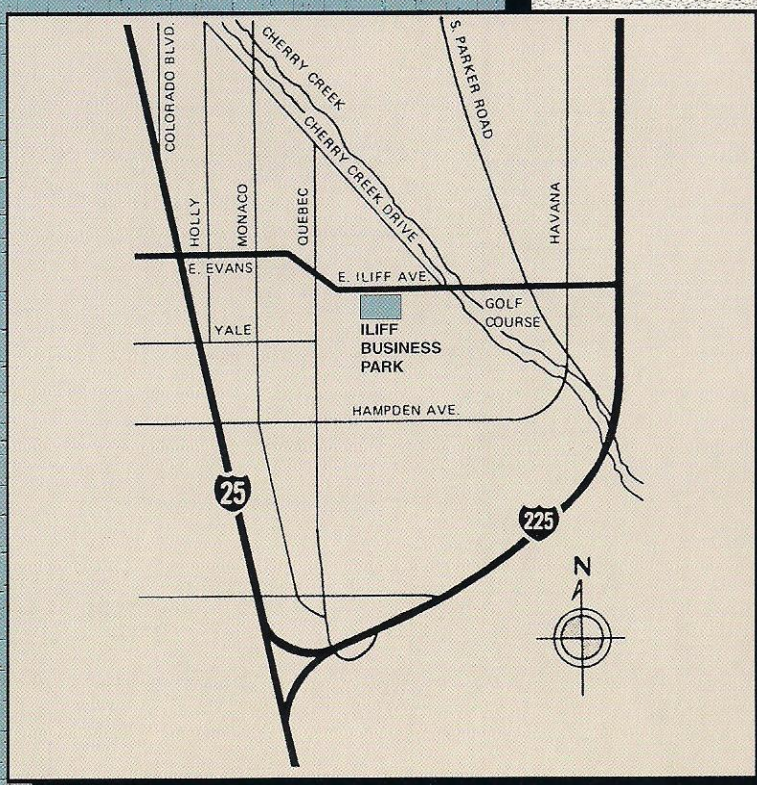

BUILDING FLOOR PLAN
ON REVERSE SIDE

EAST ILIFF AVENUE

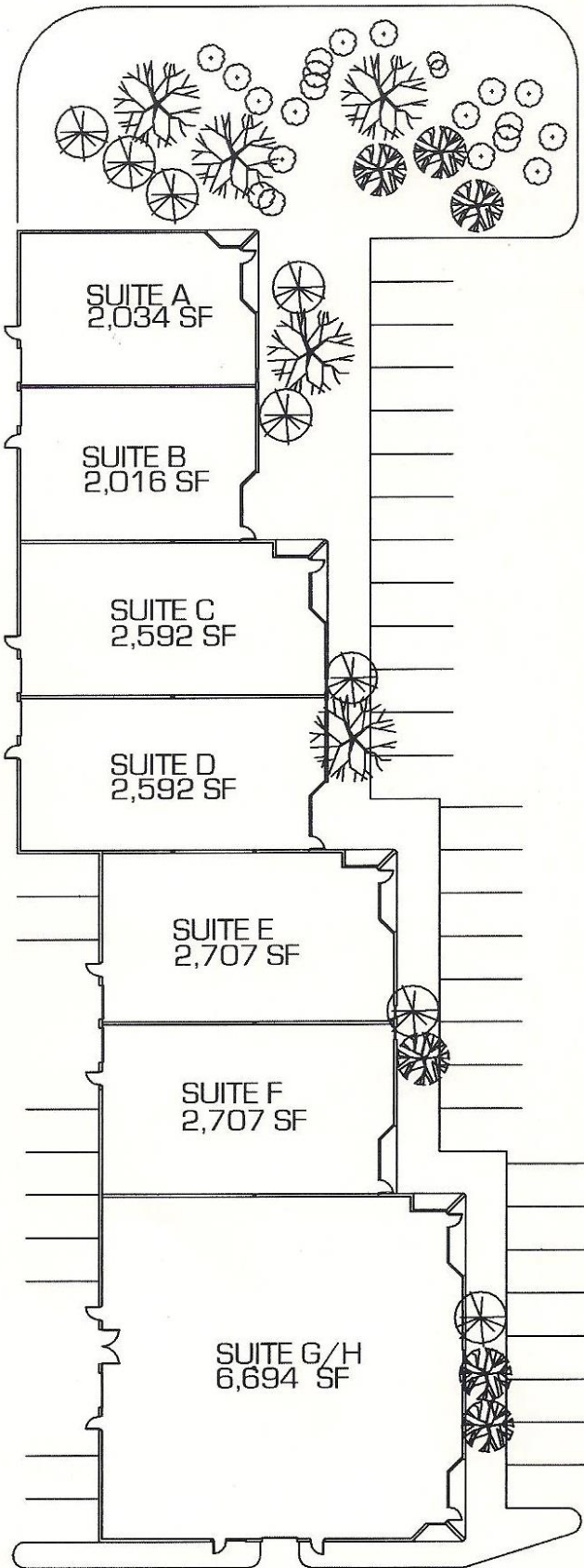

7700 EAST ILIFF AVENUE

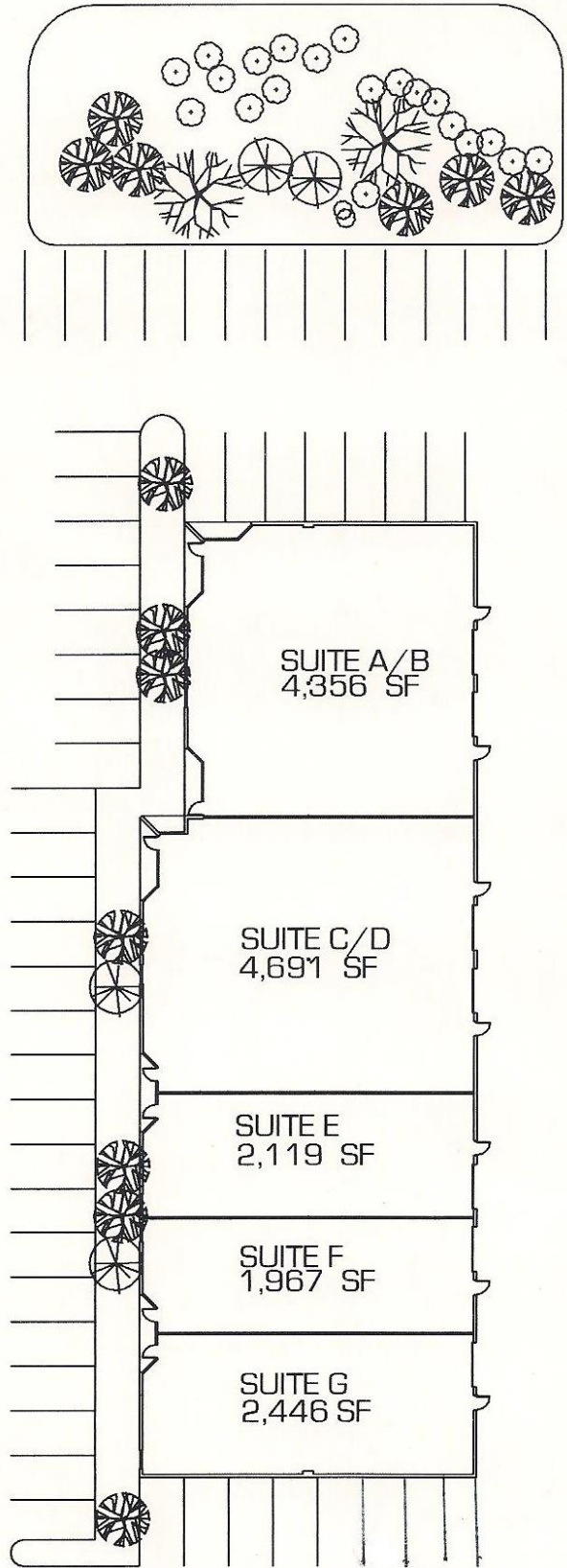

7770 EAST ILIFF AVENUE

