

# 2011 Cherry Street

Louisville, Colorado 80027

For Lease  
\$14.50/sq.ft.



**Eric Rutherford** MBA, CCIM, GREEN  
303.541.1908  
erutherford@wkre.com  
www.ericrutherford.com  
United States Naval Academy Graduate  
Served as an Officer in the United States Marine Corps

**Dan Tremblay**  
720.564.6067  
dtremblay@wkre.com  
www.dantremblay.wkre.com



# Details

## Free Standing Office Building, Suite B

<b>Lease Rate</b>	\$14.50 sq/ft + \$8.28 NNN
<b>Zoned</b>	Industrial/Flex/Warehouse/Office/Manufacturing
<b>Located</b>	Off US 287 in the CTC
<b>Available Space</b>	Approx. 21,950 sq/ft
<b>Suite 104</b>	Approx. 9,363 sq/ft
<b>Suite 106</b>	Approx. 12,587 sq/ft
<b>Year Built</b>	2001
<b>Dock Doors</b>	2 drive up, 4 dock high
<b>Ceiling Height</b>	18' - 20'
<b>Levels</b>	2 stories
<b>Water</b>	City of Louisville
<b>Electric</b>	Xcel Energy
<b>Power</b>	2000 Amp / 480 Volt / 3 Phase
<b>Water Line</b>	2 inch
<b>Uses</b>	Main level has warehouse/office space. Second floor features offices, conference rooms, outdoor space, amazing views of the front range and beyond.



# Floorplans

2011 Cherry Street  
Louisville, Colorado

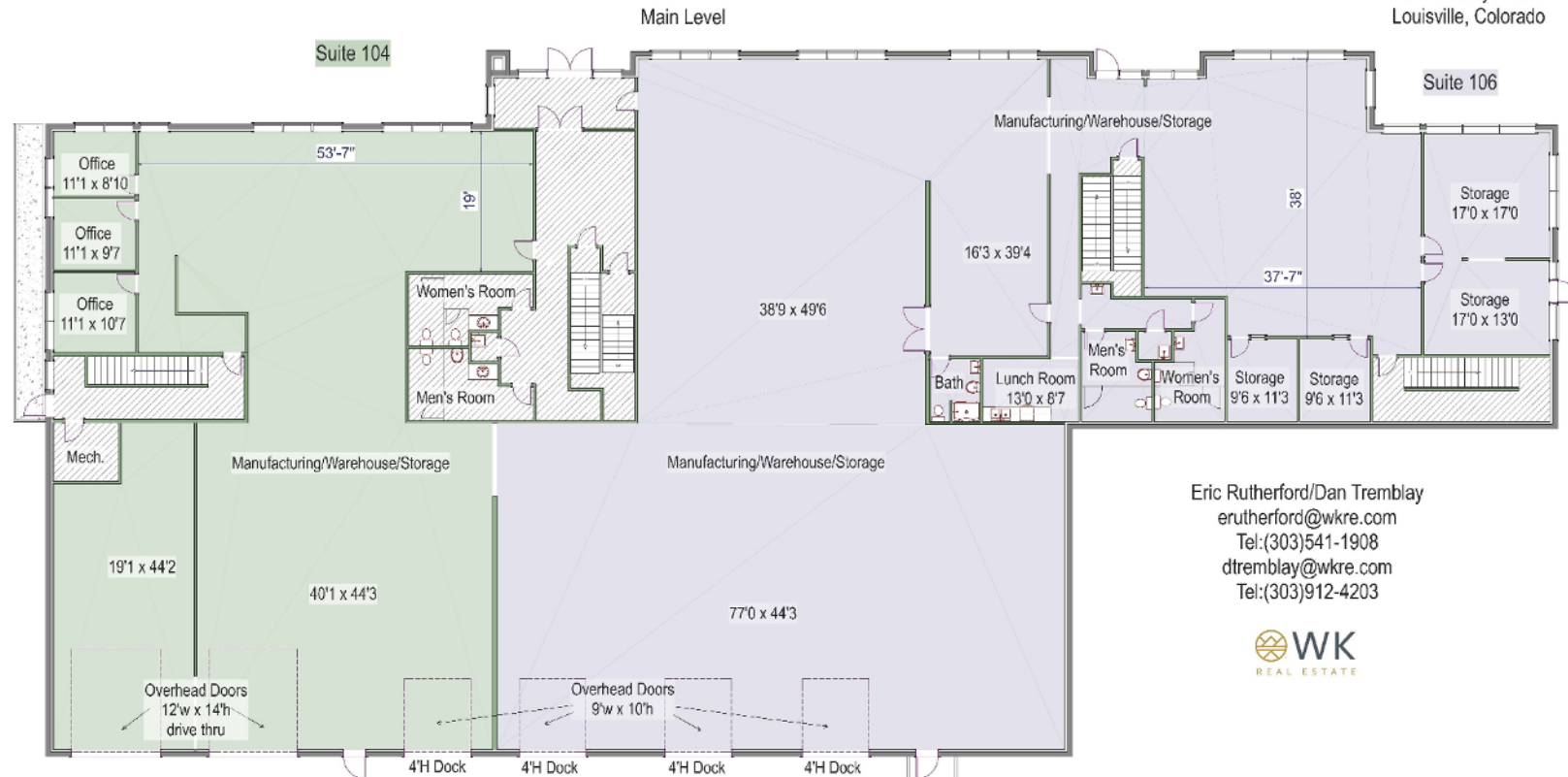

Eric Rutherford/Dan Tremblay  
erutherford@wkre.com  
Tel:(303)541-1908  
dtremblay@wkre.com  
Tel:(303)912-4203



These spaces are excluded from square footage calculations

Measurements are approximate and no responsibility is taken for any commission or mis-statement. Floor plan is for the exclusive use of Eric Rutherford/Dan Tremblay and may not be transferred or sold. Floor Plans prepared by Overhead Views, (303)886-9578, esw@overheadviews.com

