



# On Broadway

Jefferson Ave & Broadway | Redwood City, California

## NOW LEASING

<u>SPACE#</u>	<u>SF</u>	<u>RENT</u>	<u>NNN</u>
P2 <small>(office space) Avail. 12/31/24</small>	3,689	Call	\$10.27

For information, contact:

**Emily Murtha – Senior Leasing Manager**

Direct: 415-277-6905

[emurtha@crosspointrealty.com](mailto:emurtha@crosspointrealty.com)

CA DRE #01891284

**Carter Hemming**

[chemming@crosspointrealty.com](mailto:chemming@crosspointrealty.com)

CA DRE #01123464

**Andy Armstrong**

[aarmstrong@crosspointrealty.com](mailto:aarmstrong@crosspointrealty.com)

CA DRE #01860367

Phone: 415-288-6888

Fax: 415-288-6877

Crosspoint Realty Services, Inc.

20211 Patio Drive, Suite 145

Castro Valley, CA 94546

[www.crosspointrealty.com](http://www.crosspointrealty.com)



## OFFICE SPACE PLAN

Contact: Emily Murtha CA DRE #01891284 [emurtha@crosspointrealty.com](mailto:emurtha@crosspointrealty.com); Carter Hemming (CA DRE#01123464), [chemming@crosspointrealty.com](mailto:chemming@crosspointrealty.com); Phone 415.288.6888

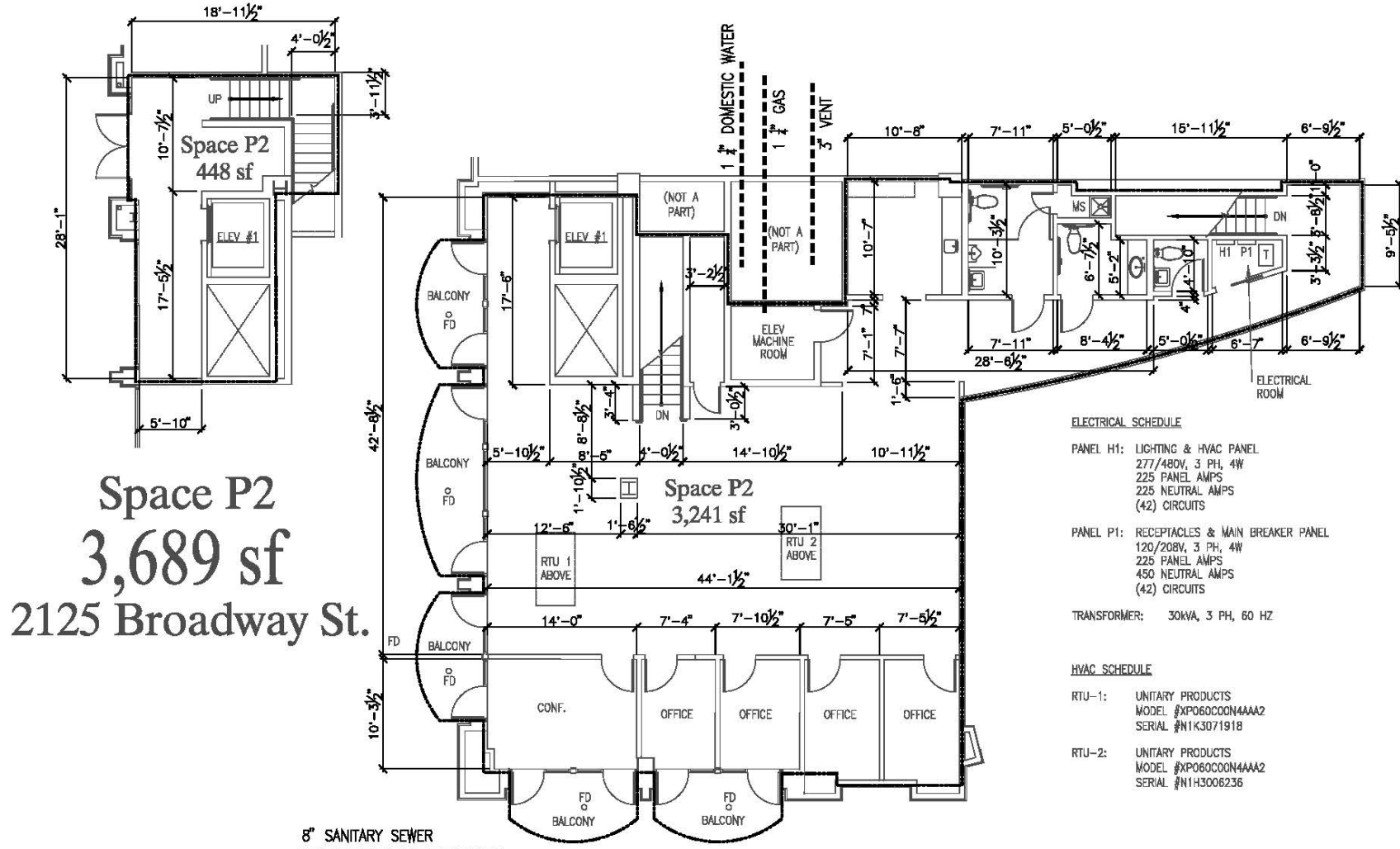

**SPACE P2 - LEASE PLAN**

## SITE PLAN

Contact: Emily Murtha CA DRE #01891284 [emurtha@crosspointrealty.com](mailto:emurtha@crosspointrealty.com); Carter Hemming (CA DRE#01123464), [chemming@crosspointrealty.com](mailto:chemming@crosspointrealty.com); Phone 415.288.6888

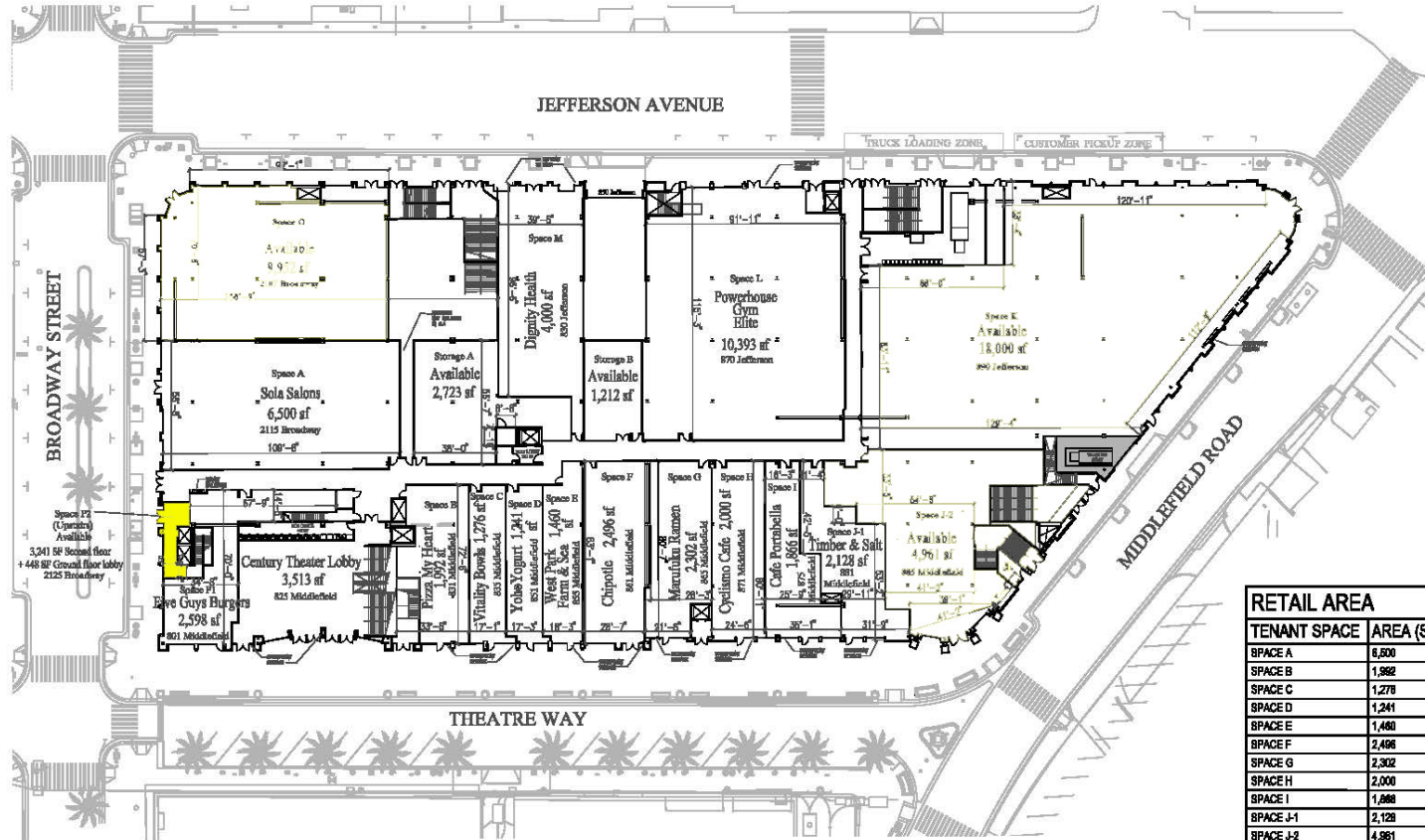

### ON BROADWAY FIRST FLOOR LEASE PLAN

REDWOOD CITY, CA NOVEMBER 10, 2020

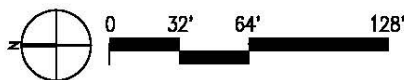

**DISCLAIMER:**  
THIS SITE PLAN IS INTENDED ONLY TO SHOW THE GENERAL LAYOUT OF THE PROPERTY OR A PART THEREOF. LANDLORD RESERVES THE RIGHT TO ALTER, VARY, ADD OR OMIT IN WHOLE OR IN PART ANY STRUCTURES, AND/OR IMPROVEMENTS, TENANT NAMES, STORE SIZES AND/OR LAND AREA SHOWN ON THIS PLAN. ALL MEASUREMENTS AND DISTANCES ARE APPROXIMATE. THIS PLAN IS NOT TO BE SCALED.

Deutsche Asset & Wealth Management

FOR LEASING INFORMATION:  
Tom Klein & Courtney Jones  
Crosspoint Realty Services, Inc.  
250 California Street  
San Francisco, CA 94111  
[www.crosspointrealty.com](http://www.crosspointrealty.com)  
P: 415.288.6888 F: 415.288.6877

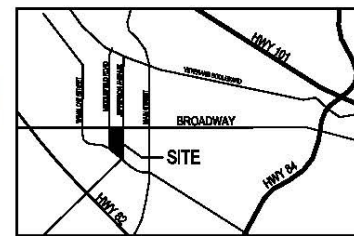

LOCATION MAP

#### RETAIL AREA

TENANT SPACE	AREA (SF)
SPACE A	6,500
SPACE B	1,962
SPACE C	1,278
SPACE D	1,241
SPACE E	1,480
SPACE F	2,498
SPACE G	2,302
SPACE H	2,000
SPACE I	1,888
SPACE J-1	2,128
SPACE J-2	4,981
SPACE K	18,000
SPACE L	10,383
SPACE M	4,000
SPACE O	9,952
SPACE P1	2,598
SPACE P2 (UPSTAIRS)	3,888
<b>SUBTOTAL</b>	<b>76,854</b>
<b>CENTURY THEATRE</b>	
TENANT SPACE	AREA (SF)
THEATRES & CONCESS.	87,476
BOX OFFICE	442
<b>SUBTOTAL</b>	<b>67,918</b>
<b>TOTAL GLA</b>	<b>144,772</b>

# On Broadway

Jefferson Ave & Broadway | Redwood City, California

## MARKET AREA

### On Broadway Tenants Include:

- |   |                                 |
|---|---------------------------------|
| Century Theaters 20                     | Five Guys Burgers               |
| Powerhouse Gym                          | Sola Salons                     |
| Vitality Bowls                          | Timber & Salt                   |
| Happy Lemon                             | Go Health Urgent Care           |
| Chipotle                                | Marufuku Ramen                  |
| Hella Mediterranean                     | Limón Rotisserie – Coming Soon! |
| Pizza My Heart                          |                                 |
| Ocean Oyster Bar & Grill – Coming Soon! |                                 |

For information, contact:

**Emily Murtha – Senior Leasing Manager**

Direct: 415-277-6905

[emurtha@crosspointrealty.com](mailto:emurtha@crosspointrealty.com)

CA DRE #01891284

**Carter Hemming**

[chemming@crosspointrealty.com](mailto:chemming@crosspointrealty.com)

CA DRE #01123464

**Andy Armstrong**

[aarmstrong@crosspointrealty.com](mailto:aarmstrong@crosspointrealty.com)

CA DRE #01860367

Phone: 415-288-6888

Fax: 415-288-6877

Crosspoint Realty Services, Inc.

20211 Patio Drive, Suite 145

Castro Valley, CA 94546

[www.crosspointrealty.com](http://www.crosspointrealty.com)

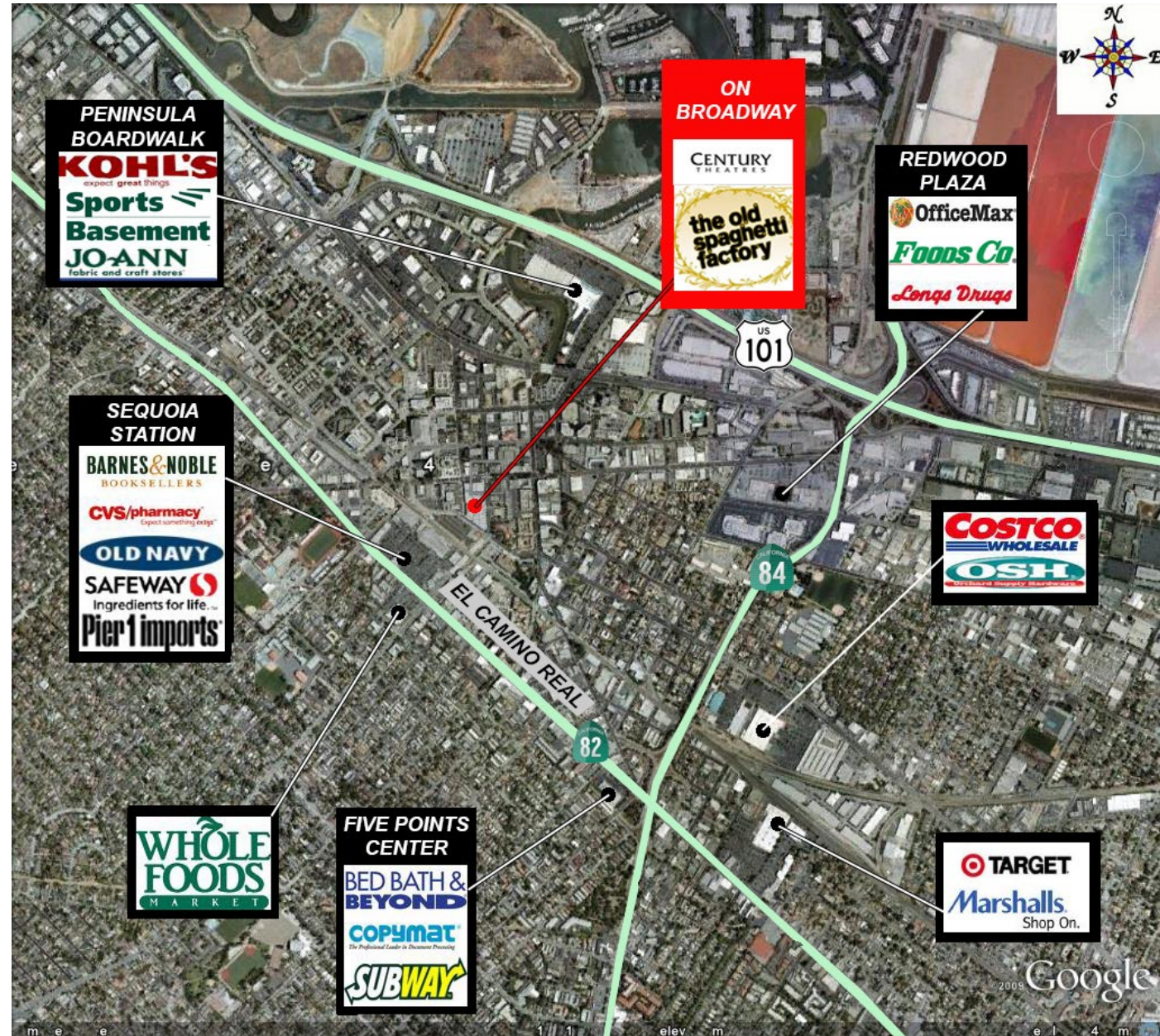

# On Broadway

Jefferson Ave & Broadway | Redwood City, California

## MAP & INFORMATION

Contact: Emily Murtha CA DRE #01891284 [emurtha@crosspointrealty.com](mailto:emurtha@crosspointrealty.com); Carter Hemming, CA DRE #01123464 [chemming@crosspointrealty.com](mailto:chemming@crosspointrealty.com); Andy Armstrong CA DRE# 01860367, [aarmstrong@crosspointrealty.com](mailto:aarmstrong@crosspointrealty.com); Phone 415.288.6888

### Description:

On Broadway is a 145,000 square foot entertainment retail center built in 2006 and anchored by a state of the art, 20 screen Century Theater complex. Jefferson Avenue is the main artery into downtown Redwood City from El Camino Real and Cost Plus anchors the Jefferson Avenue / Middlefield Road corner. Theater Way borders the north side of the project and includes various restaurants. The project also includes 585 easily accessible subterranean parking spaces.

### Location:

Jefferson Avenue & Broadway Street, Redwood City, CA

