

DOMINGUEZ HILLS
INDUSTRIAL PARK

BRAND NEW, HIGH IMAGE OFFICES

350 W APRA STREET

Compton, CA

FOR LEASE

99,803 SF AVAILABLE

NEWMARK



PGIM

APRA STREET

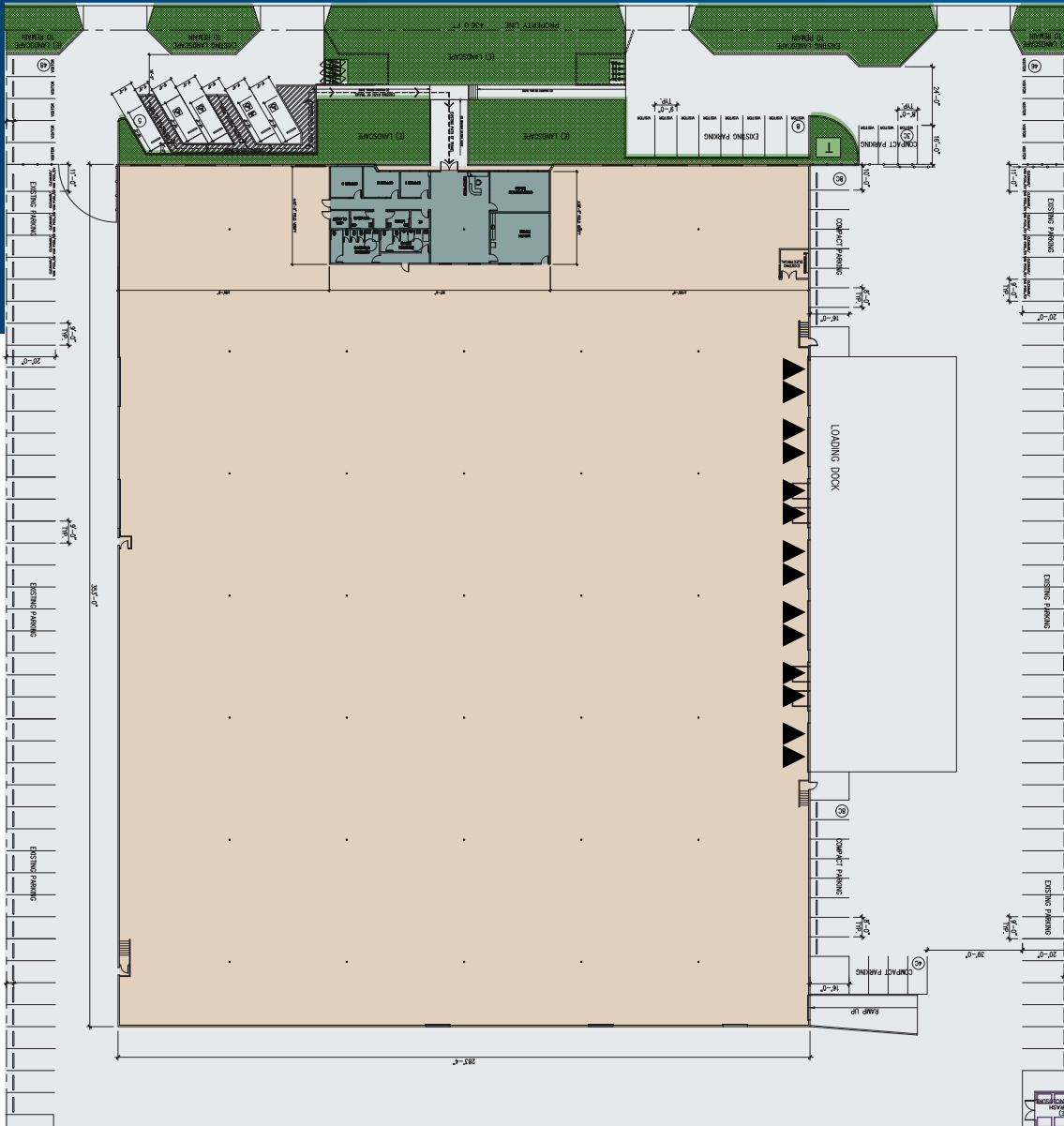

BUILDING HIGHLIGHTS

99,803
SQUARE FEET

.60/4000
SPRINKLER SYSTEM

14
DOCK HIGH POSITIONS

3,478 SF
BRAND NEW OFFICE

3
GROUND LEVEL DOORS

2
FENCED YARDS WITH
DRIVE AROUND ACCESS

24'
CLEAR HEIGHT

800
AMPS OF POWER

▲ Dock High Positions

NOT TO SCALE



LOCATOR MAP



For more information, please contact:

DANNY WILLIAMS, SIOR

Executive Managing Director

t 310-491-2061

danny.williams@nmrk.com

CA RE Lic. #01776416

JOHN MCMILLAN, SIOR

Vice Chairman

t 310-491-2048

john.mcmillan@nmrk.com

CA RE Lic. #01103292

BARRY HILL, SIOR

Executive Managing Director

t 310-491-2026

barry.hill@nmrk.com

CA RE Lic. #01250531

350 **W APRA STREET**

Compton, CA

The distributor of this communication is performing acts for which a real estate license is required. The information contained herein has been obtained from sources deemed reliable but has not been verified and no guarantee, warranty or representation, either express or implied, is made with respect to such information. Terms of sale or lease and availability are subject to change or withdrawal without notice.

NEWMARK



Corporate License #01355491

nmrk.com