

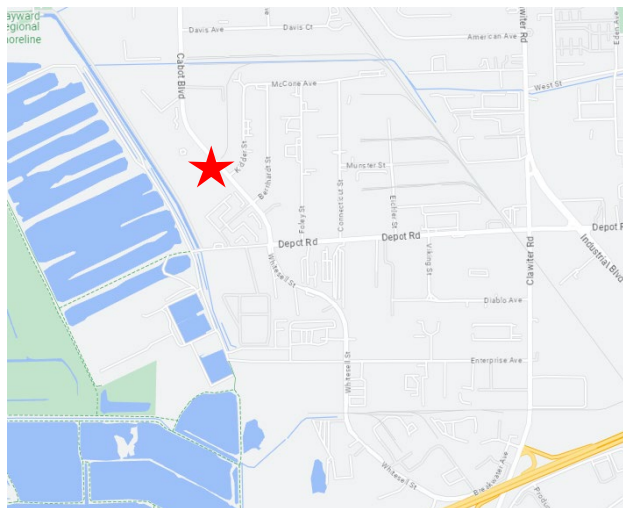

WAREHOUSE FOR LEASE

**23425 CABOT BLVD
HAYWARD, CA**



Property:

±26,891 Square Feet

Property Highlights:

- ±3,000 square feet of office space
- Four (4) Dock Doors
- Two (2) Grade-Level Doors
- ±24' Minimum Clear Height
- Fully Sprinklered
- Skylights throughout

Location Highlights:

- 2Milesto HWY92(to WestBay)
- 3Milesto I-880(North and South)
- Front corner unit

Leasing Highlights:

- Available Q1 2025
- \$1.25/SF NNN (\$0.30/SF opex)

For information, please contact:

Paul Mueller, SIOR

Senior Managing Director

t 510-220-3341

paul.mueller@nmrk.com

CA RE License #00896726

Dan Dowd, SIOR

Senior Managing Director

t 925-808-8199

dan.dowd@nmrk.com

CA RE License #01432679

Spencer Jenkins

Associate Director

t 720-272-5175

spencer.jenkins@nmrk.com

CA RE License #02029699

nmrk.com

NEWMARK

The distributor of this communication is performing acts for which a real estate license is required. The information contained herein has been obtained from sources deemed reliable but has not been verified and no guarantee, warranty or representation, either express or implied, is made with respect to such information. Terms of sale or lease and availability are subject to change or withdrawal without notice. MP-790 • 04/2024

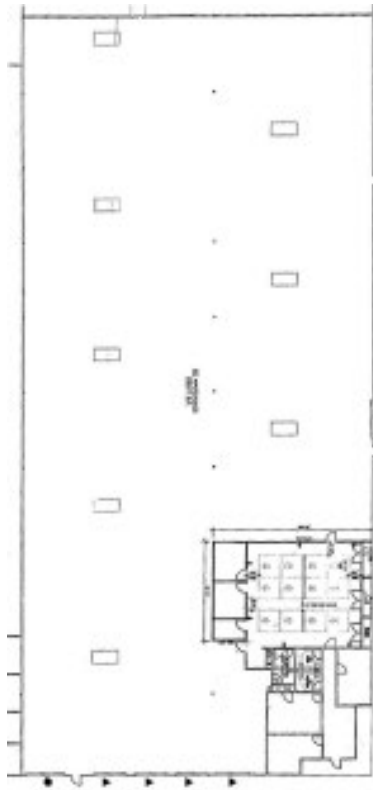
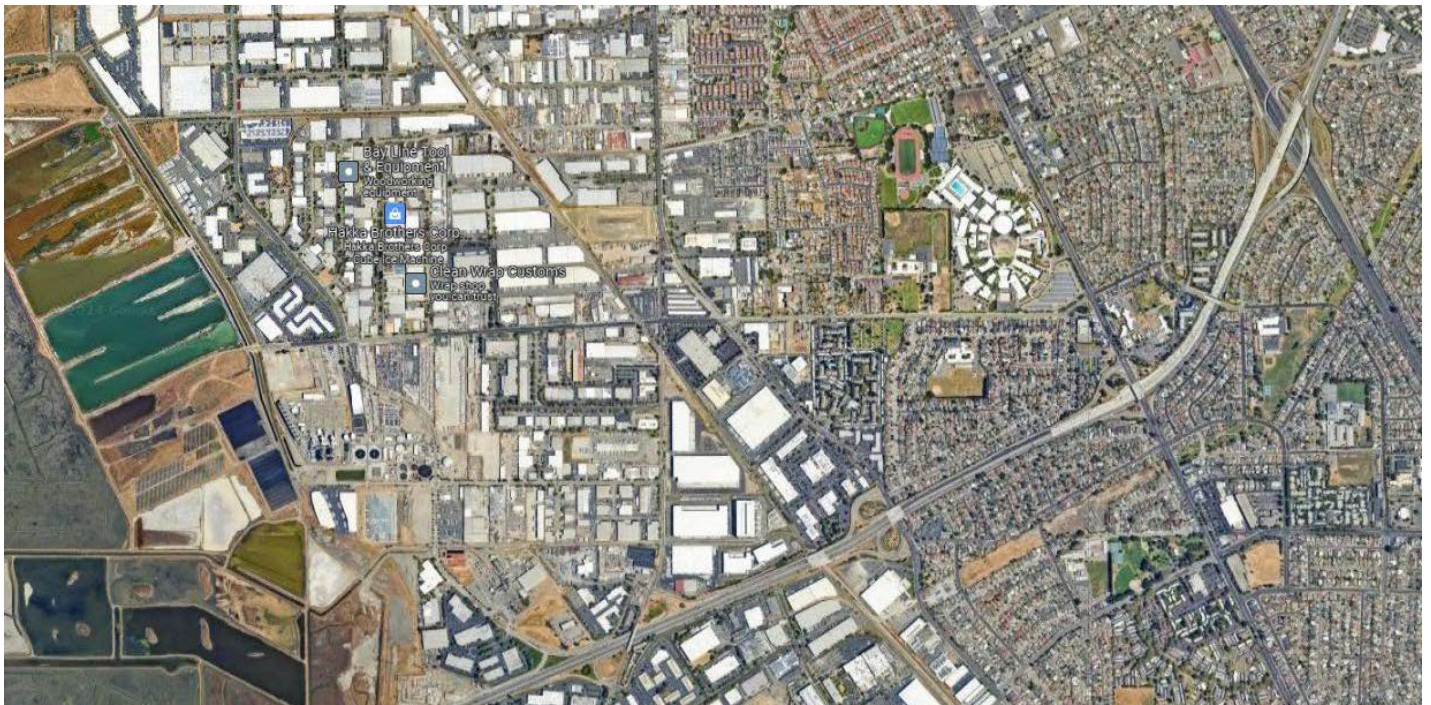

For information, please contact:

Paul Mueller, SIOR
 Senior Managing Director
 t 510-220-3341
paul.mueller@nmrk.com
 CA RE License #00896726

Dan Dowd, SIOR
 Senior Managing Director
 t 925-808-8199
dan.dowd@nmrk.com
 CA RE License #01432679

Spencer Jenkins
 Associate Director
 t 720-272-5175
spencer.jenkins@nmrk.com
 CA RE License #02029699

nmrk.com

NEWMARK

WAREHOUSE FOR LEASE

2485 DART RD
 Hayward, CA

Area

Photo: MarkEiche