

33300 DOWE AVENUE

FOR LEASE | ±191,868 SF | UNION CITY, CA



JEFF STARKOVICH, SIOR

Executive Managing Director

+1 510 409 1111

jeff.starkovich@cushwake.com

LIC #00644571

JAY HAGGLUND, SIOR

Executive Managing Director

+1 510 267 6011

jay.hagglund@cushwake.com

LIC #00888011



FOR LEASE:

33300 DOWE AVE | UNION CITY

| PROPERTY HIGHLIGHTS



±191,868

Square Footage



±3,655

Office Space



21

Dock High Doors- *7 Pit Style Mechanical Levelers*

- 3 Grade Level Doors
- Clear Height: ±21'-23'
- Sprinkler System: 0.495/2,000 SF
- Skylights Throughout
- Secure Fully Fenced Yard and Loading Area
- On Site Parking

AVAILABLE: MARCH 1, 2025

ASKING RATE: \$1.20 NNN (OPEX ±0.22 PSF)

FOR LEASE:
33300 DOWE AVE | UNION CITY

| FLOOR PLAN

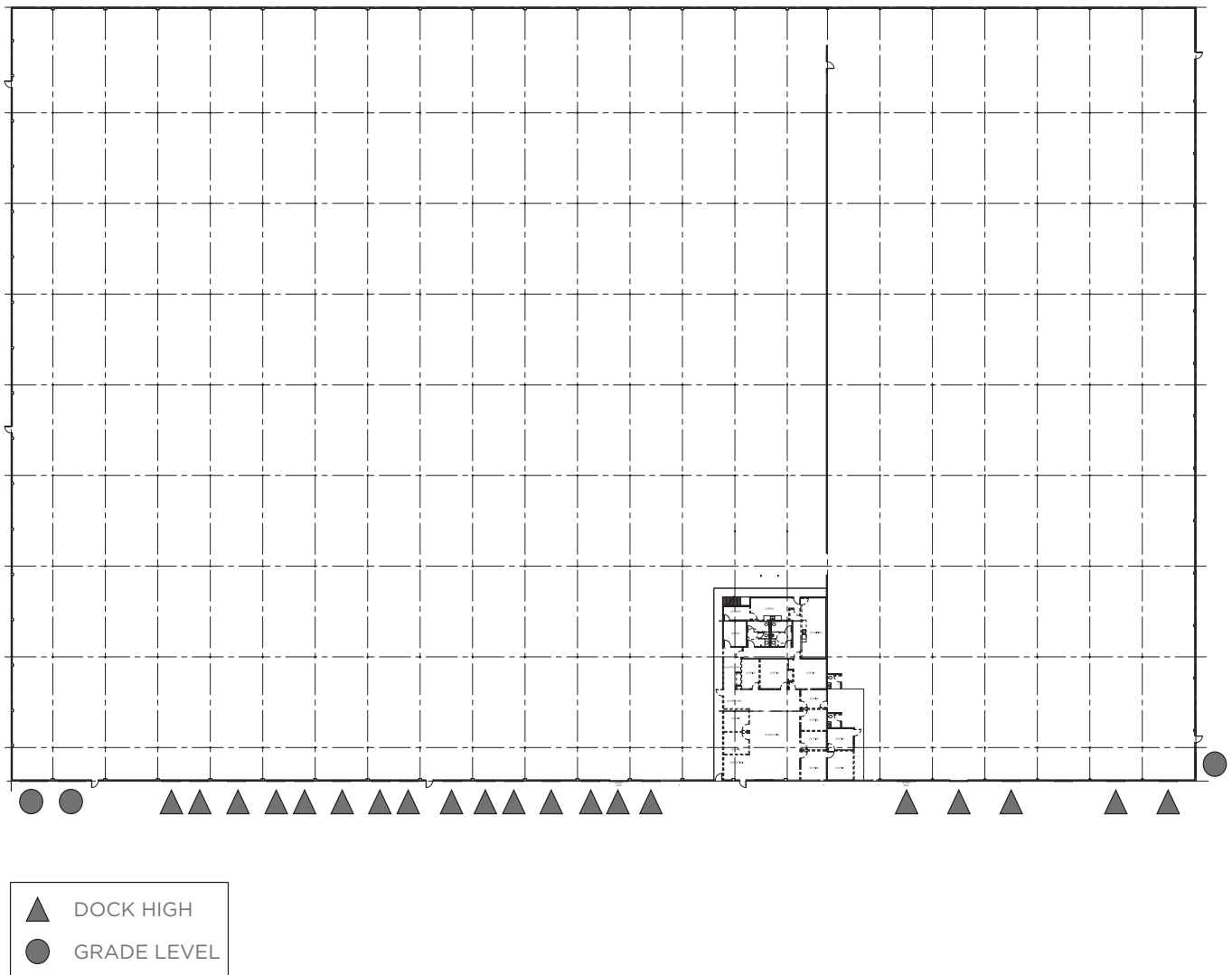

FOR LEASE:
33300 DOWE AVE | UNION CITY

| CORPORATE NEIGHBORS



**FOR LEASE:
33300 DOWE AVE | UNION CITY**

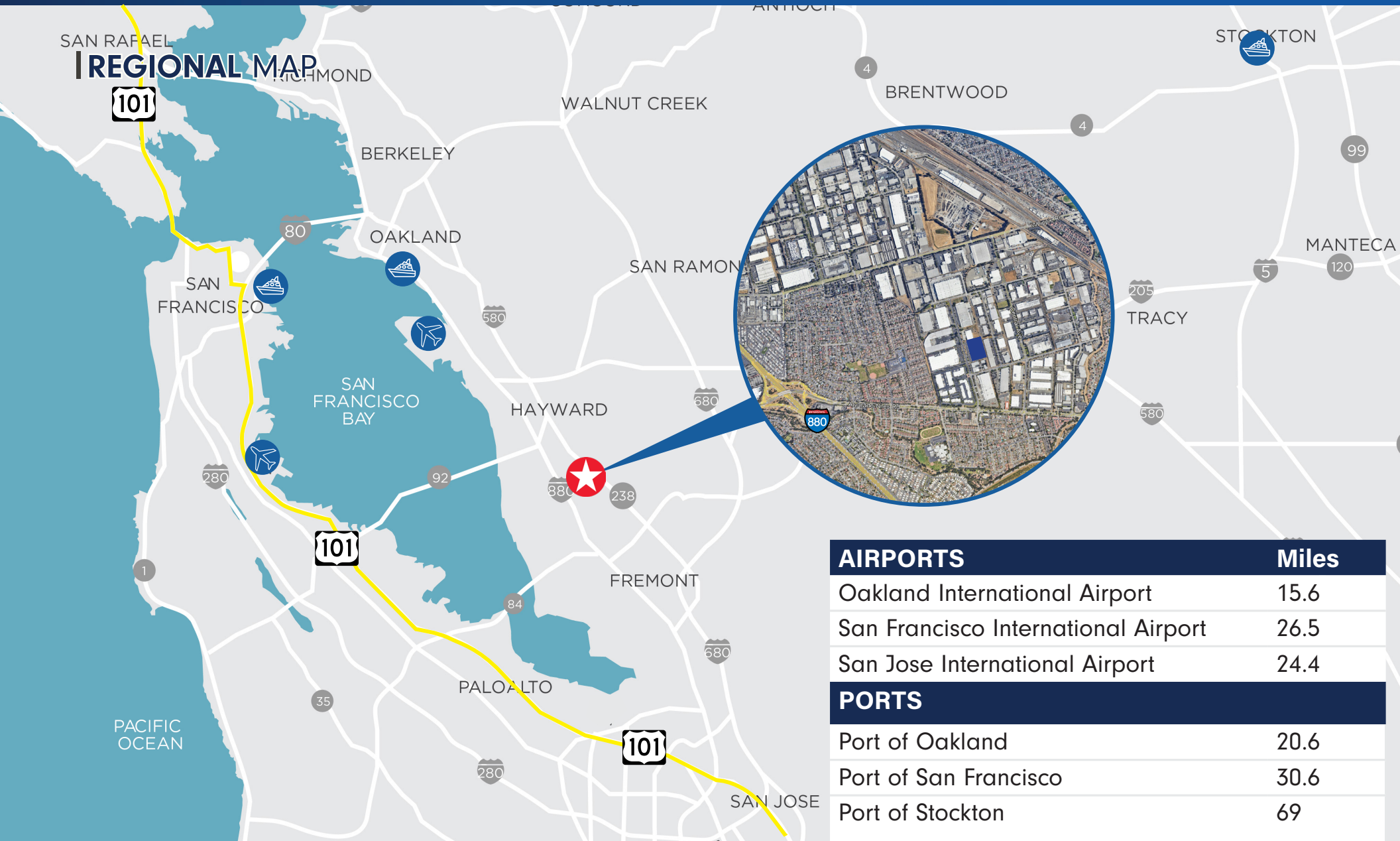

33300 DOWE AVENUE



JEFF STARKOVICH, SIOR
Executive Managing Director
+1 510 409 1111
jeff.starkovich@cushwake.com
LIC #00644571

JAY HAGGLUND, SIOR
Executive Managing Director
+1 510 267 6011
jay.hagglund@cushwake.com
LIC #00888011

©2024 Cushman & Wakefield. All rights reserved. The information contained in this communication is strictly confidential. This information has been obtained from sources believed to be reliable but has not been verified. NO WARRANTY OR REPRESENTATION, EXPRESS OR IMPLIED, IS MADE AS TO THE CONDITION OF THE PROPERTY (OR PROPERTIES) REFERENCED HEREIN OR AS TO THE ACCURACY OR COMPLETENESS OF THE INFORMATION CONTAINED HEREIN, AND SAME IS SUBMITTED SUBJECT TO ERRORS, OMISSIONS, CHANGE OF PRICE, RENTAL OR OTHER CONDITIONS, WITHDRAWAL WITHOUT NOTICE, AND TO ANY SPECIAL LISTING CONDITIONS IMPOSED BY THE PROPERTY OWNER(S). ANY PROJECTIONS, OPINIONS OR ESTIMATES ARE SUBJECT TO UNCERTAINTY AND DO NOT SIGNIFY CURRENT OR FUTURE PROPERTY PERFORMANCE.