

15201 E Twelve Mile Rd

Roseville, MI

- 30,648 Square Feet
- Great Building on 12 Mile Road
- 1.5 Miles to I-696
- Updated Offices | Power Well Distributed
- Current Tenant is Relocating
- Quick Occupancy

INDUSTRIAL BUILDING FOR LEASE



27,548 SF of Factory



3,100 SF of Office



3 Grade Level Doors

FOR MORE INFORMATION:

Tom Jablonski
Senior Vice President
248.637.7794
tjablonski@LMCap.com

248.637.9700 | LMCap.com

Information contained herein was obtained from sources deemed to be reliable but is not guaranteed. Subjects to prior sales, changes of price or withdrawal.



L. MASON CAPITANI
CORFAC INTERNATIONAL

CELEBRATING 60 YEARS

15201 E Twelve Mile Rd

Roseville, MI



L. MASON CAPITANI

CORFAC INTERNATIONAL

CELEBRATING 60 YEARS

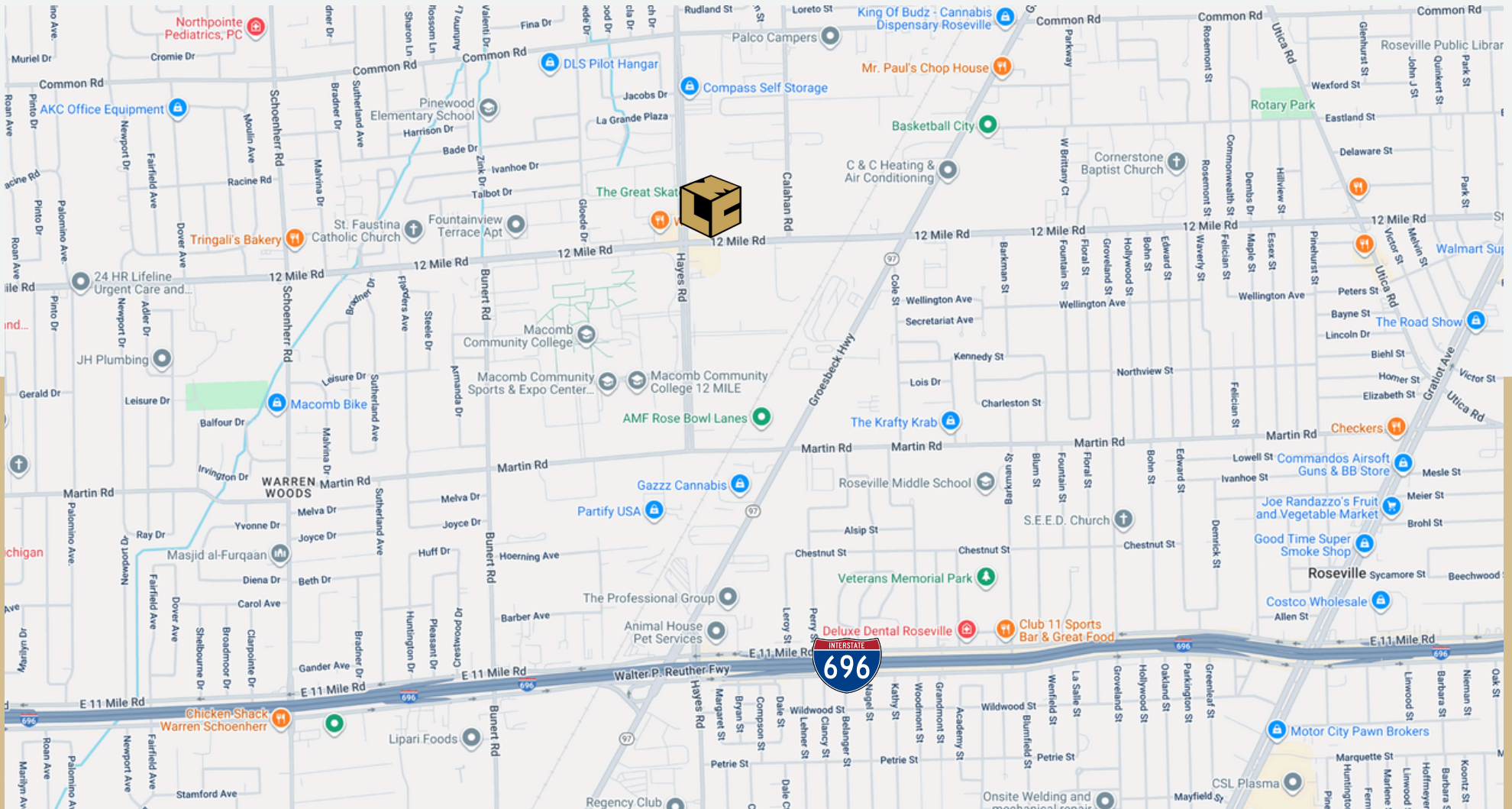

248.637.9700 | LMCap.com

Information contained herein was obtained from sources deemed to be reliable but is not guaranteed. Subjects to prior sales, changes of price or withdrawal.

15201 E Twelve Mile Rd

Roseville, MI



L. MASON CAPITANI

CORFAC INTERNATIONAL

CELEBRATING 60 YEARS



248.637.9700 | LMCap.com

Information contained herein was obtained from sources deemed to be reliable but is not guaranteed. Subjects to prior sales, changes of price or withdrawal.

FOR LEASE

15201 E Twelve Mile Rd

Roseville, MI



L. MASON CAPITANI

CORFAC INTERNATIONAL

CELEBRATING 60 YEARS

Industrial Property Details:

Details:

Total SF:	30,648 SF
Available SF:	30,648 SF
Office SF:	3,100 SF
Factory SF:	27,548 SF
Zoning:	Industrial
Acres:	1.80
Frontage:	147'
Depth:	604'
Expandable:	No
Intersection:	12 Mile Rd/Hayes Rd
X-Way Distance:	1 Mile to I-696
Parking:	On-Site
Year Built:	1966
Year Renovated:	2015
Outside Storage:	No
Rail Siding:	No
Occupancy:	Immediate

Interior:

Ceiling Height:	14', 17'
Bay Size:	50'
Restrooms:	5
Power:	440/480 V 1,000-2,000 Amps
Lighting:	Fluorescent
Truckwells:	1 ext.
Grade Door:	3
Heating:	Tube Radiant
A/C:	Office Only
Sprinklered:	None
Air Lines:	Yes
Compressor:	No
Floor Drains:	Yes

Economic

Lease/SF:	\$6.95
Lease/Month:	\$17,750.00
Lease Terms:	NNN
Taxes:	\$35,000.00

Notes: Very clean usable space. Power well distributed. Easy access truckwell. Updated offices & shop. Main road frontage. One mile from I-696 Access.

248.637.9700 | LMCap.com

Information contained herein was obtained from sources deemed to be reliable but is not guaranteed. Subjects to prior sales, changes of price or withdrawal.

15201 E Twelve Mile Rd

Roseville, MI



L. MASON CAPITANI

CORFAC INTERNATIONAL

CELEBRATING 60 YEARS

Building Layout

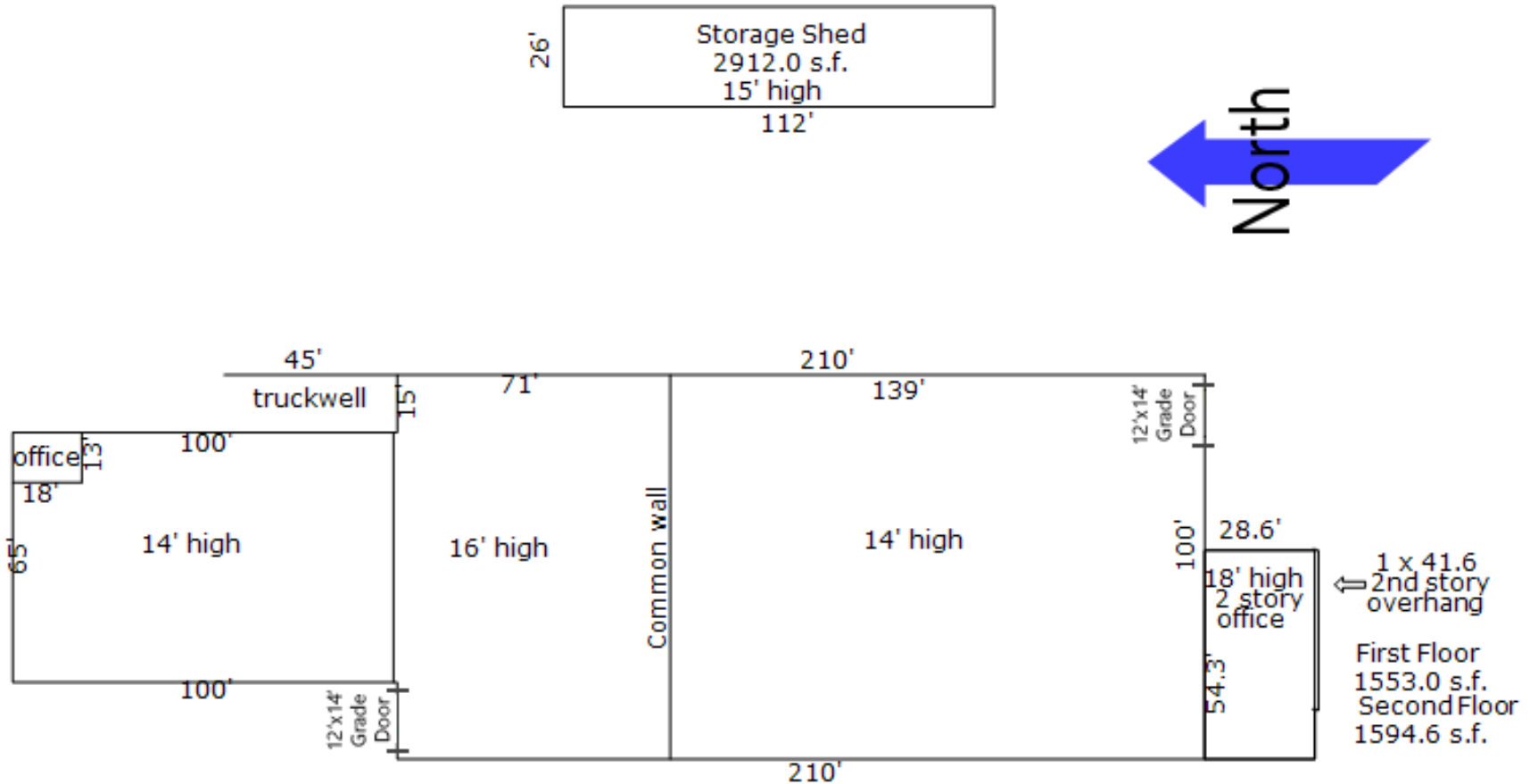

248.637.9700 | LMCap.com

Information contained herein was obtained from sources deemed to be reliable but is not guaranteed. Subjects to prior sales, changes of price or withdrawal.