

# EASTRIDGE CENTER

## Neighboring Businesses

- Perkins Restaurant
- Cancun's Mexican Grill
- Associated Bank
- Coldwell Banker
- T Mobile
- Burger King
- O'Reilly Auto Parts
- Walgreens

LOCATED AT:

2221 Highland Avenue Eau Claire, WI 54701

## ABOUT GOLDRIDGE

Since **1987**, we have worked to perfect our methods in management, leasing, acquisition, and development of real estate.

Goldridge's **expertise, professionalism, and dedication** to your growth make us the right choice for all your commercial real estate needs.

When you are a tenant in one of our Wisconsin commercial properties, you are an **integral part in the ongoing success and growth of our communities**.

Choosing to rent commercial space from one of our Eau Claire, Chippewa Falls, Rice Lake, Mondovi, or Wisconsin Rapids properties is a decision to work with a **company dedicated to your success**.

**CONTACT US:** | Andrew Martin, Leasing Agent

[amartin@goldridge.com](mailto:amartin@goldridge.com) | 715-832-5575



# PROPERTY SPECIFICATIONS

**Current gross leasable area:** 158,926 Sq. Ft.

**Parking spaces available:** 756 Total

**Traffic Count:** 21,000 + AADT

**Cross Streets:** Business 53 (S. Hastings Way) & Highland Ave.

## Current businesses leasing within the center include:

- Department of Workforce Development
- Department of Corrections
- Citizens Community Federal
- Adecco
- Customer Traac
- Saving Grace
- Sun Tan City
- Midwest Meals

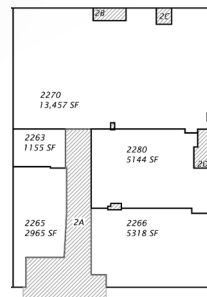

**SECOND LEVEL  
SOUTH SIDE**

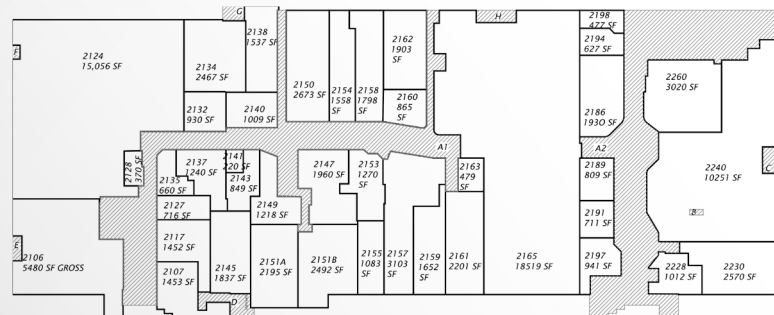

**FIRST LEVEL**



## LEASING

**EastRidge Center is a mixed-use office and retail business center located on S Hastings Way that offers:**

- Controlled intersection with main thoroughfare
- Center-dedicated parking lots
- Suites built to suit your needs
- Directly on Eau Claire Transit Bus Route
- Just over one mile to the 53 Bypass
- Fitness facility on site
- Signage space available
- High traffic area
- Very competitive rates

***Whether your need is office space or finding the right retail location for your business, our leasing process focuses around creating the right fit for you.***



**GOLDRIDGE  
COMPANIES**

**CONTACT US:**

Andrew Martin, Leasing Agent • 715-832-5575 • amartin@goldridge.com • GoldridgeCompanies.com