

SUBLEASE ±3,545 SF

2815 Manor Rd.

the STATION

Contact

Logan Dalgleish
ldalgleish@cresa.com
913.707.9194

cresa

PROPERTY INFORMATION

SUBLEASE



**2815 MANOR RD.
SUITE 204
AUSTIN, TX 78722**

Rate: \$36.00/ SF

Opex: \$15.48/ SF

Size: 3,545 SF

Term: January 31, 2027

Parking: 11 Spaces

 Creative Office Space

 Outdoor Patio Access

 4 Conference Rooms

 Controlled Access for Entry

 Architectural Skylights

 Open Floor Plan

 Kitchenette & Break Area

 Prime Location in East Austin



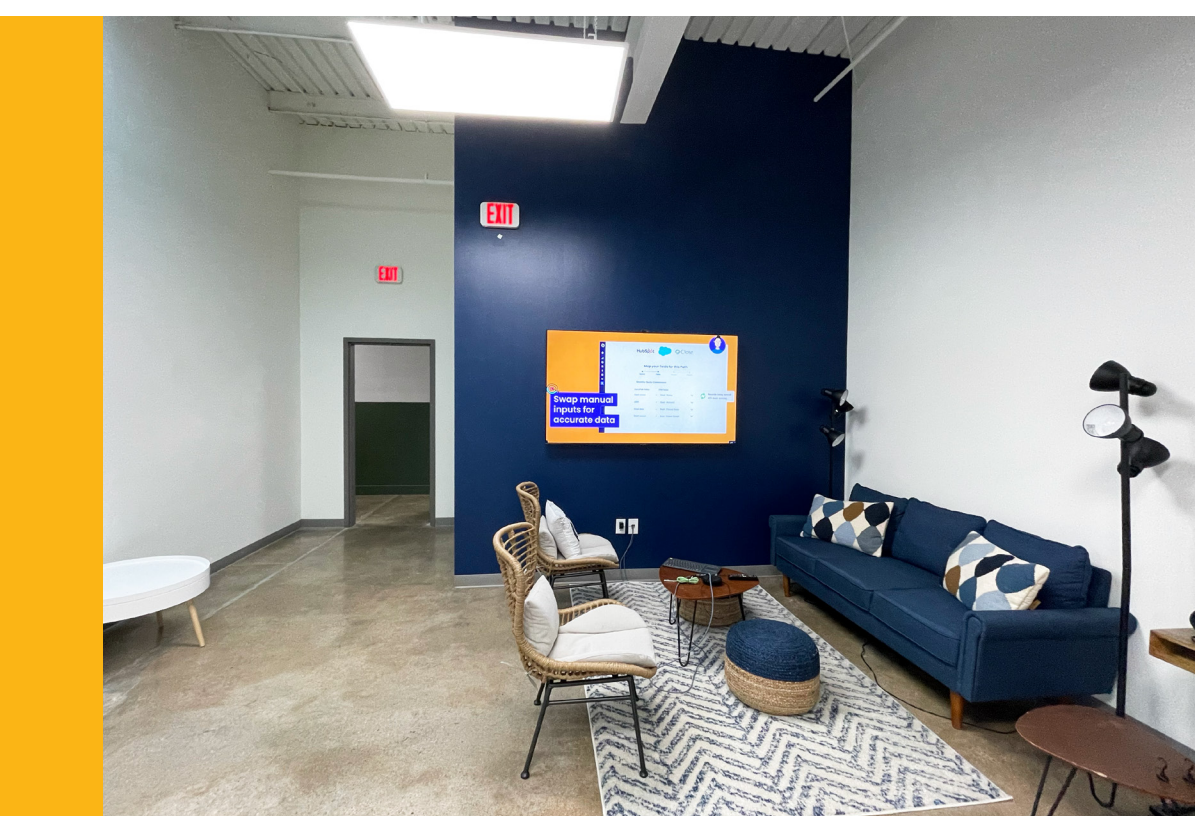

FLOORPLAN

± 3,545 SF

2815 MANOR RD.

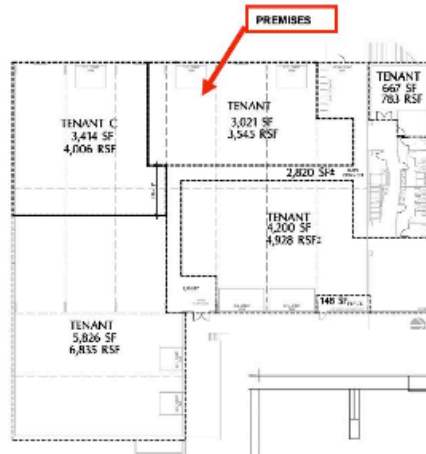

Floorplan 3,545 SQ.FT

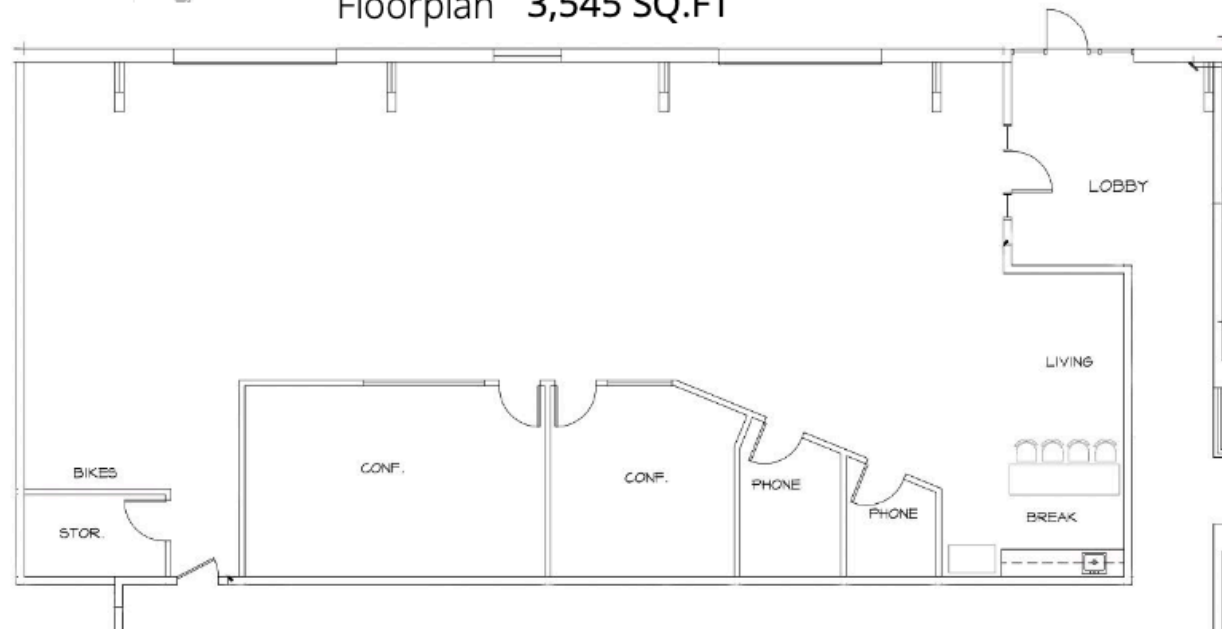

AREA MAP

2815 MANOR RD.

- 1 Love Supreme
- 2 Fleet Coffee
- 3 Bird Bird Biscuit
- 4 Dai Due
- 5 Haymaker
- 6 El Chilito
- 7 Thunderbird Coffee
- 8 Nixta Taqueria
- 9 Civil Goat
- 10 La Santa Barbacha

 12 minutes to Austin Airport

 8 minutes to Downtown Austin

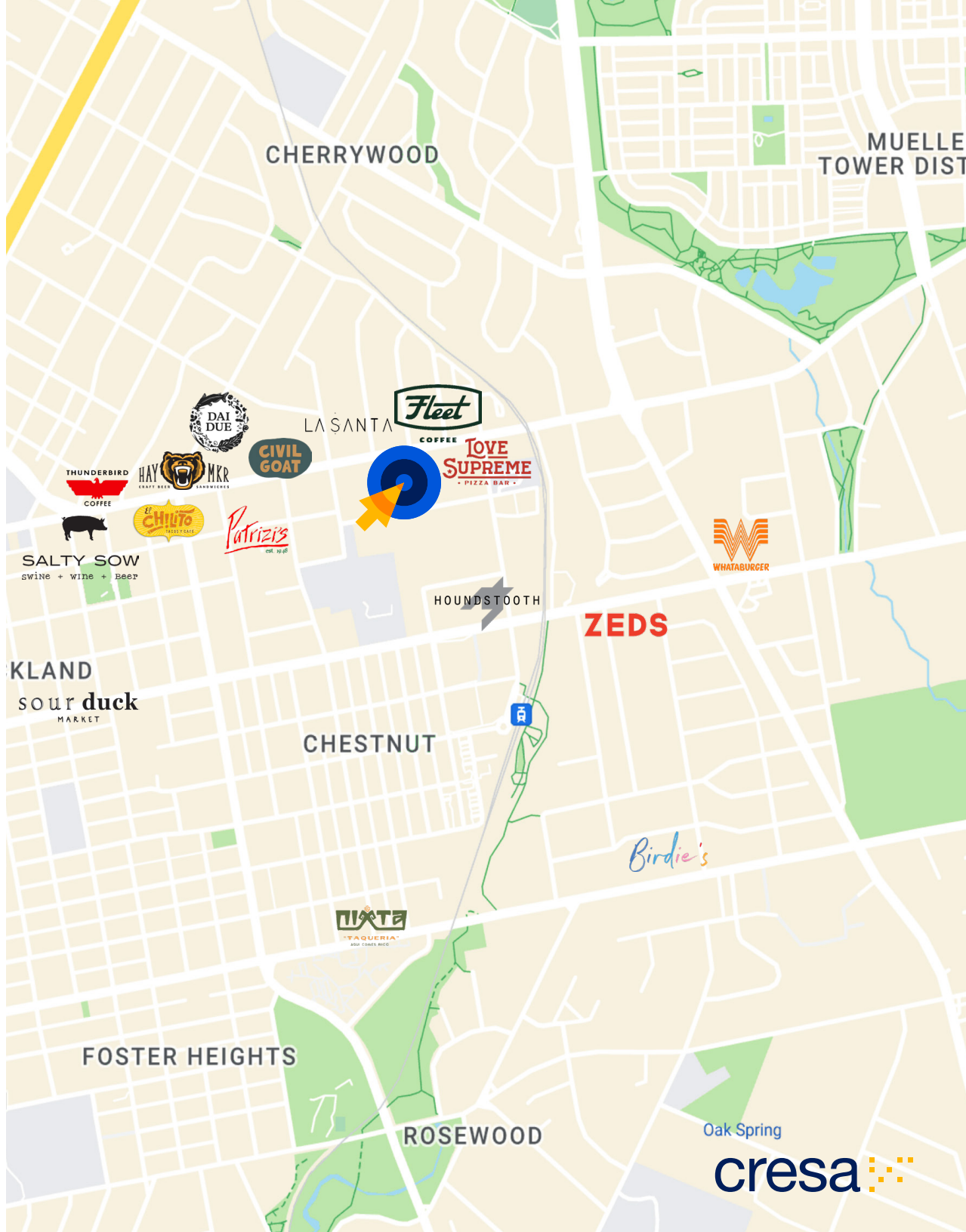



Contact Broker

Logan Dagleish
ldagleish@cresa.com
913.707.9194

Address

901 W. 9th Street
Suite 102
Austin, TX 78703

[TREC Information on Broker Services](#)

Even though obtained from sources deemed reliable, no warranty or representation, express or implied, is made as to the accuracy of the information herein, and it is subject to errors, omissions, change of price, rental or other conditions, withdrawal without notice, and to any special listing conditions imposed by our principals.