

# Retail Space

For Lease

136 Westminster St Providence, RI 02903





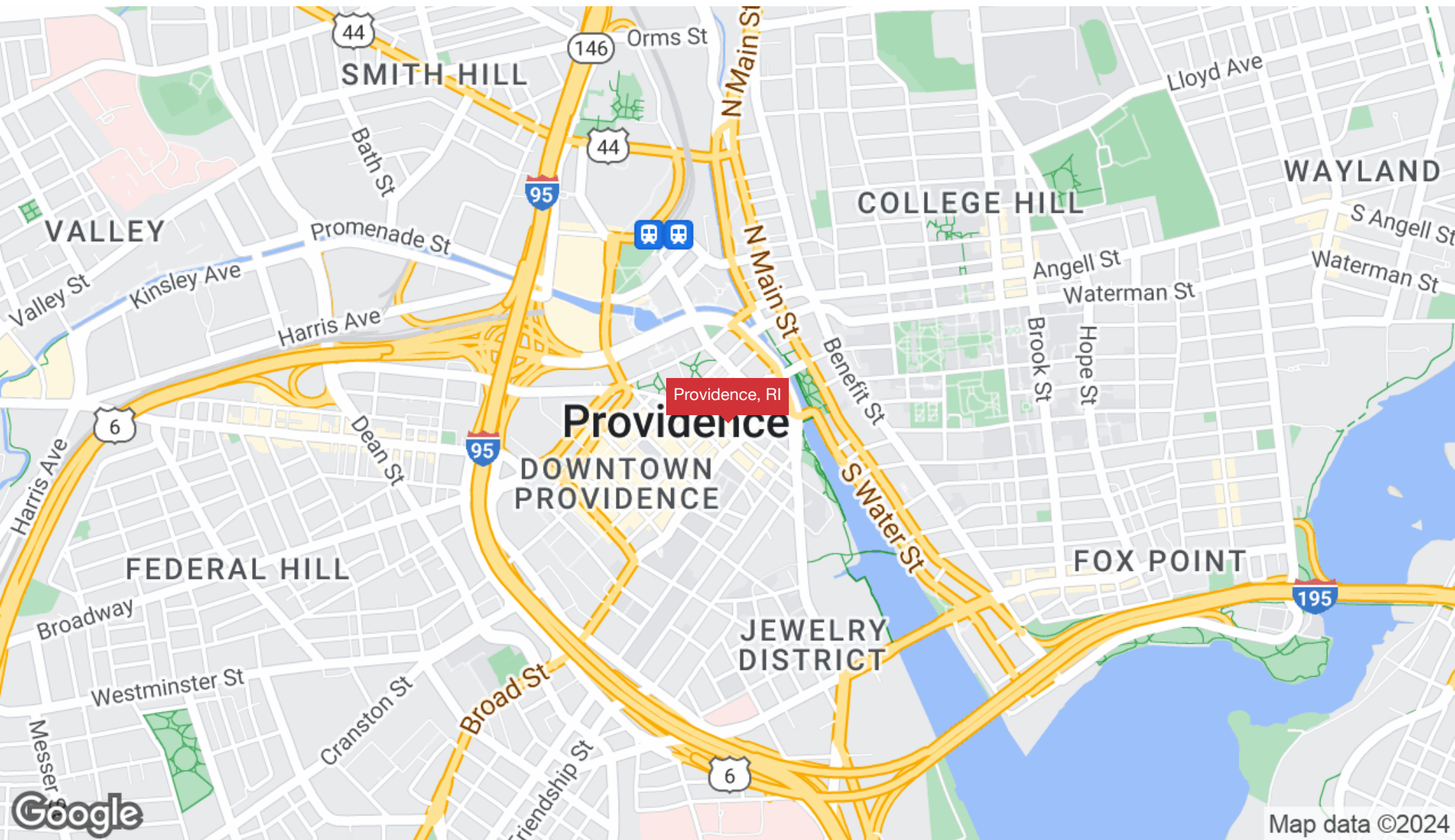



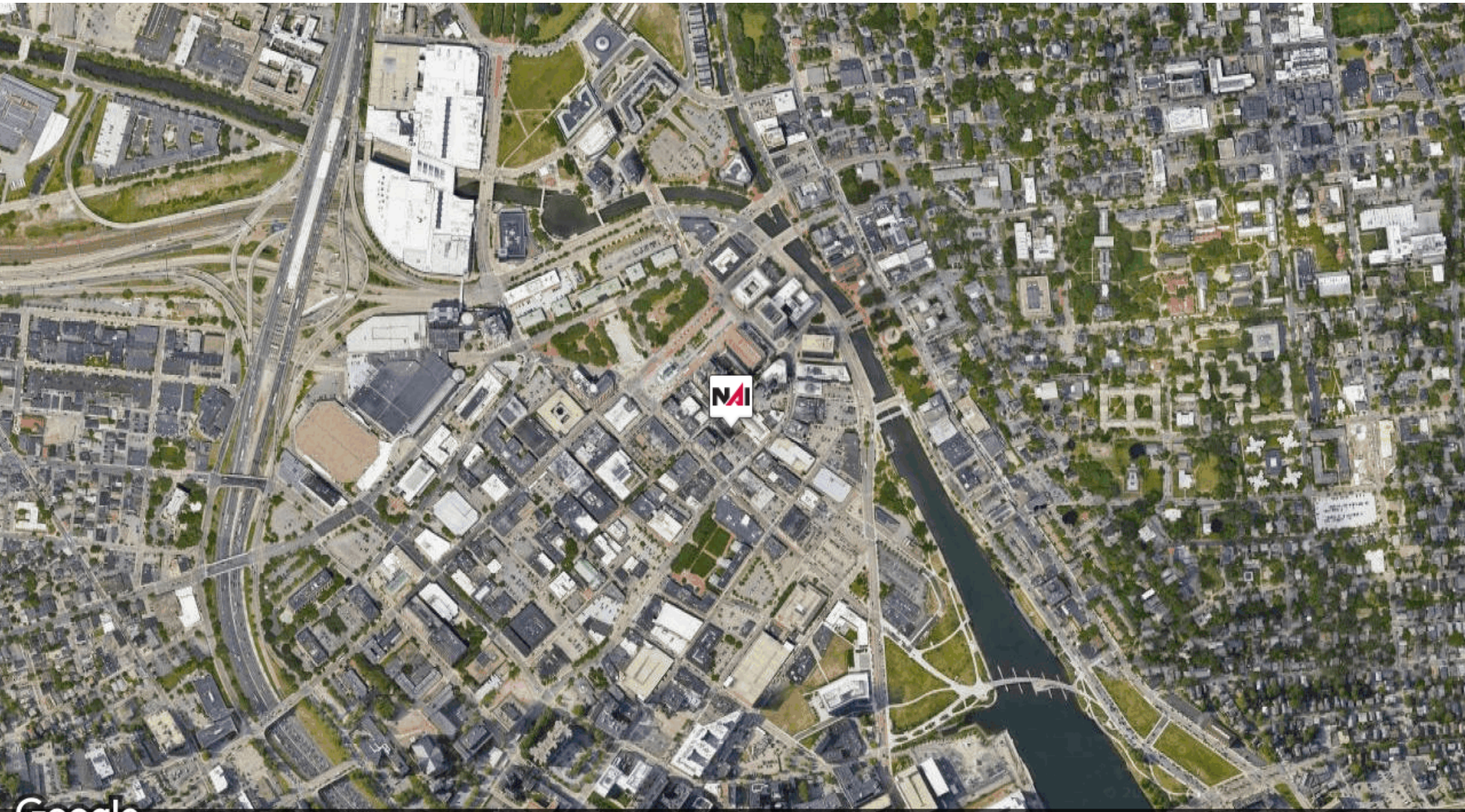

Google, CNES / Airbus, MassGIS, Commonwealth of Massachusetts EOE, Maxar Technologies, RIGIS, USDA/FPAC/GEO



## Lease Rate

\$26.00 SF/Yr

## Location Information

Building Name	The Lauderdale Building
Street Address	136 Westminster St
City, State, Zip	Providence, RI 02903
County	Providence

## Building Information

Building Size	33,738 SF
Number of Floors	5
Year Built	1920
Number of Buildings	1

## Property Information

Property Type	Retail
Property Subtype	Street Retail
Zoning	D-1-30
Lot Size	7,790 SF
APN #	200366
Lot Depth	0 ft

## Parking & Transportation

## Utilities & Amenities

Restrooms	0
-----------	---

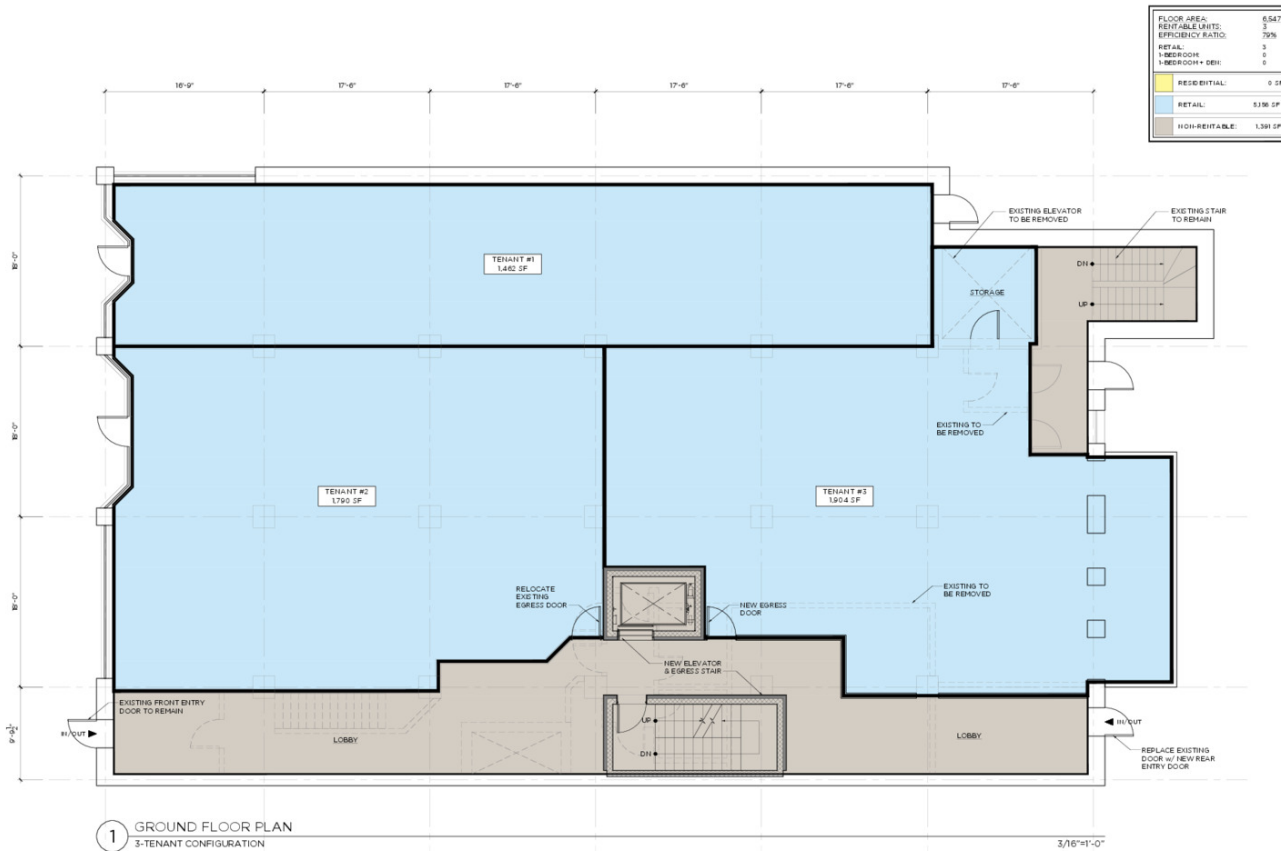







For additional information please contact:

## NAI Advisors

**Bob Berle**

O: 401 287 0870

bberle@naiadvisors.com

## Disclaimer

Information included or referred to herein is furnished by third parties and is not guaranteed as to its accuracy or completeness. You understand that all information included or referred to herein is confidential and furnished solely for the purpose of your review in connection with a potential purchase of the subject property(ies), as applicable. Independent estimates of pro forma income and expenses should be developed by you before any decision is made on whether to make any purchase. Summaries of any documents are not intended to be comprehensive or all-inclusive, but rather only outline some of the provisions contained therein and are qualified in their entirety by the actual documents to which they relate. The asset owner(s), their servicers, representatives and/or brokers, including but not limited to NAI Member, NAI Member, Another Company? and their respective agents, representatives,

affiliates and employees, (i) make no representations or warranties of any kind, express or implied, as to any information or projections relating to the subject asset(s), and hereby disclaim any and all such warranties or representations, and (ii) shall have no liability whatsoever arising from any errors, omissions or discrepancies in the information. Any solicitation for offers to purchase the subject asset(s) is subject to prior placement and withdrawal, cancellation or modification without notice.

