

# Cypress Plaza

6365 NW 6<sup>th</sup> Way  
Fort Lauderdale, FL 33309



## For Lease

±2,270 SF Office Space

## Key Highlights



Modern, upgraded office building  
in a lush corporate park



Adjacent to I-95 at Powerline  
& W Cypress Creek Road



Steps from popular retail,  
dining, hotels & more



Excellent parking ratio:  
4/1,000 SF

## Property Features

- Recently upgraded three-story office building in the Corporate Park at Cypress Creek
- Excellent location minutes from main roads, highways, business centers, and hotels
- Steps from lifestyle centered retail and dining, including LA Fitness, Starbucks, Tropical Smoothie, Chili's, and LongHorn Steakhouse
- Near Fort Lauderdale Executive Airport & Keiser University Fort Lauderdale

**Lesley Sheinberg**, Managing Director

[lsheinberg@mhcreal.com](mailto:lsheinberg@mhcreal.com)

C: 561 254 7810 | O: 561 471 8000





FOR LEASE: CYPRESS PLAZA, FORT LAUDERDALE

## Great Cypress Creek Location Adjacent to I-95

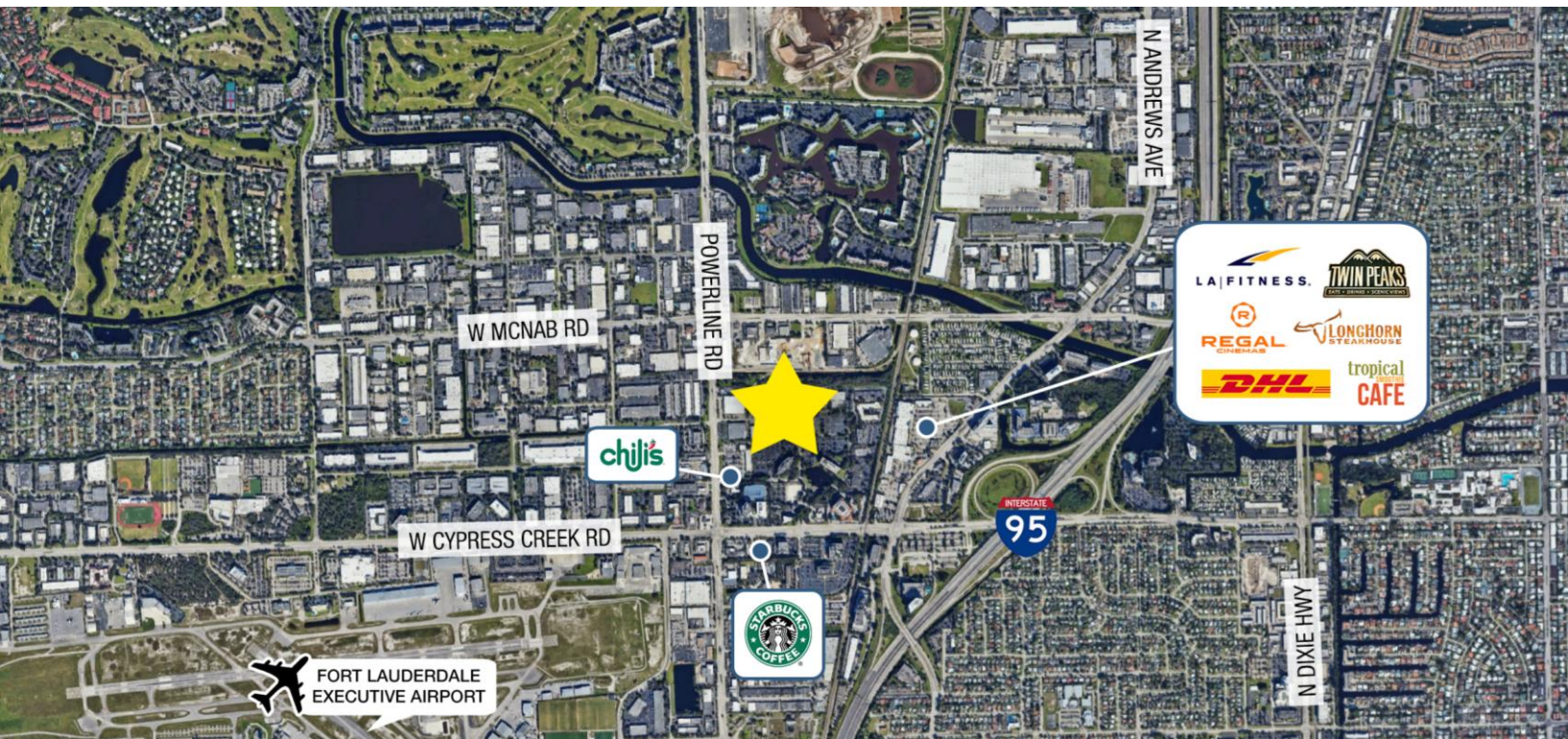

Cypress Plaza is a fully renovated, premier office building in the heart of Cypress Creek's business district. With direct access to I-95, close proximity to the Turnpike, and ample on-site parking, the property offers convenience and efficient workspace in a prime Broward location.

The building sits in a quiet corporate enclave surrounded by popular dining, retail, banking, hotels, and everyday services. It's minutes from the Fort Lauderdale Executive Airport and just 5 miles from Downtown Fort Lauderdale, giving tenants strong regional connectivity and the ease of a suburban setting.

**Available Space:** Suite 220: 2,270 SF

**Rental Rate:** \$17.50/SF NNN  
\$14.00/SF CAM; includes janitorial;  
tenant pays separately metered electric

**Parking:** Ample parking (4:1,000)



### For More Information:

Lesley Sheinberg | [lsheinberg@mhcreal.com](mailto:lsheinberg@mhcreal.com)



561 471 8000



[www.mhcreal.com](http://www.mhcreal.com)

**FOR LEASE: CYPRESS PLAZA, FORT LAUDERDALE**

## Spacious, Move-In Ready Office Suite

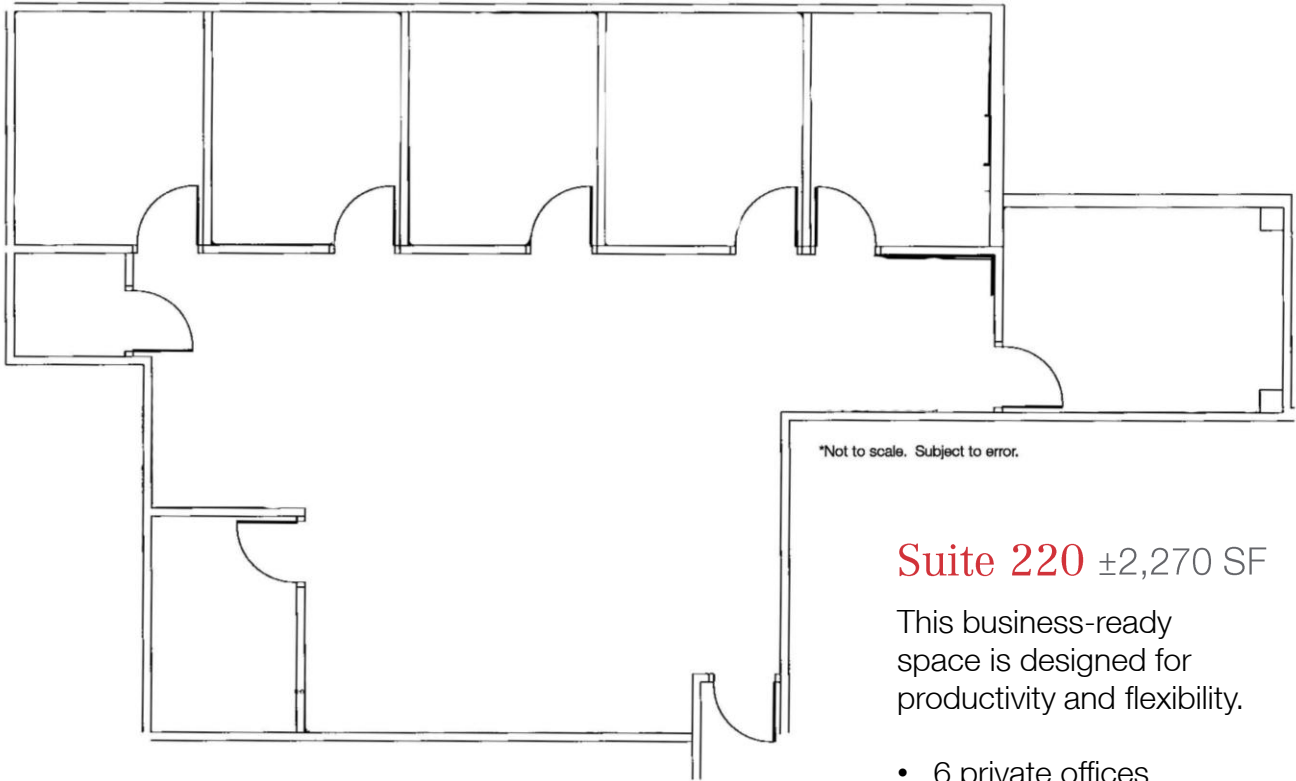

### Suite 220 ±2,270 SF

This business-ready space is designed for productivity and flexibility.

- 6 private offices
- Large open workspace
- Storage areas



**Lesley Sheinberg**, Managing Director  
[lsheinberg@mhcreal.com](mailto:lsheinberg@mhcreal.com)  
C: 561 254 7810 | O: 561 471 8000

**Call today for more information!**



**561 471 8000**