



**COMMERCIAL
REAL ESTATE**
the sign of a profitable property



BEAUTIFUL BUILT-OUT SECOND FLOOR OFFICE FOR LEASE

1045 W. Huntington Drive #2, Arcadia, CA 91007



VIEW LISTING PAGE

STEFAN SIEGEL
(818) 697-9372 | stefan@illicre.com
DRE#01356621



5990 SEPULVEDA BOULEVARD, STE. 600 - SHERMAN OAKS, CA 91411 - 818.501.2212/PHONE - www.illicre.com - DRE #01834124

OFFICE SPACE
ARCADIA, CA

PROPERTY FEATURES

1045 W. Huntington Drive #2, Arcadia, CA 91007



APPROX. 4,975 SF

BEAUTIFUL BUILT OUT SECOND FLOOR OFFICE





- ✓ Previous Mass Mutual
- ✓ Has elevator
- ✓ Perfect for financial institution, medical/urgent care
- ✓ 40 parking spaces

AREA AMENITIES

- ✓ Hard corner
- ✓ Population over 28,000 within 1 mile
- ✓ Diverse range of industries including healthcare, education and technology
- ✓ Close proximity to major transportations and freeways
- ✓ Near attractions such as Los Angeles County Arboretum, Santa Anita Park and The Shops at Santa Anita

RENT RATE

\$3.50 PSF per month NNN ± \$0.53 PSF

— DEMOGRAPHICS	1 MILE	3 MILE	5 MILE
 Population	28,444	174,158	487,197
 Med HH Income	\$82,368	\$96,043	\$82,291
 Daytime Pop	23,775	146,371	404,542
 Traffic Count	± 48,812 CPD ON SUNSET BLVD & HUNTINTON DR		

OFFICE SPACE
ARCADIA, CA

INTERIOR PHOTOS

1045 W. Huntington Drive #2, Arcadia, CA 91007



OFFICE SPACE
ARCADIA, CA

INTERIOR PHOTOS

1045 W. Huntington Drive #2, Arcadia, CA 91007



FLOOR PLAN

1045 W. Huntington Drive #2, Arcadia, CA 91007

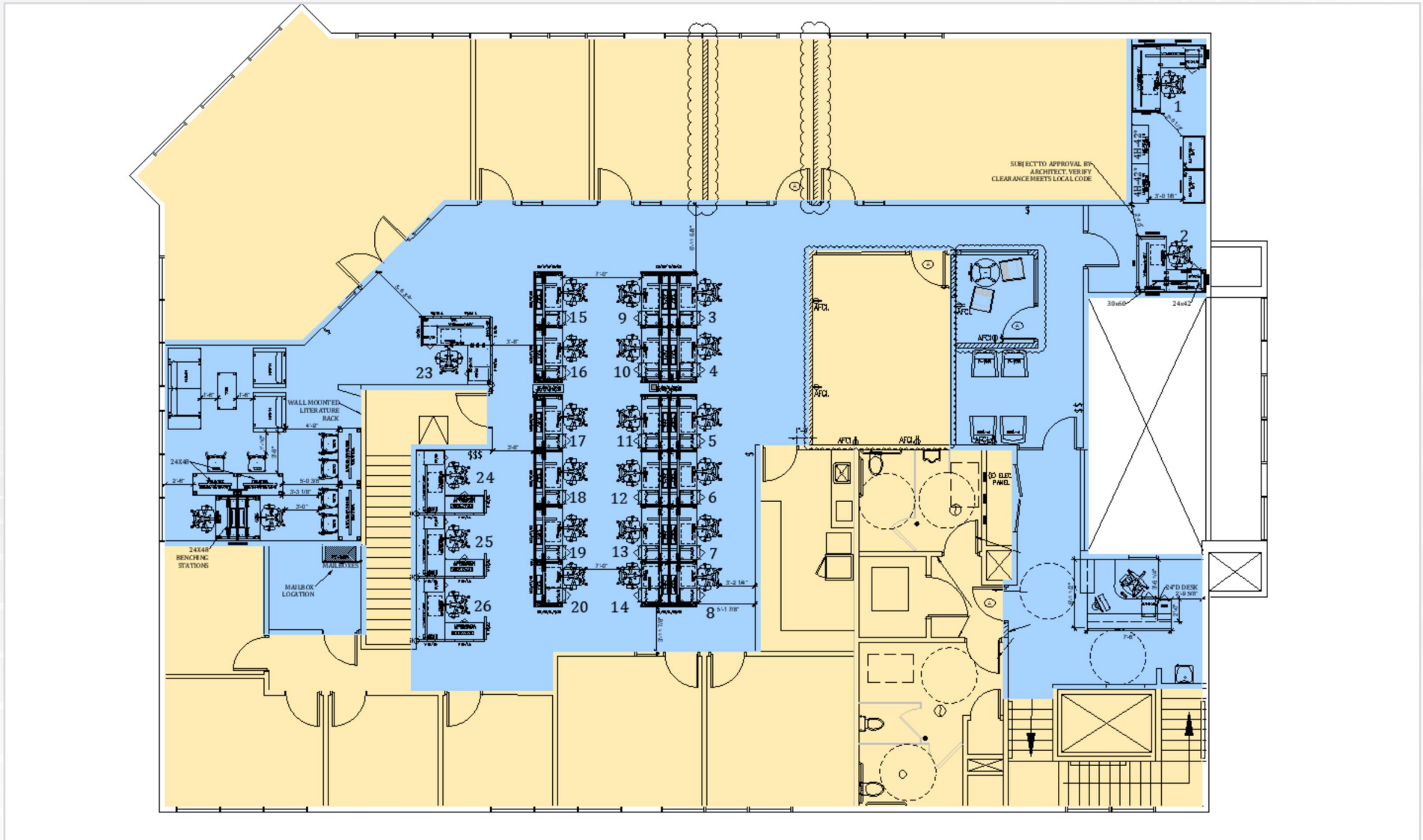

Measurements are approximate only, and Broker does not guarantee their accuracy. Tenants are subject to change, and Broker makes no representation written or implied that the features tenants will be occupying the space throughout the duration of the Lessee's tenancy. Lessee is to conduct their own due diligence before signing any formal agreements.



AVAILABLE

SUNSET BLVD

SUNSET BLVD

HUNTINGTON DR

HUNTINGTON DR

DUARTE RD

DUARTE RD



ROSEMEAD BLVD

Google



NORDSTROM



AERIAL MAP



**COMMERCIAL
REAL ESTATE**

STEFAN SIEGEL
SENIOR ASSOCIATE

(818) 697-9372 | stefan@illicre.com

DRE#01356621



5990 SEPULVEDA BLVD., STE. 600 | SHERMAN OAKS, CA 91411 | 818.501.2212/PHONE | www.illicre.com | DRE #01834124

This information has been secured from sources we believe to be reliable, but we make no representations or warranties, expressed or implied, as to the accuracy of the information. References to square foot-age are approximate. References to neighboring retailers are subject to change, and may not be adjacent to the vacancy being marketed either prior to, during, or after leases are signed. Lessee must verify the information and bears all risk for any inaccuracies.