



ATLANTA COMMERCIAL
REAL ESTATE BROKERS

FOR LEASE | FLEX SPACE IN HIRAM

Suite 101- 7,500 SF

38 SOUTHERN CT
HIRAM, GA 30141

DON EDWARDS

Associate Broker/Commercial Director
(770) 324-3457

don@dbeproperties.com

119563, GA

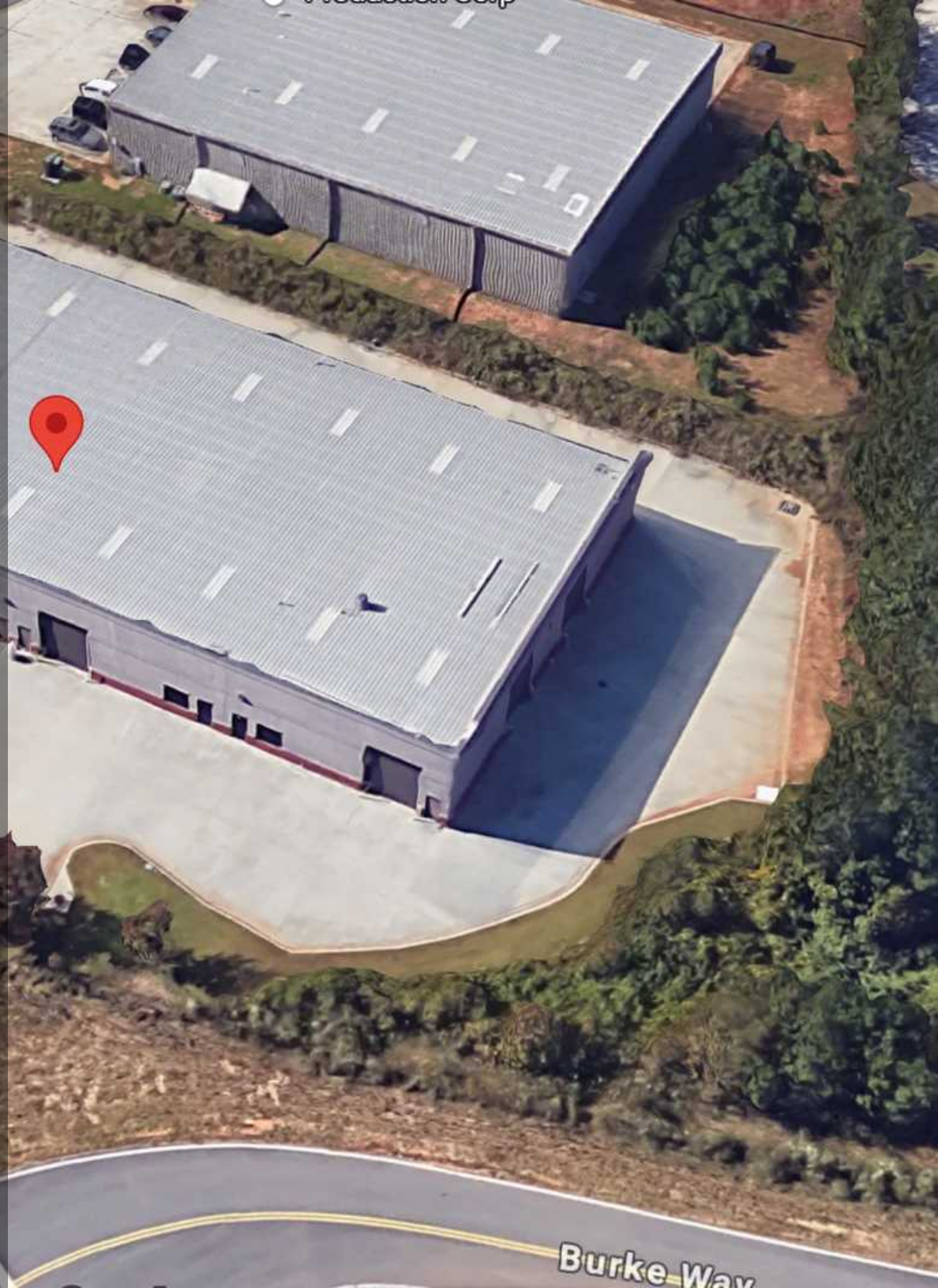



38 Southern Ct, Suite 101 Hiram GA 30141

- Conveniently located between Hiram and Powder Springs
- Suite 101- 7,500 SF (Approx 1,200 SF Office)
- 4 12' Roll Up Doors
- Ceiling height 16-20FT
- Nearby national retailers, dining, Silver Comet Trail
- Located near the intersection of Bill Carruth Pkwy and US HWY 278, C H James Pkwy.

Property Overview

Exceptionally well maintained property is conveniently situated between Hiram and Powder Springs. Its proximity near the intersection of Bill Carruth Pkwy and US HWY 278, C H James Pkwy provides excellent accessibility, with nearby national retailers, dining options, and direct access to the Silver Comet Trail. With large drive in doors, this flex space is perfect for small distribution, plumbing, HVAC, electrical and other trade service companies.

Lease Rate:	\$12.00 PLUS \$1.50 CAM
Zoning:	I-1 (Light Industrial)
Parking Ratio:	AMPLE
Power:	3 Phase
Year Built:	2007
Lot Size:	1.46 Acres
County:	GA - Paulding
Market:	Atlanta Metro
Sub-market:	West Hiram

Suite 101

- 7,500 SF
- End unit in three-unit building
- Four 12' roll up doors with 16-20 feet of clearance Approximately 1,200 square feet of office space

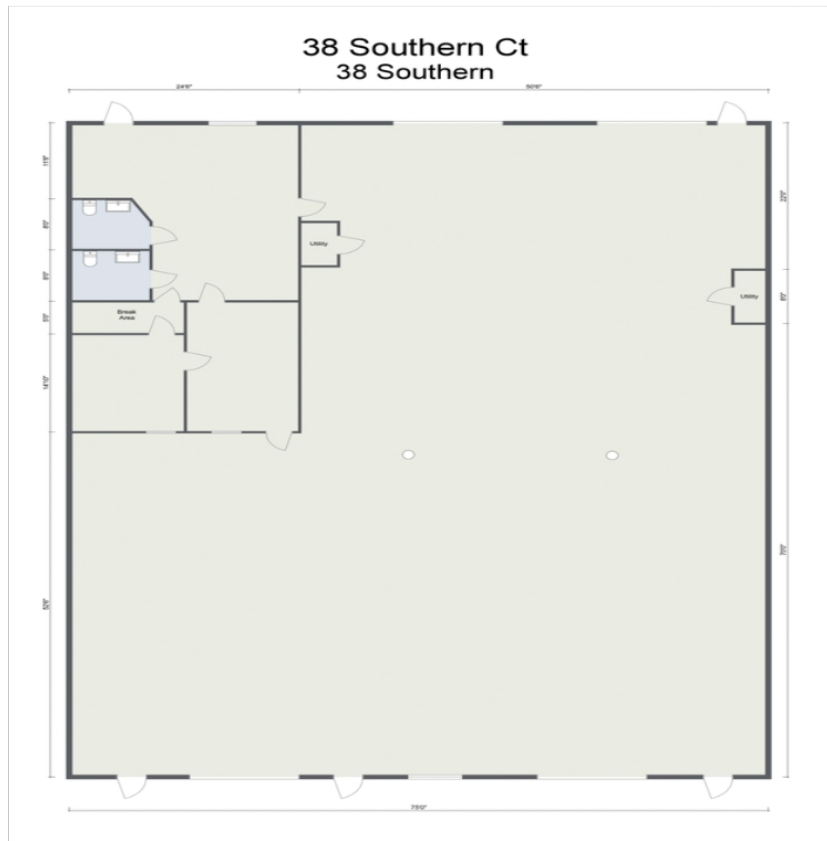

SUITE 101 PHOTOS



We obtained the information above from sources we believe to be reliable. However, we have not verified its accuracy and make no guarantee, warranty or representation about it. It is submitted subject to the possibility of errors, omissions, change of price, rental or other conditions, prior sale, lease or financing, or withdrawal without notice. We include projections, opinions, assumptions or estimates for example only, and they may not represent current or future performance of the property. You and your tax and legal advisors should conduct your own investigation of the property and transaction.

AREA OVERVIEW

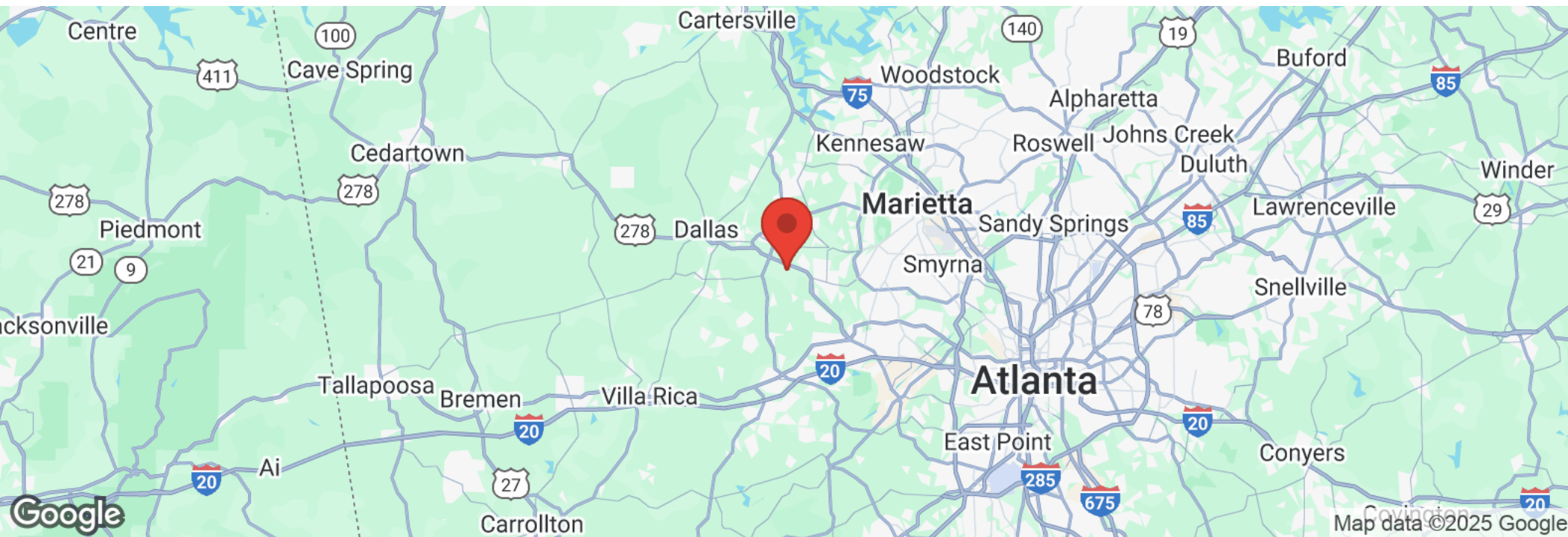

City

Hiram, Georgia, is a growing city in Paulding County, west of Atlanta. It offers a suburban lifestyle with easy access to urban amenities. The city features local parks and community events. Located on Highway 278, Hiram is experiencing commercial and residential growth, making it a desirable place to live and work.



DEMOGRAPHICS

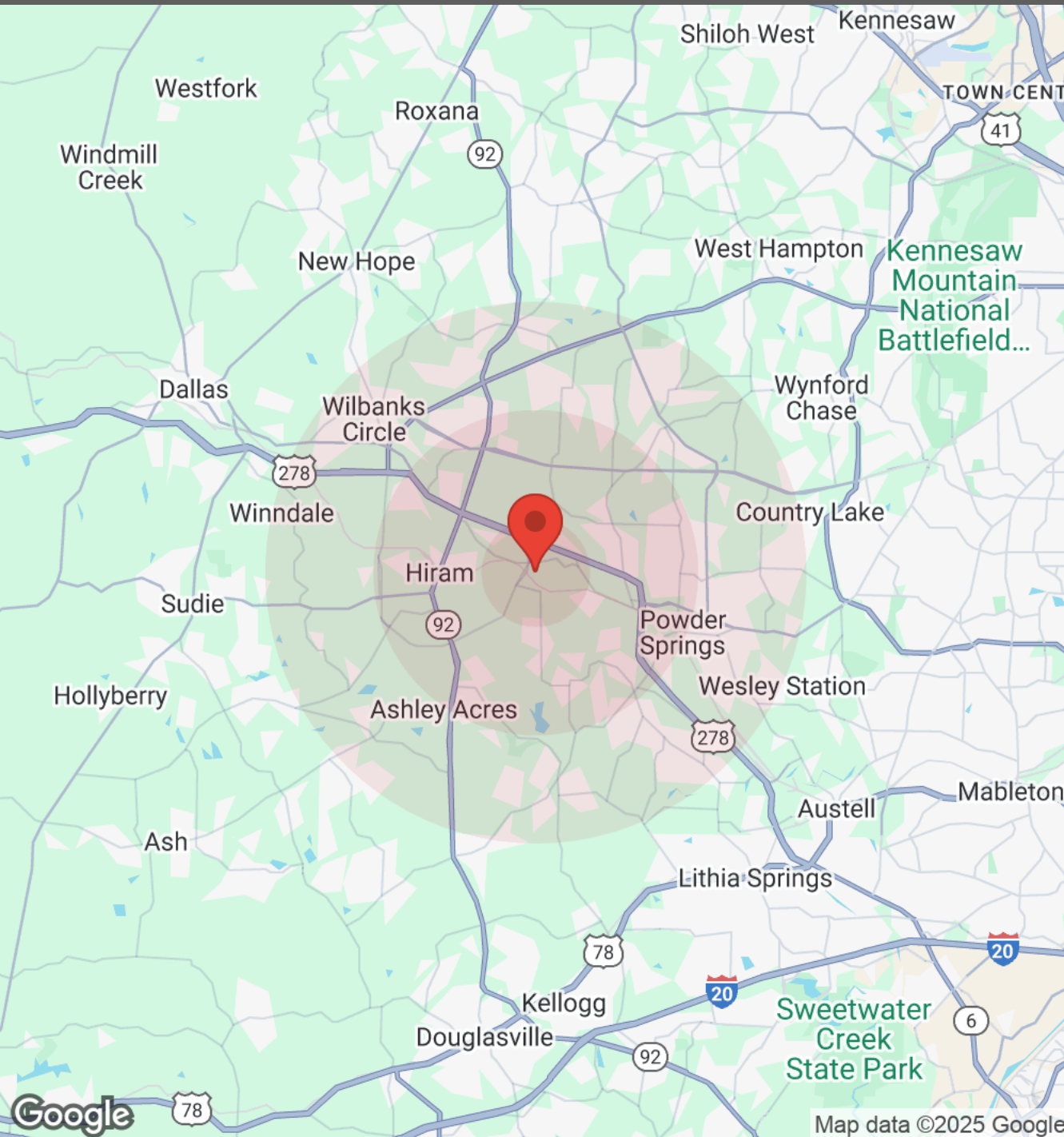

Population	1 Mile	3 Miles	5 Miles
Male	1,777	15,491	45,806
Female	2,207	17,819	50,838
Total Population	3,984	33,310	96,645

Age	1 Mile	3 Miles	5 Miles
Ages 0-14	747	6,164	18,070
Ages 15-24	534	4,453	13,231
Ages 25-54	1,537	13,495	38,565
Ages 55-64	502	4,572	13,264
Ages 65+	661	4,625	13,515

Race	1 Mile	3 Miles	5 Miles
White	1,847	14,513	43,906
Black	1,554	13,684	37,411
Am In/AK Nat	4	33	97
Hawaiian	4	23	39
Hispanic	388	3,444	10,621
Asian	88	796	2,194
Multi-Racial	88	726	2,117
Other	11	90	251

Income	1 Mile	3 Miles	5 Miles
Median	\$69,678	\$95,960	\$100,469
< \$15,000	203	716	1,997
\$15,000-\$24,999	69	302	1,198
\$25,000-\$34,999	107	431	1,274
\$35,000-\$49,999	85	744	2,554
\$50,000-\$74,999	476	2,203	5,473
\$75,000-\$99,999	155	2,036	4,755
\$100,000-\$149,999	344	2,928	8,521
\$150,000-\$199,999	162	1,707	4,896
> \$200,000	43	1,138	3,997

Housing	1 Mile	3 Miles	5 Miles
Total Units	1,697	12,631	35,837
Occupied	1,644	12,204	34,662
Owner Occupied	814	9,052	26,130
Renter Occupied	830	3,152	8,532
Vacant	53	426	1,175

We obtained the information above from sources we believe to be reliable. However, we have not verified its accuracy and make no guarantee, warranty or representation about it. It is submitted subject to the possibility of errors, omissions, change of price, rental or other conditions, prior sale, lease or financing, or withdrawal without notice. We include projections, opinions, assumptions or estimates for example only, and they may not represent current or future performance of the property. You and your tax and legal advisors should conduct your own investigation of the property and transaction.



DONALD B EDWARDS JR

Commercial Director and Associate Broker

Licensed in 1984, Don has completed hundreds of commercial real estate transactions across the USA including industrial, retail, office, medical, multifamily, land, timber, mining and multi family residential, as well as, landlord and tenant representation, property management and site selection for national franchises. As the head of the trust real estate department for all the South Trust Banks, he was responsible for a full staff and a \$750M portfolio of diverse assets including retail, office, medical, industrial, land, mining, timber, farms, leases, mortgages, property inspections and asset management from coast to coast. In addition, he has over 18 years of commercial and residential construction experience. His land deals have included assemblages, out parcels, and development sites for all asset classes. Don is a past president of the Association of Georgia Real Estate Exchangors, and has executed numerous 1031 exchanges. In addition, he has passed all of the CCIM course work.



ATLANTA COMMERCIAL
REAL ESTATE BROKERS

Cell: 770.324.3457
Office: 770-240-2004
don@dbeproperties.com

Administrative/Additional Contacts:
admin@dbeproperties.com
markie@atlmetrocre.com

Showing Contact:
Aaliyah Zapata 470-626-5746
aaliyah@thebrightsiderg.com

DISCLAIMER

All materials and information received or derived from DBE Properties, its directors, officers, agents, advisors, affiliates and/or any third party sources are provided without representation or warranty as to completeness, veracity, or accuracy, condition of the property, compliance or lack of compliance with applicable governmental requirements, developability or suitability, financial performance of the property, projected financial performance of the property for any party's intended use or any and all other matters.

Neither DBE Properties, its directors, officers, agents, advisors, or affiliates makes any representation or warranty, express or implied, as to accuracy or completeness of the any materials or information provided, derived, or received. Materials and information from any source, whether written or verbal, that may be furnished for review are not a substitute for a party's active conduct of its own due diligence to determine these and other matters of significance to such party. DBE Properties will not investigate or verify any such matters or conduct due diligence for a party unless otherwise agreed in writing.

EACH PARTY SHALL CONDUCT ITS OWN INDEPENDENT INVESTIGATION AND DUE DILIGENCE.

Any party contemplating or under contract or in escrow for a transaction is urged to verify all information and to conduct their own inspections and investigations including through appropriate third-party independent professionals selected by such party. All financial data should be verified by the party including by obtaining and reading applicable documents and reports and consulting appropriate independent professionals. DBE Properties makes no warranties and/or representations regarding the veracity, completeness, or relevance of any financial data or assumptions. DBE Properties does not serve as a financial advisor to any party regarding any proposed transaction.

All data and assumptions regarding financial performance, including that used for financial modeling purposes, may differ from actual data or performance. Any estimates of market rents and/or projected rents that may be provided to a party do not necessarily mean that rents can be established at or increased to that level. Parties must evaluate any applicable contractual and governmental limitations as well as market conditions, vacancy factors and other issues in order to determine rents from or for the property. Legal questions should be discussed by the party with an attorney. Tax questions should be discussed by the party with a certified public accountant or tax attorney. Title questions should be discussed by the party with a title officer or attorney. Questions regarding the condition of the property and whether the property complies with applicable governmental requirements should be discussed by the party with appropriate engineers, architects, contractors, other consultants, and governmental agencies. All properties and services are marketed by DBE Properties in compliance with all applicable fair housing and equal opportunity laws.