

FOR LEASE

±2,180 SF MEDICAL SPACE

**LEE &
ASSOCIATES**
COMMERCIAL REAL ESTATE SERVICES
PASADENA

**DISCOUNTED
RATE!**

**1330 San Bernardino Road
Upland, CA 91786**



CHRIS JOHNSON
Senior Vice President
chris.johnson@lee-associates.com
626.240.2786
License ID 01934154

FOR LEASE
±2,180 SQUARE FOOT MEDICAL SPACE

1330
SAN BERNARDINO ROAD
UPLAND, CA 91786

OFFERING INFORMATION

+ Asking Rate:	\$2.15 MG
+ Suite Size:	Suite J ±2,180 SF
+ Total Building SF:	±8,976 SF
+ Lot Size:	±74,488 SF
+ Year Built:	1978
+ Parking Ratio:	5.57040998217469
+ APN:	1046-161-02-0000

PROPERTY HIGHLIGHTS

- + Functional Layout
- + Abundant Parking
- + Competitive Rate



FOR LEASE
±2,180 SQUARE FOOT MEDICAL SPACE

1330
SAN BERNARDINO ROAD
UPLAND, CA 91786

PROPERTY PHOTOS



FOR LEASE
±2,180 SQUARE FOOT MEDICAL SPACE

1330
SAN BERNARDINO ROAD
UPLAND, CA 91786

PROPERTY PHOTOS



FOR LEASE
±2,180 SQUARE FOOT MEDICAL SPACE

1330
SAN BERNARDINO ROAD
UPLAND, CA 91786

FLOOR PLAN | SUITE J

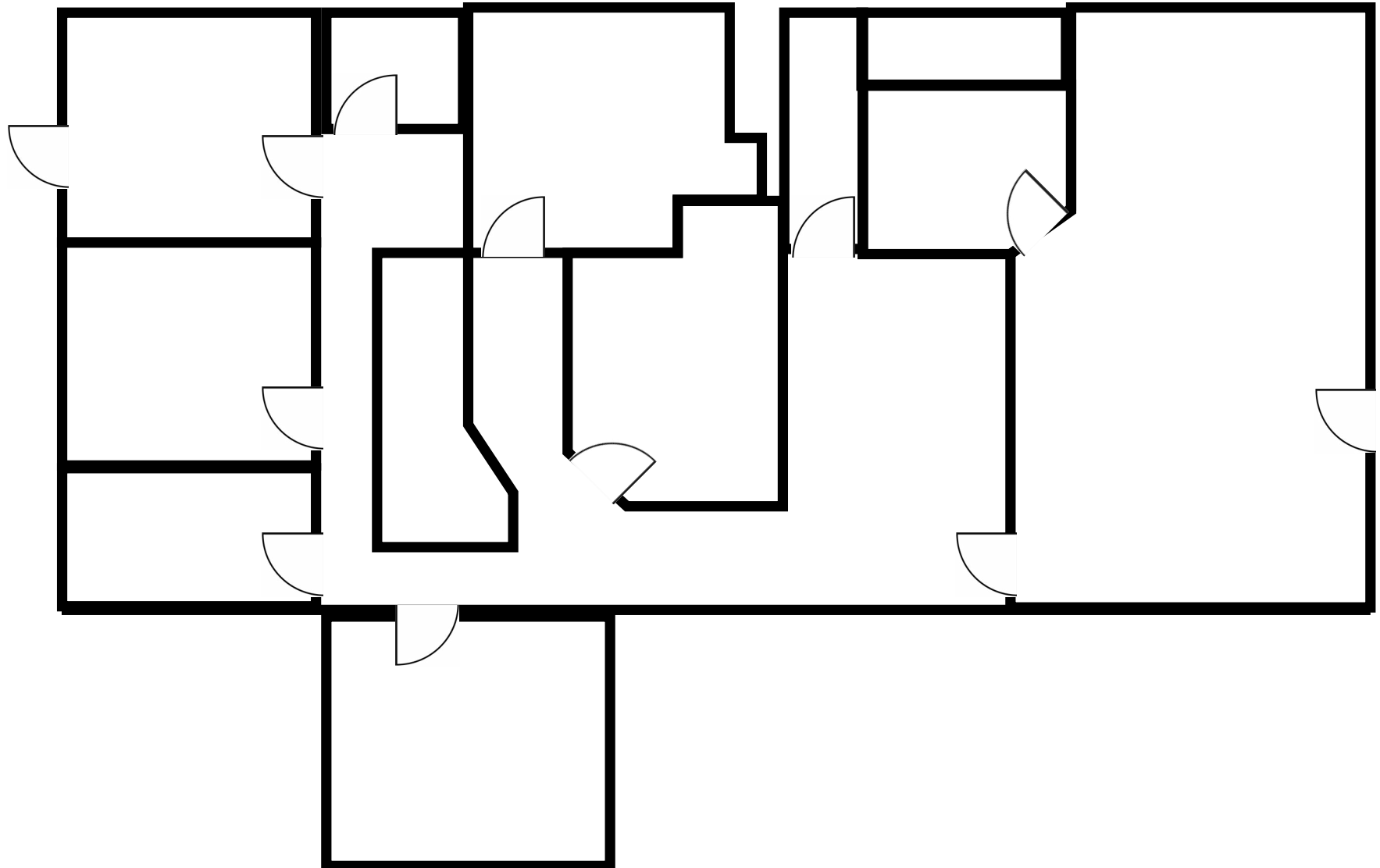

FOR LEASE
±2,180 SQUARE FOOT MEDICAL SPACE

1330
SAN BERNARDINO ROAD
UPLAND, CA 91786

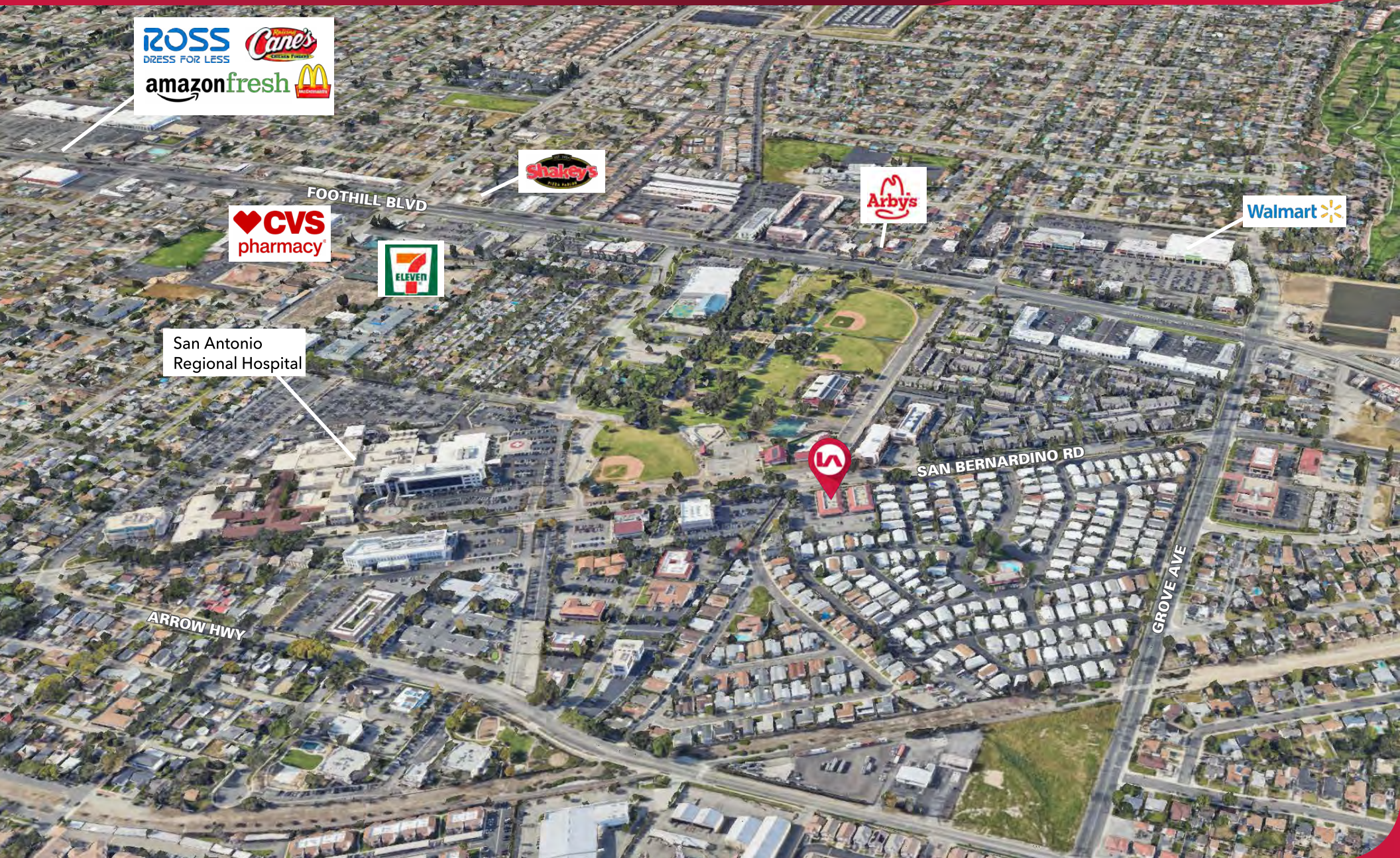

FOR LEASE
±2,180 SQUARE FOOT MEDICAL SPACE

1330
SAN BERNARDINO ROAD
UPLAND, CA 91786

LOCATION HIGHLIGHTS

- + Walking Distance to San Antonio Hospital
- + Located in multi-specialty medical professional building
- + Many nearby amenities

