



FOR LEASE

COUNTY FAIR MARKETPLACE

1310 Highway 15 South
Hutchinson, MN 55350

Features:

Rate	\$18.00 per square foot Net
Property Type	Retail
Floors	1
Year Built	1999
County	McLeod
Availabilities	Suite 105 = 815 sq ft
CAM Tax	\$9.77 (est. 2026) \$3.02 (est. 2026)
PID	R23-325-0060
Zoning	Mixed Use / Retail
Parking	Approximately 80 surface stalls with cross easements
Other	<ul style="list-style-type: none">◆ One of 8 suites in the building; 7 others are occupied.◆ Located on SWQ of Hwy 15 & Denver Ave SW◆ Near Target and Walmart

About The Building:

The property is commonly known as County Fair Marketplace and is located in the heart of the Hutchinson retail area. The building is an outlet to "Big Box" retailers Target, Harbor Freight and Aldi, along with other outlet users.

Existing tenants include a Chinese restaurant, pizza shop, hair salon, cell phone store, nail salon and sandwich shop.



About The Area:

Hutchinson is the largest city in McLeod County, Minnesota, along the south fork of the Crow River. The population was 14,701 at the 2023 census. Hutchinson is known as Minnesota's hometown due to the comfortable and at-ease atmosphere.

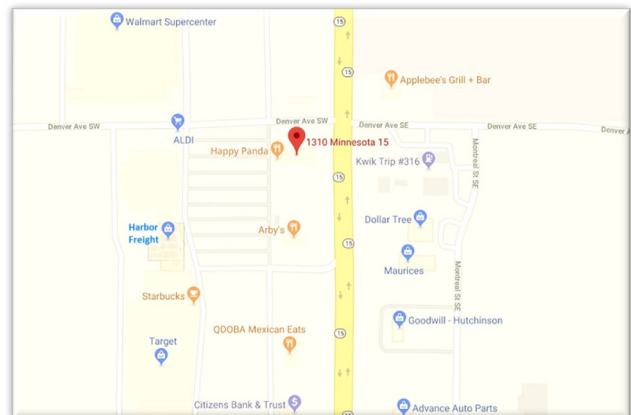

JBL COMPANIES

3440 Federal Drive, Suite 250, Eagan, MN 55122 | Phone: 651-686-0212 | Fax: 651-686-6113 | jblbrokerage@jblcompanies.com

www.jblcompanies.com

County Fair Marketplace
1310 Highway 15 South
Hutchinson, MN 55350

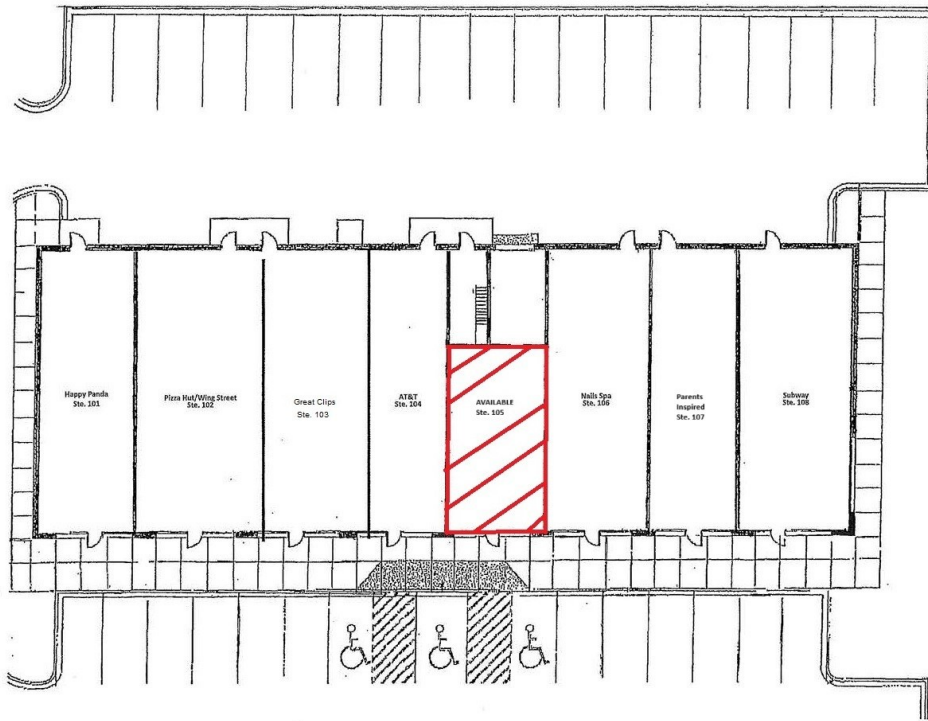

Suite 105 = 815 sq ft

This plan is attached for informational purposes only and is not a warranty, representation or agreement that the Shopping Center or the parking areas, p's, access points, sidewalks, buildings or other improvements will be as shown hereon, or that the occupants shown hereon will be in the Shopping Center.



JBL COMPANIES

3440 Federal Drive, Suite 250, Eagan, MN 55122 | Phone: 651-686-0212 | Fax: 651-686-6113 | jblbroker-
age@jblcompanies.com