

SOUTHWOOD PLAZA

132-138 SOUTH ROAD, ENFIELD, CONNECTICUT



AVAILABLE
FOR LEASE

RETAIL/ENTERTAINMENT/ PROFESSIONAL SPACE

Goman+York Property Advisors, LLC is pleased to present 132-138 South Road, Enfield, for lease. This neighborhood retail center features a flexible layout and can accommodate a variety of retail and commercial uses, and is perfect for a family restaurant, convenience retailer or entertainment destination. Join Riverside Reptiles Education Center and Great Wall Restaurant in the revitalization of this convenient shopping and entertainment plaza, which received a **NEW PARKING LOT** and **NEW ROOF** in late 2019.

Riverside Reptiles Education Center just completed a 12,750 SF renovation for hands-on learning and educational programs for children and families. It is anticipated to draw **TENS OF THOUSANDS** of visitors per year and become one of CT's new family destinations. The property is located 1.8 miles from Interstate-91, exit 47E and Hazard Avenue and has ample on-site parking.



FOR MORE INFORMATION CONTACT

Rob Montesi | 860.866.7572 | rmontesi@gomanyork.com

©2020 GOMAN+YORK Property Advisors, LLC. The information above has been obtained from sources believed reliable. While we do not doubt its accuracy, we have not verified it and make no guarantee, warranty or representation about it. It is your responsibility to independently confirm its accuracy and completeness. You and your advisors should conduct a careful, independent investigation of the property to determine to your satisfaction the suitability of the property for your needs.

SOUTHWOOD PLAZA

132-138 SOUTH ROAD, ENFIELD, CONNECTICUT

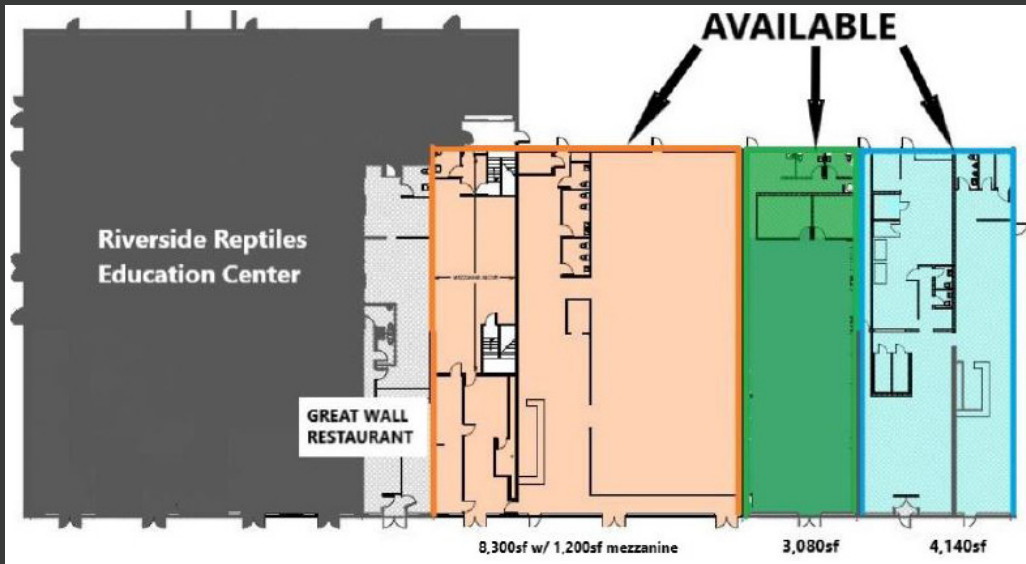

THREE AVAILABLE SPACES

are contiguous and can be combined for up to 15,520 SF.

ASKING RENT

\$12.00 Triple Net

FEATURES

- 30,000 +/- square foot retail center
- Storefront spaces ranging from 2,400 to 15,520 square feet
- Convenient access to I-91 and major routes
- Large parking lot, repaved, landscaped and lit in 2019
- 8,800 Average Daily Traffic



FOR MORE INFORMATION CONTACT

Rob Montesi | 860.866.7572 | rmontesi@gomanyork.com

©2020 GOMAN+YORK Property Advisors, LLC. The information above has been obtained from sources believed reliable. While we do not doubt its accuracy, we have not verified it and make no guarantee, warranty or representation about it. It is your responsibility to independently confirm its accuracy and completeness. You and your advisors should conduct a careful, independent investigation of the property to determine to your satisfaction the suitability of the property for your needs.