

NEW CONSTRUCTION INDUSTRIAL PROPERTY FOR SALE

3410 WEST NELIS DRIVE

MERIDIAN, IDAHO 83646



TOK

COMMERCIAL

DAN MINNAERT SIOR, CCIM
208.947.0845 | brent@tokcommercial.com

DEVIN PIERCE SIOR
208.947.0850 | devin@tokcommercial.com

\$8,900,000

UPDATED: 12.20.2024

THIS PROPERTY IS EXCLUSIVELY MARKETING BY TOK EASTERN IDAHO LLC DBA TOK COMMERCIAL
This information was obtained from sources believed reliable but cannot be guaranteed. Any opinions or estimates are used for example only.

TOKCOMMERCIAL.COM



OFFERING DETAILS

Property Address **3410 W. Nelis Drive
Meridian, ID 83646**

Building Size **36,100 SF Total**

Lot Size **2.49 Acres**

Zoning **I-L, Light Industrial**

Dock Doors **2**

Grade Doors **4**

Power **800 Amps, 480 Volts, 3 Phase**

Clear Height **26'**



Sale Price **\$8,900,000 | \$246.54/SF**



- New construction industrial building.
- Excellent central location, strategically located just off the Ten Mile Road corridor, surrounded by rapid growth.
- Less than 10 minutes to Interstate access, via Ten Mile's Exit 42.
- Dock high doors and grade level doors.
- Rear storage/patio area.



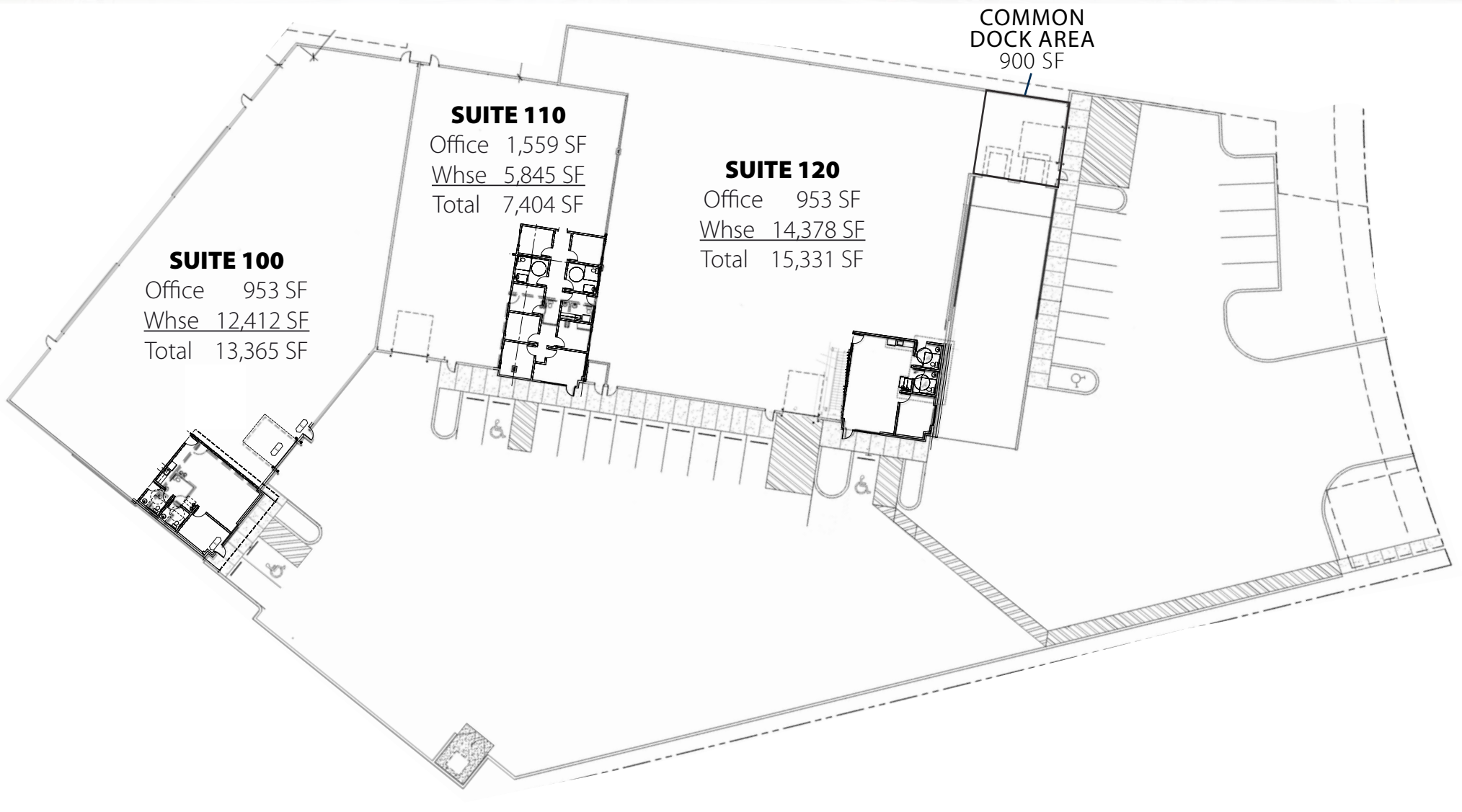
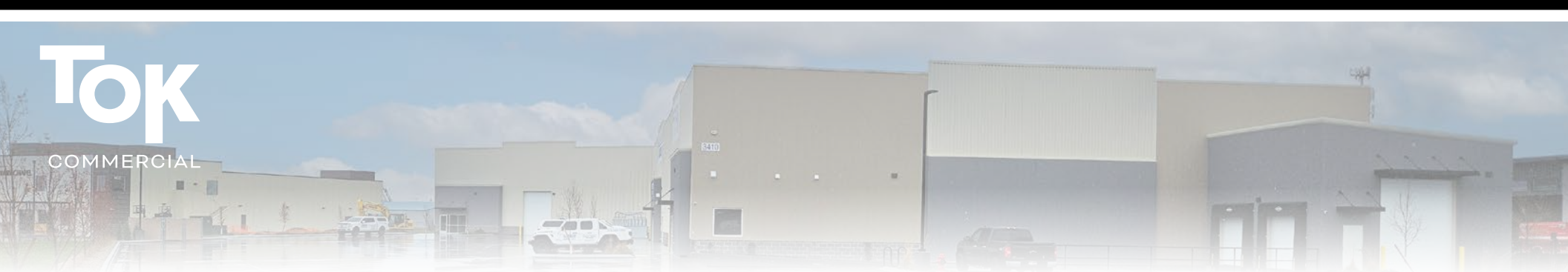

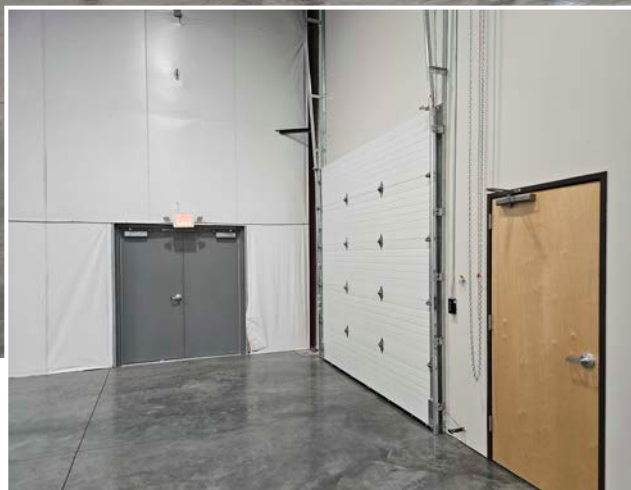
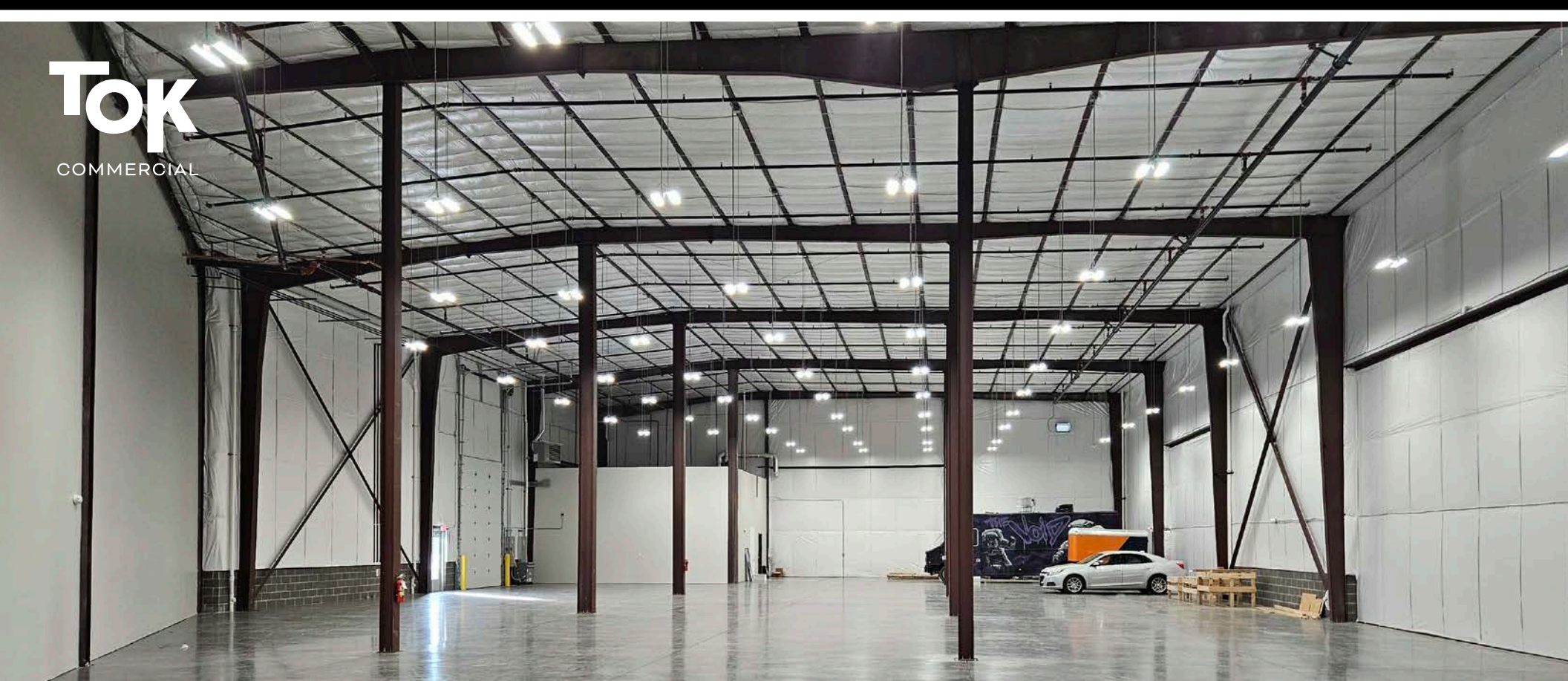



SITE

LOCATED JUST OFF TEN MILE ROAD CORRIDOR

EASY, DIRECT ACCESS TO THE INTERSTATE!



↓ 9 MINUTE COMMUTE TO I-84

← 15 MINUTE COMMUTE TO NAMPA

20 MINUTE COMMUTE TO BOISE →

NEW CONSTRUCTION INDUSTRIAL PROPERTY FOR SALE

3410 WEST NELIS DRIVE

MERIDIAN, IDAHO 83646

TOK
COMMERCIAL

DAN MINNAERT, SIOR
208.947.0845 | dan@tokcommercial.com

DEVIN PIERCE, SIOR, CCIM
208.947.0850 | dan@tokcommercial.com



THIS PROPERTY IS EXCLUSIVELY MARKETED BY TOK BOISE LLC DBA TOK COMMERCIAL.