



PROPERTY SUMMARY

1 AT UNION PARK / 6925 UNION PARK AVE.

CAPITAL IMPROVEMENTS - 2019

Seating 4 / 1000 PARKING RATIO

ON-SITE STORAGE



UNION PARK

BE LIFTED UP



natalie@futrcommercial.com
andy@futrcommercial.com

NATALIE JONSSON
ANDY GUNTHER



UNIMPEDED VIEWS OF
THE VALLEY & WASATCH
MOUNTAINS



UNION PARK

BE LIFTED UP

UTAH'S PREMIER SUBURBAN OFFICE PARK, LOCATED IN THE HEART OF UTAH'S SCENIC SALT LAKE VALLEY.

Union Park offers a unique park-like atmosphere with an abundance of landscaped open spaces. Fast, easy access to local freeways, restaurants, and retail shopping. Ideal for companies looking to recruit talent or offer services to the entire valley. Covered parking included at no cost.

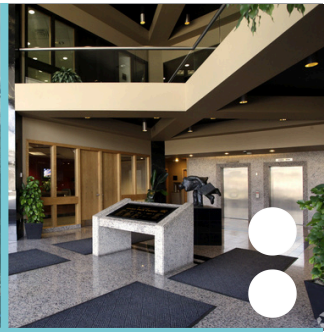
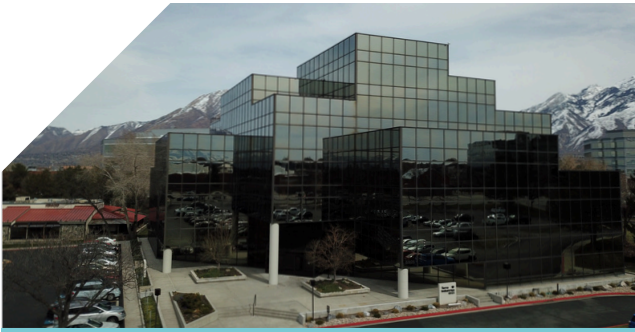

GALLERY



One of the most desirable spots for work, play & living in the Intermountain West. Boasting fantastic views from nearly every suite.

WHAT'S NEARBY?

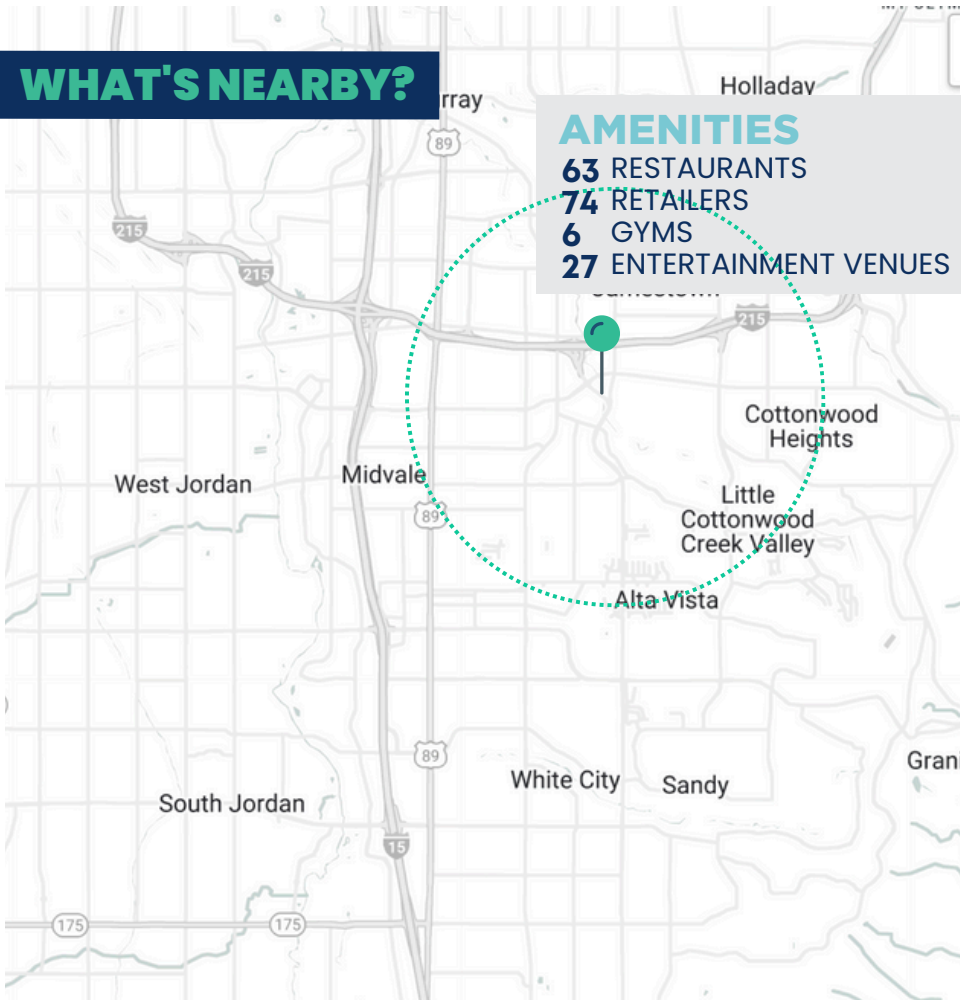

AMENITIES

63 RESTAURANTS

74 RETAILERS

6 GYMS

27 ENTERTAINMENT VENUES

UNION PARK TENANT FAVORITES

- CHIPOLTLE
- IN-N-OUT
- COSTA VIDA
- NOODLES & CO
- CHICK-FIL-A
- J-DAWGS
- CAFE RIO
- ZAO CAFE
- CAFE ZUPPAS
- JERSEY MIKES
- ITTO SUSHI
- THE PIE PIZZERIA
- JIMMY JOHNS
- VESSEL KITCHEN
- TRADER JOES
- TARGET
- 5 GUYS
- BEANS & BREWS



1 AT UNION PARK

PROPERTY FEATURES

- ON-SITE PROPERTY MANAGEMENT
- COVERED PARKING
- 24 HR SECURITY
- 1/4 MILE TO I-15
- BY MAJOR RETAIL, DINING & LODGING
- ONE OF UTAH'S TOP COMMERCIAL HUBS
- BY MAJOR RETAIL, DINING, & LODGING
- ONE OF UTAH'S TOP COMMERCIAL HUBS
- MULTIPLE ENTRY POINTS
- DEDICATED TRAFFIC LIGHT FOR ACCESS
- DAILY TRAFFIC: 10,300 CARS
- RECENT CAPITAL UPGRADES
- EV CHARGING STATIONS
- FIBER OPTIC NETWORK AVAILABLE
- AFFORDABLE RATES
- GENEROUS TI ALLOWANCE AVAILABLE

1 at Union Park is a 4-story timeless granite & glass structure located in the heart of Utah's scenic Salt Lake Valley. This Class-A facility features exclusive executive suites, unimpeded views of the valley & Wasatch Mountains, a 2-story granite and glass lobby, plentiful outdoor parking & much more.

CLASS A
FINISHES

ON SITE
PROPERTY MANAGEMENT



UNION PARK

BE LIFTED UP

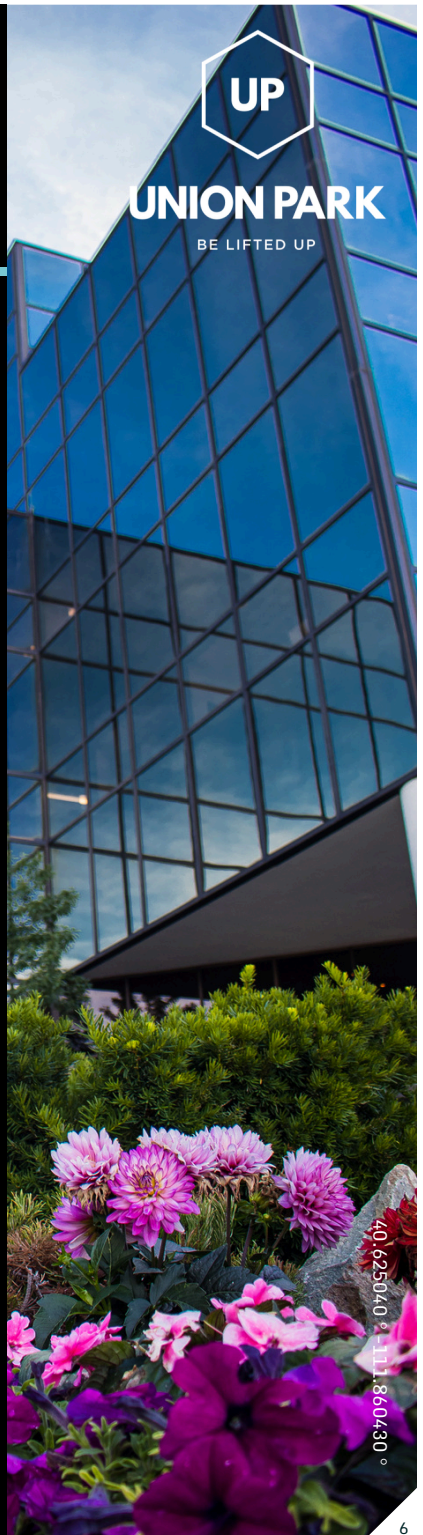

401.625.0400 • 111.860.3300

AVAILABILITY

1 at UNION PARK, SUITE 490



LOCATION	6925 UNION PARK AVE. 84047
SF/COST	UPON REQUEST
STATUS	AVAILABLE

SPACE PLAN



PRESENTED BY



natalie@futrcommercial.com | **NATALIE JONSSON**
andy@futrcommercial.com | **ANDY GUNTHER**

www.futrcommercial.com | 801.858.0555

AVAILABILITY

1 at UNION PARK, SUITE 490

LOCATION 6925 UNION PARK AVE. 84047

SF/COST UPON REQUEST

STATUS AVAILABLE



FUTR.



PROXIMITY MAP

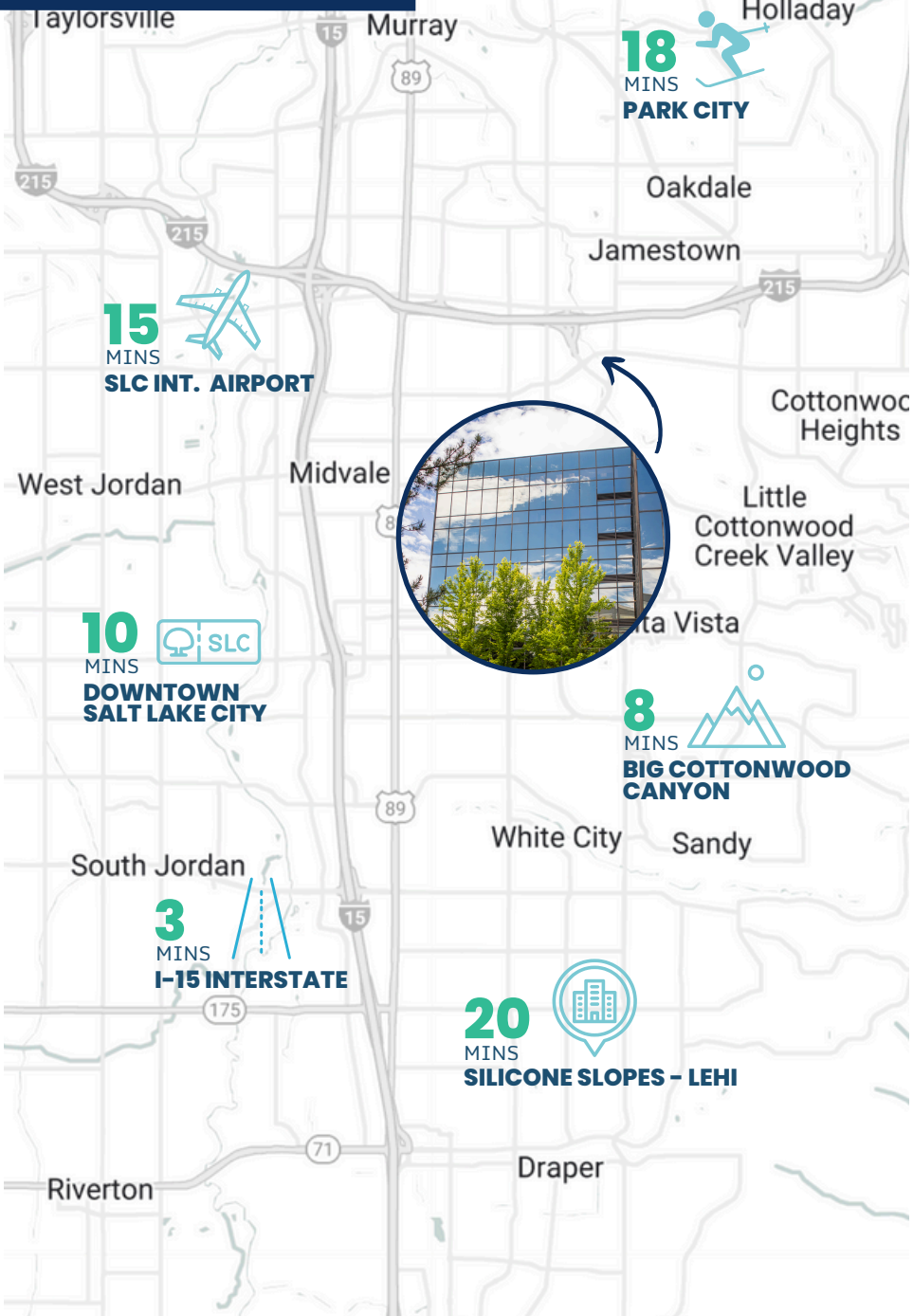

EASY ACCESS



NATALIE JONSSON | natalie@futrcommercial.com | 801.560.1217

ANDY GUNTHER | andy@futrcommercial.com | 801.541.6820