

**1810 E 17TH STREET
SANTA ANA CA 92705**

OFFICE / MEDICAL

**1,000 SF - 2,671 SF ENTIRE
\$2.50 PER SF + NNN
NEGOTIABLE**

BUILDING IS TURN KEY READY TO MOVE IN
CAN BE USED FOR OFFICE OR MEDICAL
SINGLE BUILDING WITH 2 ENTRANCES
HIGHLY DENSE RESIDENTIAL AREA
SHARE 40 PARKING SPACES



ROBERT TRAN
COMMERCIAL REAL ESTATE ADVISOR
949.780.9999
ROBERTTRANCOMMERCIAL@GMAIL.COM
LICENSE 02030957

HPT COMMERCIAL

CONFIDENTIALITY & DISCLAIMER

This Offering Memorandum (the "Memorandum") has been prepared by HPT Commercial for informational purposes only. The information contained herein is believed to be reliable, but no representation or warranty, express or implied, is made regarding its accuracy, completeness, or correctness. Prospective purchasers are encouraged to conduct their own due diligence and consult with their advisors before making any investment decision.

This Memorandum is not an offer to sell or a solicitation of an offer to buy any securities or interests in the property. Any offering or solicitation will be made only to qualified prospective purchasers pursuant to applicable laws and regulations. The information contained in this Memorandum is confidential and is intended solely for the use of the recipient. It may not be reproduced or distributed, in whole or in part, without the prior written consent of HPT Commercial.

Prospective purchasers should rely solely on their own investigation and evaluation of the property and any investment decision should be made based on the purchaser's own analysis. HPT Commercial and its representatives make no representation or warranty, express or implied, as to the accuracy or completeness of the information contained herein.

By accepting this Memorandum, you agree to the above terms and conditions.

NON-ENDORSEMENT NOTICE

HPT Commercial is not affiliated with, sponsored by, or endorsed by any commercial tenant or lessee identified in this marketing package. The presence of any corporation's logo or name is not intended to indicate or imply affiliation with, or sponsorship or endorsement by, said corporation or HPT Commercial, its affiliates or subsidiaries, or any agent, product, service, or commercial listing of HPT Commercial, and is solely included for the purpose of providing tenant lessee and market information about this listing to prospective customers. ALL PROPERTY SHOWINGS ARE BY APPOINTMENT ONLY. PLEASE CONSULT YOUR HPT COMMERCIAL AGENT FOR MORE DETAILS.

EXECUTIVE SUMMARY

For lease: a 1,000 - 2,671 SF office or medical space in excellent condition, vacant and ready for immediate occupancy. The total 1,000 SF - 2,671 SF, making it ideal for a variety of professional or medical uses. Located in a well-maintained complex, it shares 40 on-site parking spaces with two neighboring buildings, providing ample parking for staff and clients. This is a flexible, move-in-ready opportunity in a convenient location with great visibility—perfect for businesses looking for a clean, functional space.



PROPERTY HIGHLIGHTS

- **SIZE:** 1,000 – 2,671 SF AVAILABLE; DIVISIBLE INTO SUITES AS SMALL AS 1,000 SF
- **CONDITION:** EXCELLENT, VACANT, AND MOVE-IN READY
- **USE:** IDEAL FOR OFFICE OR MEDICAL PRACTICES
- **PARKING:** 40 SHARED ON-SITE SPACES ACROSS THREE BUILDINGS
- **LOCATION:** CONVENIENT, HIGHLY VISIBLE SETTING IN A WELL-MAINTAINED COMPLEX
- **FLEXIBILITY:** PERFECT FOR A VARIETY OF PROFESSIONAL OR MEDICAL TENANTS

**BUILDING****2,617 SF****LOT SIZE****39,260 SF****ZONING****C-5****PARKING****40****AVAILABLE****1,000 SF - 2,671 SF****PRICE PER SQFT****\$2.5****LEASE TERM****3-5 YEARS**



1810 E 17TH ST SANTA ANA CA 92705

EXCLUSIVE OFFERING MEMORANDUM





PROPOSED FOR PLAN

NOT AN ACTUAL FLOOR PLAN. ONLY USED FOR YOUR PREFERENCE
UNIT B IS 1,000 SF TO WHOLE BUILDING 2,671 SF

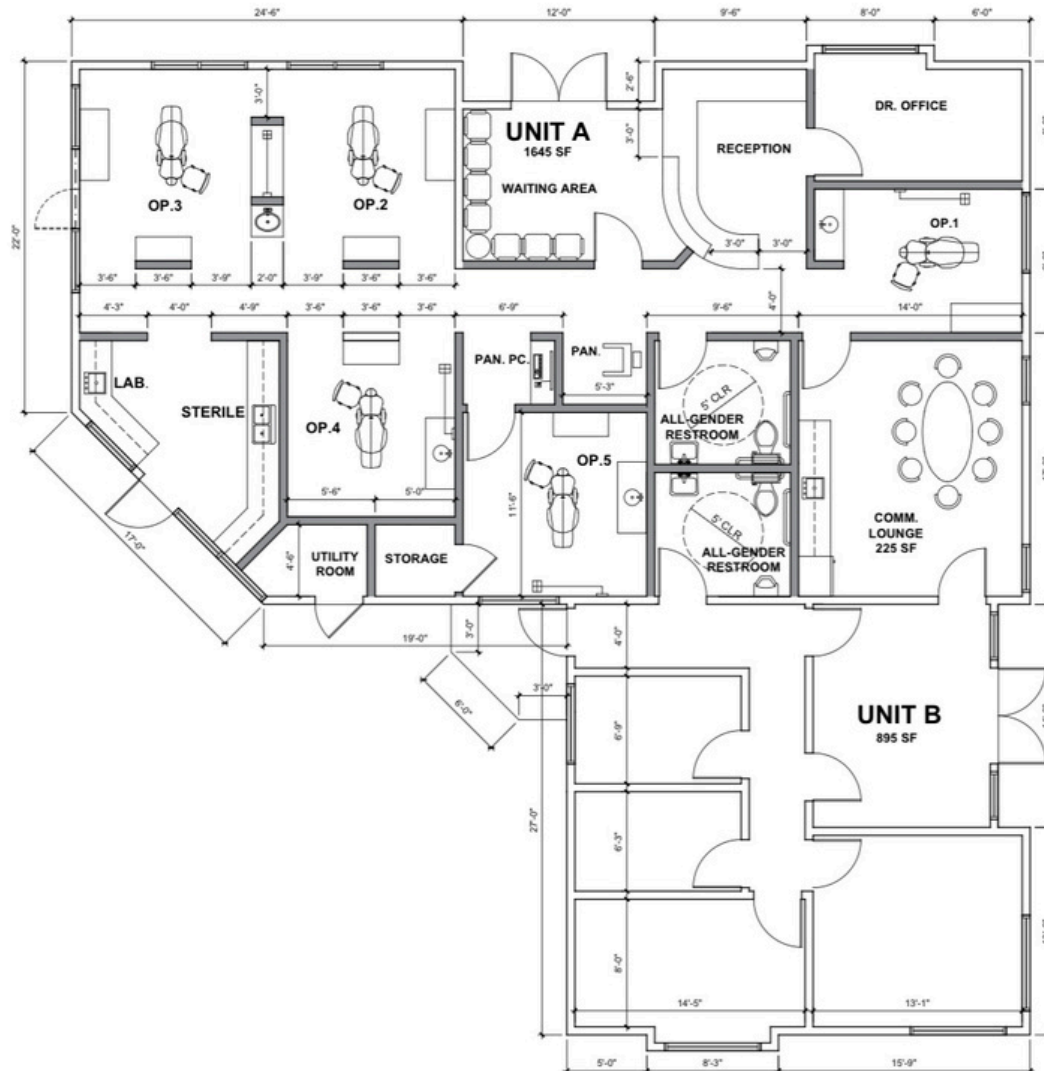

PROPOSED FLOOR PLAN
SCALE: 1/4" = 1'-0"





CONTACT



ROBERT TRAN
COMMERCIAL REAL ESTATE ADVISOR
949.780.9999
ROBERTTRANCOMMERCIAL@GMAIL.COM
DRE LICENSE 02030957