

Northgate Plaza

Route 19 North, Harmony/Zelienople, Jackson Township
Butler County, PA



PROPERTY FEATURES

- Major Tenants: Bi-Lo Foods, Rite Aid and Dollar Tree
- Just north of the rapidly growing Cranberry area along Route 19 North
- Well-established neighborhood center
- Average Daily Traffic Count: 17,300
- Property Acreage: 11.931 acres
- Total Square Footage: 98,103
- Number of Parking Spaces: 483

CONTACT

Ed Kernisky
ekernisky@unionreal.com

Joe Hodson
jbhodson@unionreal.com

www.unionreal.com | 412-288-7800



COMPANY OF PITTSBURGH

429 Forbes Avenue, Suite 1500, Allegheny Building, Pittsburgh, PA 15219

LEASING | PROPERTY MANAGEMENT | BROKERAGE SERVICES | THIRD-PARTY MANAGEMENT | TENANT REPRESENTATION

NORTHGATE PLAZA

Route 19 North, Harmony/Zelienople,
Jackson Township, Butler County, PA



TOTAL AREA
519,733.71 S.F.
11,931 ACRES

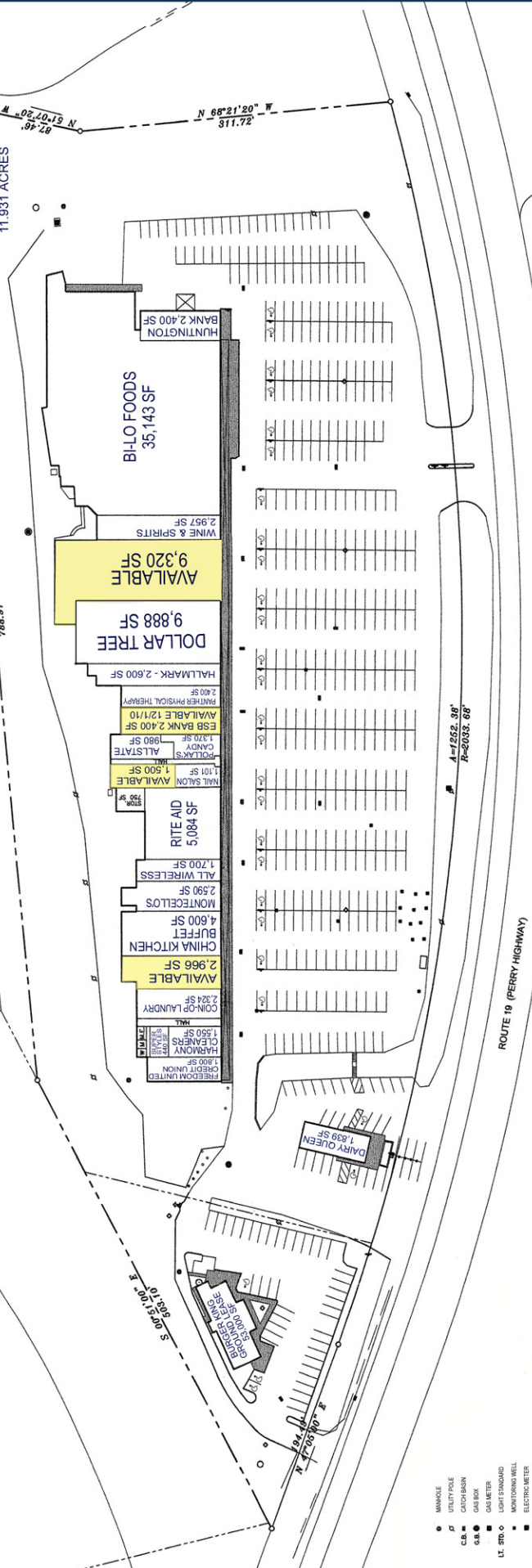

- MANHOLE
- UTILITY POLE
- CATCH BASIN
- GAS BOX
- GAS METER
- LIGHT STANDARD
- MONITORING WELL
- ELECTRIC METER
- WATER BOX

ROUTE 19 (PERRY HIGHWAY)



412-288-7800 | www.unionreal.com

Northgate Plaza

Route 19 North, Harmony/Zelenople, Jackson Township
Butler County, PA

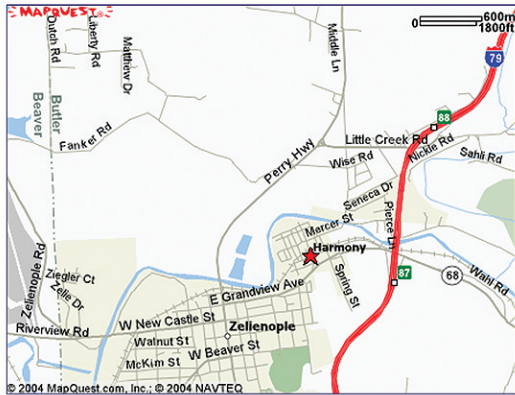

Demographic Quick Facts

Average Household Income:

3 mi. radius: \$64,688

5 mi. radius: \$70,159



CONTACT

Ed Kernisky
ekernisky@unionreal.com

Joe Hodson
jbhodson@unionreal.com

www.unionreal.com | 412-288-7800



COMPANY OF PITTSBURGH

429 Forbes Avenue, Suite 1500, Allegheny Building, Pittsburgh, PA 15219

LEASING | PROPERTY MANAGEMENT | BROKERAGE SERVICES | THIRD-PARTY MANAGEMENT | TENANT REPRESENTATION