

CALIFORNIA PLAZA

2121 NORTH CALIFORNIA BOULEVARD
WALNUT CREEK, CA 94596



Suite 800 | 7,310 Rentable Square Feet

LONG TERM SUBLEASE - AVAILABLE IMMEDIATELY

NEWMARK

RICH HOYT
925.460.9292 | RHOYT@NGKF.COM
CA RE LICENSE # #01470213

DANIEL PIVNICK
510.923.9150 | DPIVNICK@NGKF.COM
CA RE LICENSE # #01481078



THE PROPERTY

Class

A+

Location

Walnut Creek, CA (Bay Area)

Sustainability

LEED® Silver Certification, ENERGY STAR® Rating

On-Site Amenities

State-of-the-art Fitness Center

Murphy's Deli

Valet parking

Fedex/UPS drop-off

The Hub Conference Center

Outdoor Plaza

Full-time Amenity Center Manager

CLICK HERE FOR 360° VIRTUAL TOUR

THE SPACE

Size

7,310 Rentable Square Feet

Long Term Sublease

Available Immediately

Lease Expiration Date

10/31/2025

Address

2121 North California Boulevard, Suite 800
Walnut Creek, CA

Specs

Brand new office improvements and furniture

Mount Diablo Views

Open ceilings, collaborative work space, with
cafeteria style kitchen

Amazing natural light

Sit/stand furniture with dual monitors built in

CAT 6 wiring

Server room with dedicated HVAC system



HIGHLIGHTS

NEWMARK

RICH HOYT
925.460.9292 | RHOYT@NGKF.COM
CA RE LICENSE # #01470213

DANIEL PIVNICK
510.923.9150 | DPIVNICK@NGKF.COM
CA RE LICENSE # #01481078



THE SPACE



NEWMARK

RICH HOYT
925.460.9292 | RHOYT@NGKF.COM
 CA RE LICENSE # #01470213

DANIEL PIVNICK
510.923.9150 | DPIVNICK@NGKF.COM
 CA RE LICENSE # #01481078

FLOOR PLAN

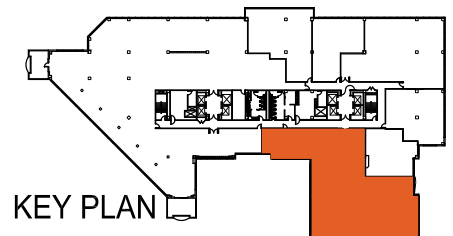

NEWMARK

RICH HOYT
925.460.9292 | RHOYT@NGKF.COM
 CA RE LICENSE # #01470213

DANIEL PIVNICK
510.923.9150 | DPIVNICK@NGKF.COM
CA RE LICENSE # #01481078

CALIFORNIA PLAZA

2121 NORTH CALIFORNIA BOULEVARD
WALNUT CREEK, CA 94596

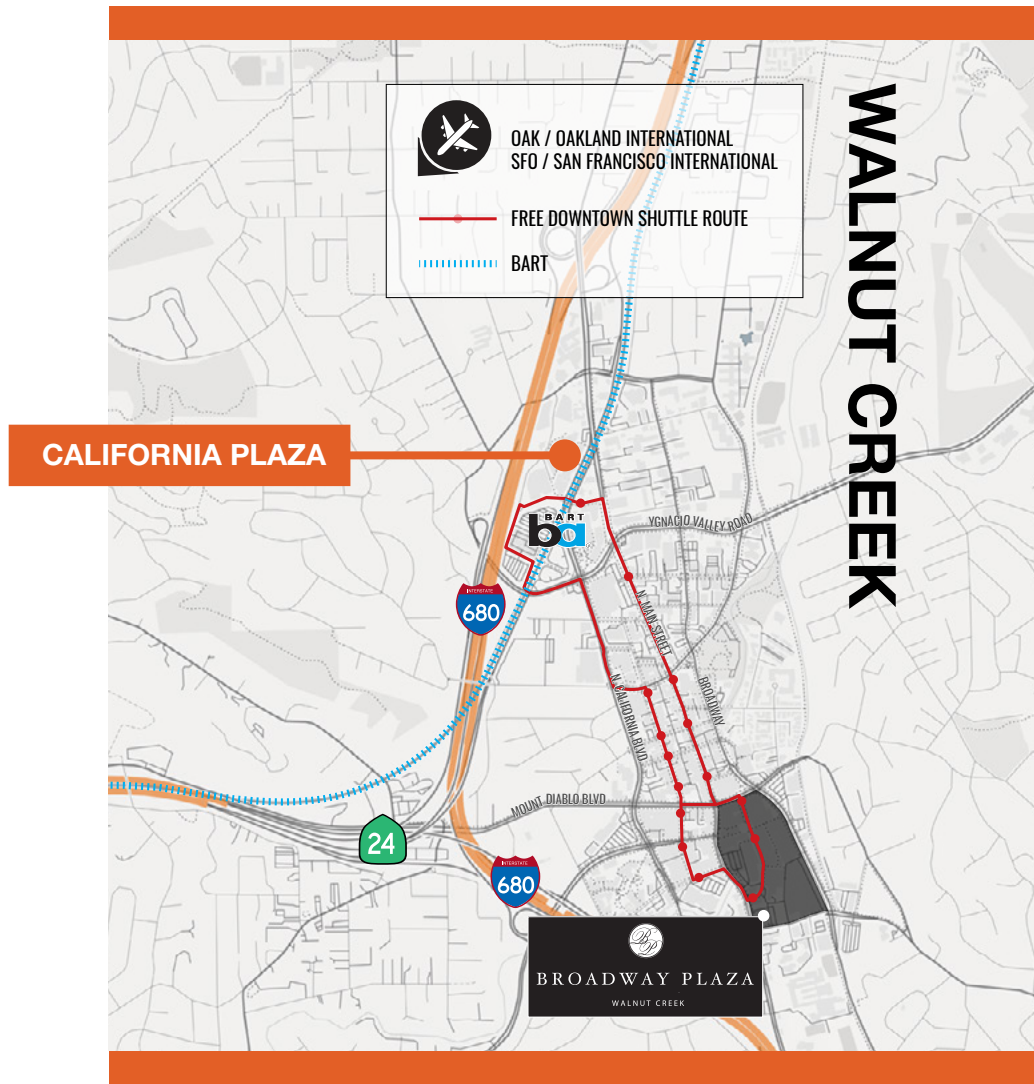

Suite 800 | 7,310 Rentable Square Feet

LONG TERM SUBLEASE - AVAILABLE IMMEDIATELY

The distributor of this communication is performing acts for which a real estate license is required. The information contained herein has been obtained from sources deemed reliable but has not been verified and no guarantee, warranty or representation, either express or implied, is made with respect to such information. Terms of sale or lease and availability are subject to change or withdrawal without notice.

NEWMARK

RICH HOYT
925.460.9292 | RHOYT@NGKF.COM
CA RE LICENSE # #01470213

DANIEL PIVNICK
510.923.9150 | DPIVNICK@NGKF.COM
CA RE LICENSE # #01481078