

INDUSTRIAL FOR LEASE

1120 Delaware Avenue | Longmont, Colorado

Central Longmont industrial / flex space for lease. This clean, freestanding building provides 14' clear height, three drive-in bays and 20 parking spaces.

Enjoy a nice setting in a great central Longmont location, ample power and plenty for parking.

To set up a showing:

MARTY MCELWAIN
HEREWEGO, LLC
Owner | Manager

303.328.5791
martymac04@hotmail.com

LEASING CONTACT: MARTY MCELWAIN
martymac04@hotmail.com
303.328.5791



DETAILS

INDUSTRIAL FOR LEASE

1120 Delaware Avenue | Longmont, Colorado

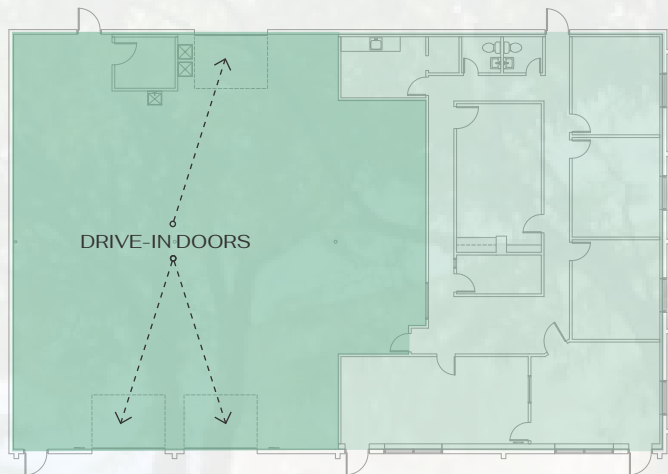

WAREHOUSE AREA
OFFICE AREA

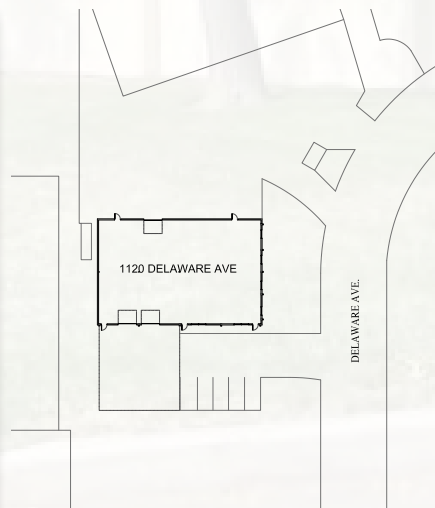

SIZE
5,220 SF



RENT
\$13 NNN



AVAILABLE
Immediately



EST. OP EX
\$2.76 / SF (+ utilities
& taxes)



LOADING
3 drive-in doors



CLEAR HEIGHT
14'



LEASING CONTACT: **MARTY MCELWAIN**
martymac04@hotmail.com
303.328.5791