



Prime Retail Site Connecticut Ave Norwalk, CT 4,400 SF

Property Highlights

- Brand-new, free-standing building fronting Connecticut Avenue
- Adjacent to the new Wegmans
- 4,400 SF of ground-floor retail space
- Excellent branding opportunity with prominent street signage on a heavily trafficked road
- Sublease from Hartford HealthCare thru March 2037
- 21,500 average daily traffic count

Get more information: **Judd McArthur**
Senior Vice President
o 203 614 1719 | m 203 394 3634
judd.mcarthur@avisonyoung.com

383 Main Ave, 6th Floor | Norwalk, CT | 203 614 1260 | avisonyoung.com

© 2026 Avison Young – New York, LLC. Information contained herein was obtained from sources deemed reliable and, while thought to be correct, have not been verified. Avison Young does not guarantee the accuracy or completeness of the information presented, nor assumes any responsibility or liability for any errors or omissions therein.

Floor Plan

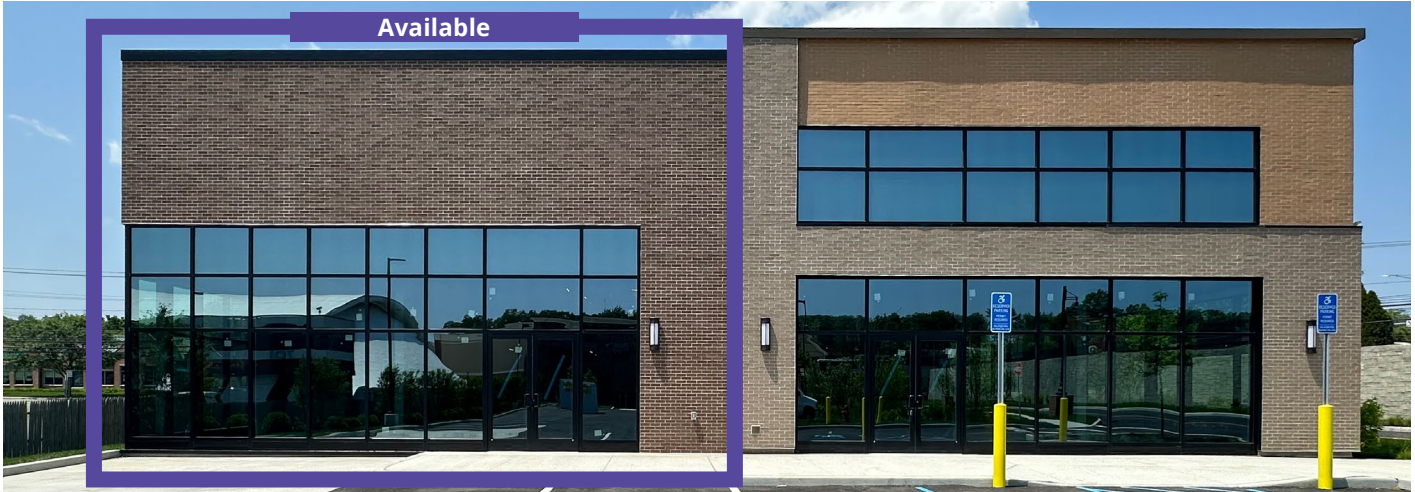
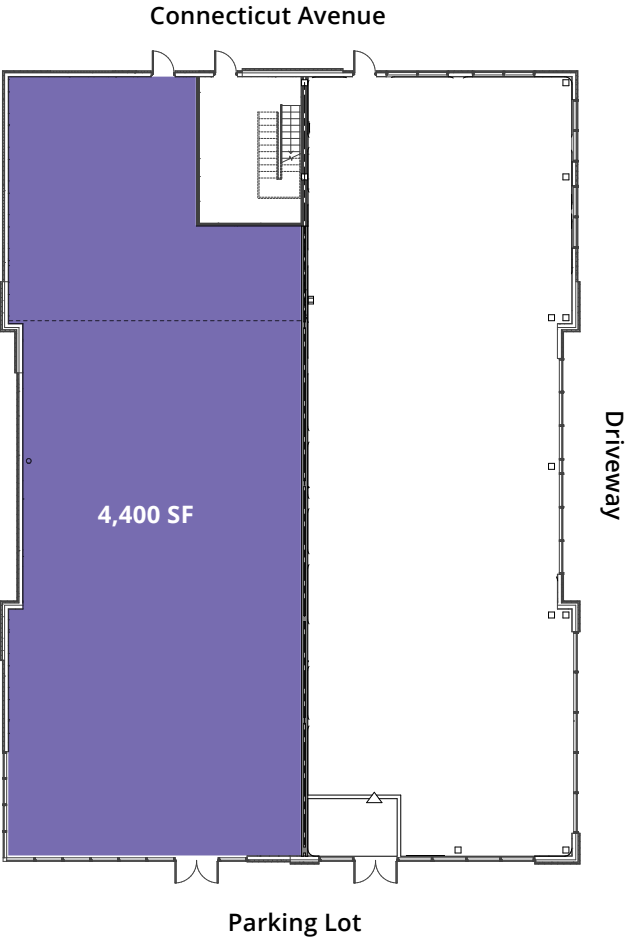

Get more information: **Judd McArthur**
D. 203 614 1719 | M. 203 394 3634
judd.mcarthur@avisonyoung.com

**AVISON
YOUNG**

Site Plan

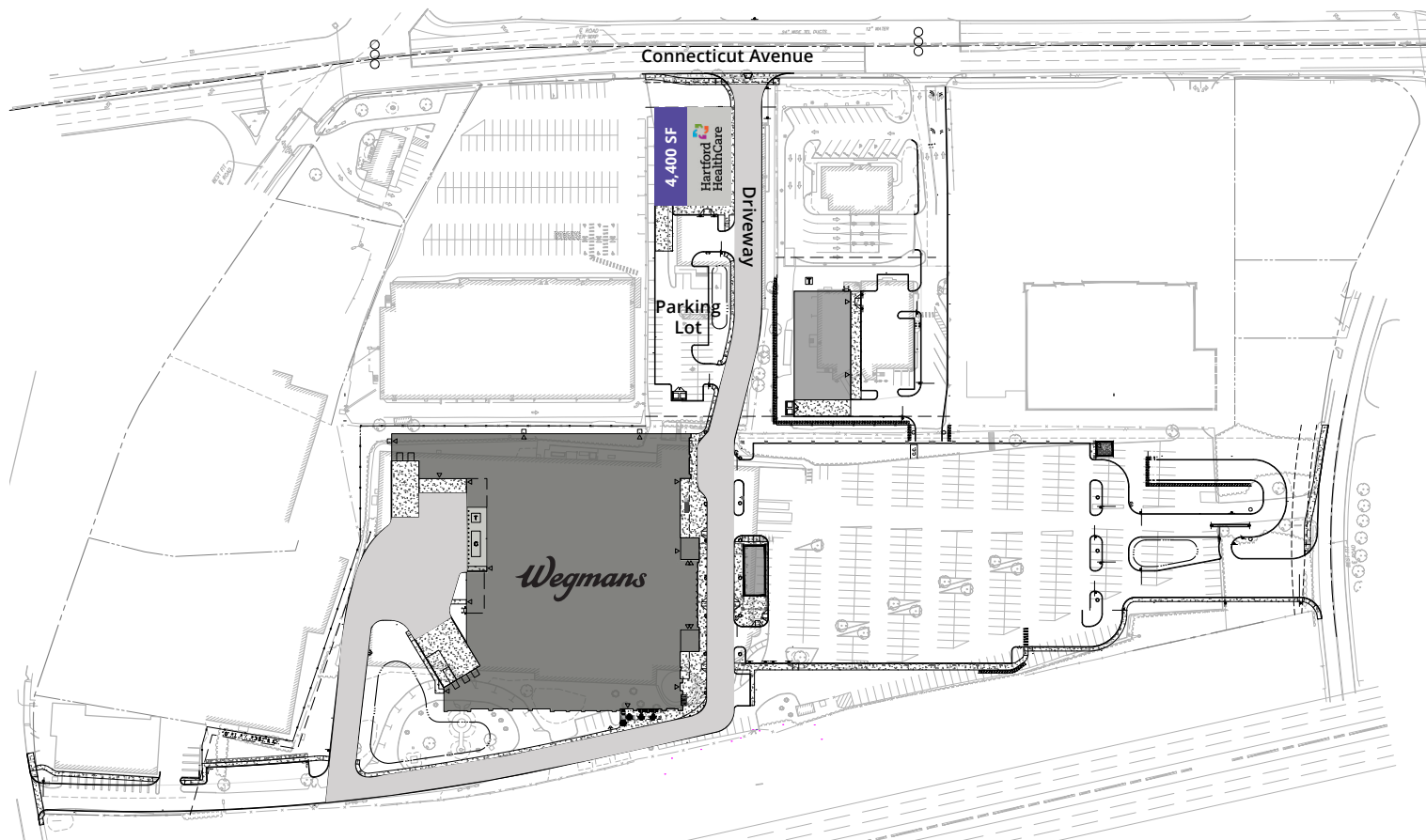

Get more information: **Judd McArthur**
D. 203 614 1719 | M. 203 394 3634
judd.mcarthur@avisonyoung.com

**AVISON
YOUNG**

Retail Map and Demographics



Get more information: Judd McArthur
D. 203 614 1719 | M. 203 394 3634
judd.mcarthur@avisonyoung.com

