



Available Trailer Yard with 109 Positions on ±4.08 Acres

920 Performance Drive

Stockton, CA 95206 | Airport Gateway Center

Mike Goldstein, SIOR
Executive Managing Director
CA License No. 01319234
michael.goldstein@colliers.com
+1 209 475 5106

Ryan McShane, SIOR
Executive Vice President
CA License No. 01295796
ryan.mcshane@colliers.com
+1 209 475 5105

Alex Hoeck, SIOR
Senior Vice President
CA License No. 01943853
alex.hoeck@colliers.com
+1 209 475 5107

Gregory O'Leary, SIOR
Executive Vice President
CA License No. 00924479
g.oleary@colliers.com
+1 209 475 5108



PANATTONI®



Accelerating success.

920 Performance Drive

Stockton, CA 95206 | Airport Gateway Center

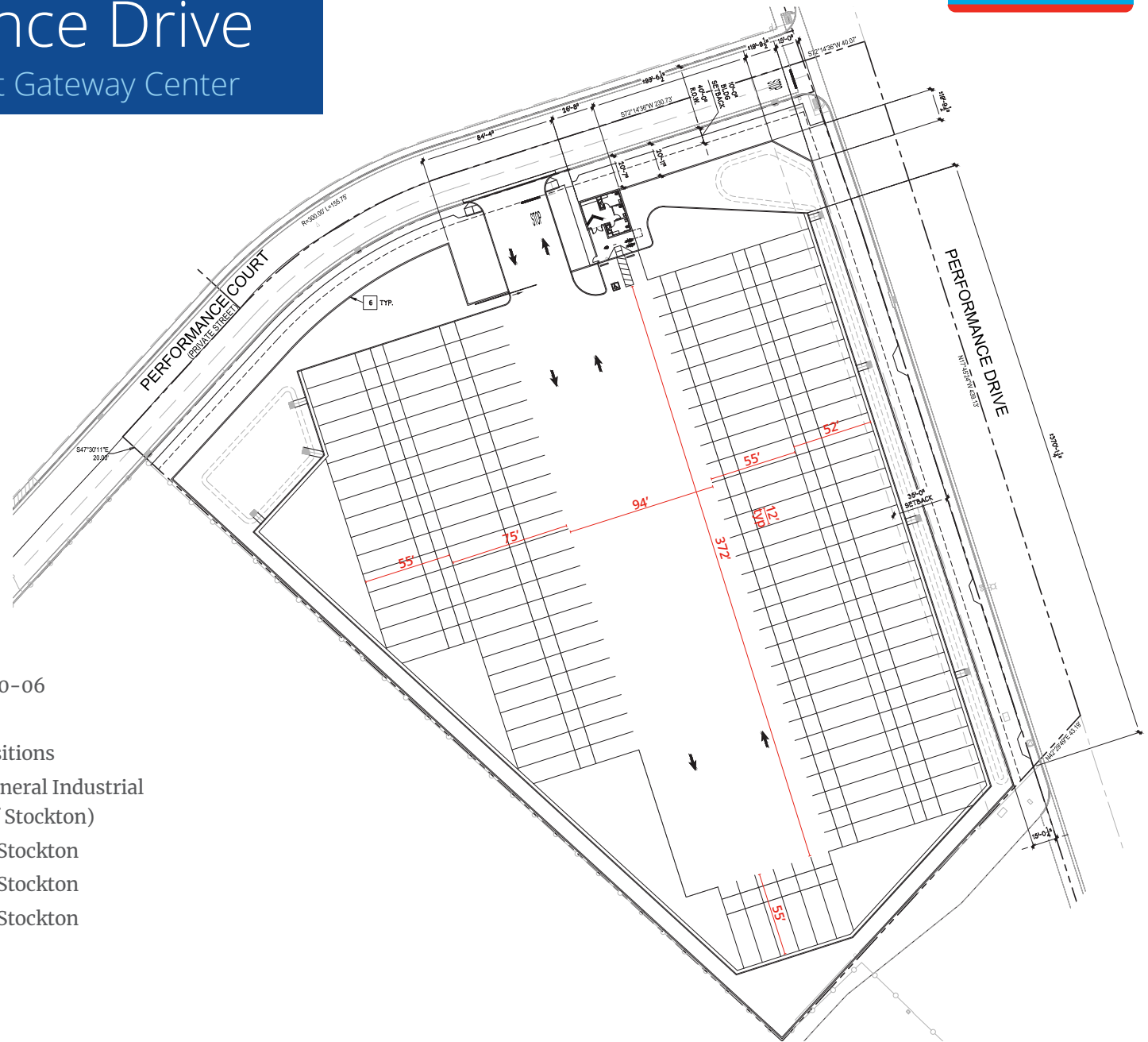

- ACRES:** ±4.08
- APN:** 177-450-06
- AUTO PARKING:** 2 stalls
- TRAILER PARKING:** 109 positions
- ZONING:** I-G, General Industrial (City of Stockton)
- SEWER:** City of Stockton
- WATER:** City of Stockton
- STORM:** City of Stockton
- GAS & ELECTRIC:** PG&E
- Shower/Restroom Facility
- Fenced, paved & lit

SITE PLAN

920 Performance Drive

Stockton, CA 95206 | Airport Gateway Center

Colliers

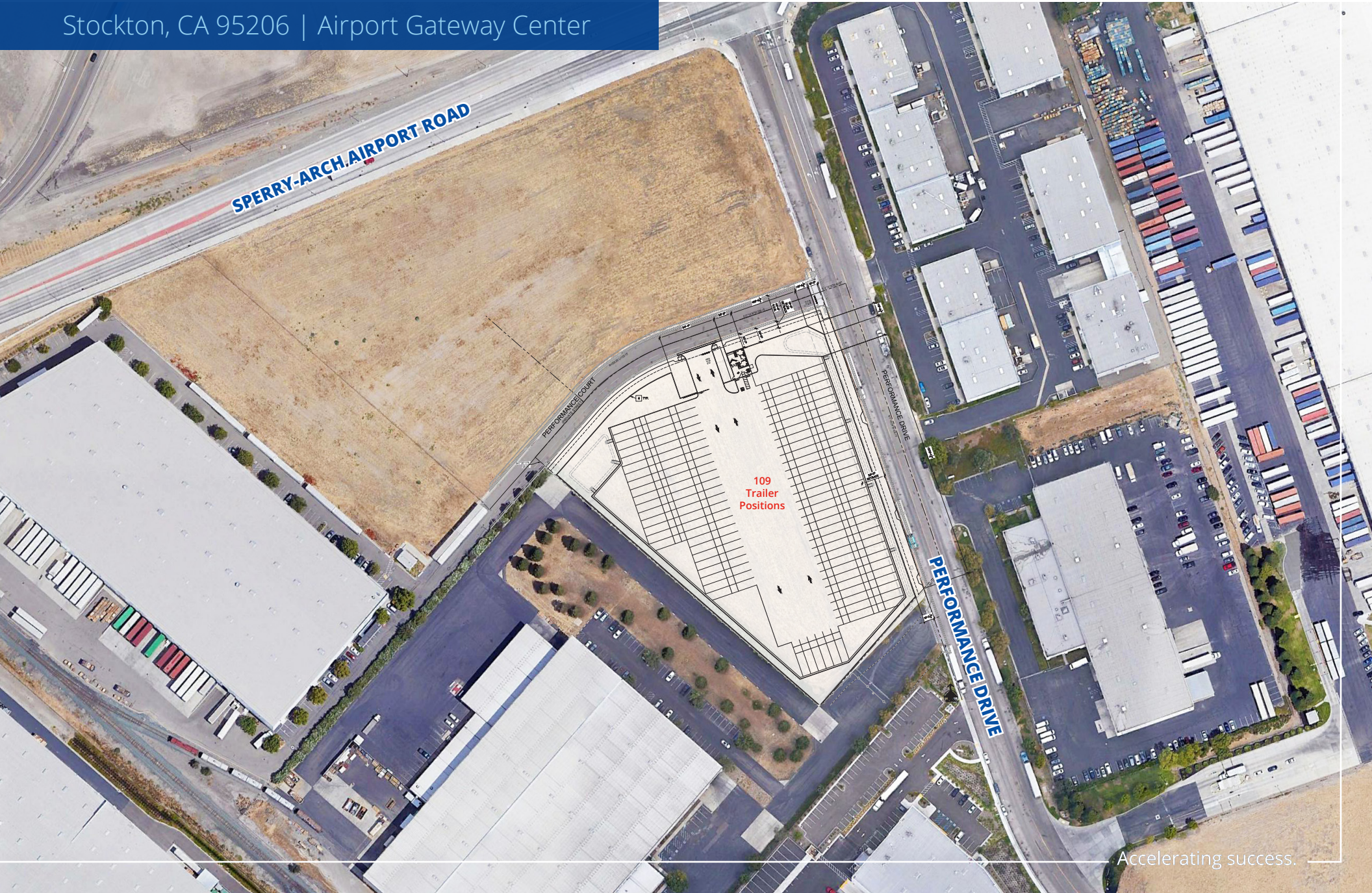

LOCATION AERIAL

Colliers

920 Performance Drive

Stockton, CA 95206 | Airport Gateway Center



+/-1.4 miles to I-5

SUBJECT PROPERTY

SEM STOCKTON METROPOLITAN AIRPORT

+/-2.5 miles to Hwy 99



920 Performance Drive

Stockton, CA 95206 | Airport Gateway Center

CITIES

SACRAMENTO	53 miles
OAKLAND	72 miles
SAN JOSE	76 miles
SAN FRANCISCO	84 miles
FRESNO	120 miles
RENO	181 miles
LOS ANGELES	337 miles
LAS VEGAS	513 miles
PORTLAND	635 miles
SALT LAKE CITY	699 miles
SEATTLE	807 miles
DENVER	1,152 miles

PORTS

STOCKTON	10 miles
WEST SACRAMENTO	58 miles
OAKLAND	72 miles
SAN FRANCISCO	88 miles
LA/LONG BEACH	361 miles
SEATTLE	802 miles

AIRPORTS

STOCKTON METRO	1 miles
SACRAMENTO INT'L	63 miles
OAKLAND INT'L	67 miles
SAN JOSE INT'L	72 miles
SAN FRANCISCO INT'L	85 miles

INTERMODAL

UP (LATHROP)	4 miles
BNSF (STOCKTON)	5 miles

