

Suite C

Standard Features
Workstations for up to 49
Office/Huddle Rooms
Kitchenette
Branding & Signage
Accessories Package
AV, Data, and Power
Optional Features
Prep Counter, Refrigerator, Microwave
Phone Booths
Soft Seating
Communal Work/Cafe Seating
Decor (Art & Greenery)
Carpeting
Sound Masking System

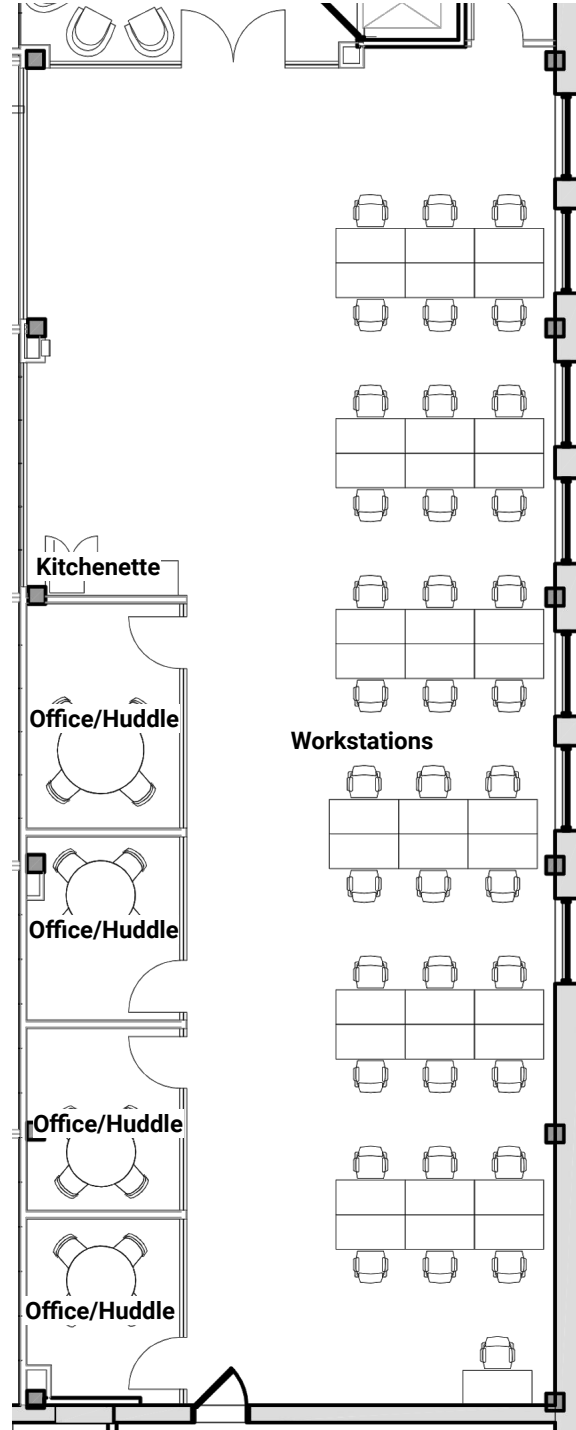

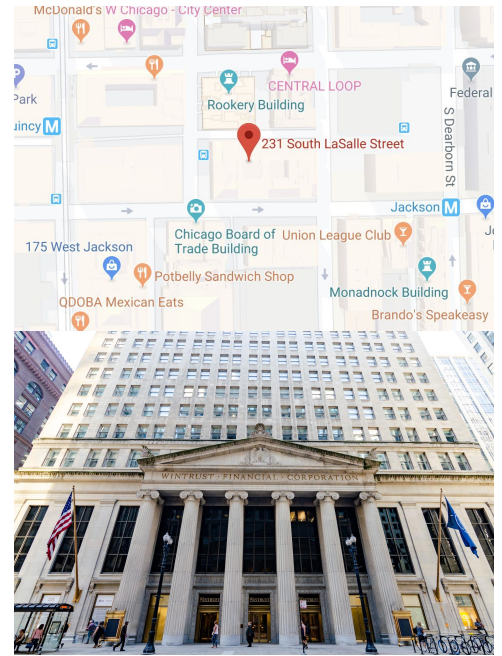

Opening Date - September 2019

Neighborhood

- Ideally located in the The Loop — a vibrant area featuring eclectic eateries, shops, theaters, and parks
- The Loop is the second largest commercial business district in the United States
- Comprised mostly of high-rises, it's also home to the 108-story Willis Tower



Building Amenities

- 7,000 square foot state of the art fitness center
- Rooftop deck with views of the Chicago skyline
- Secured bike room
- Starbucks on-site
- Conference Center and tenant lounge



Transportation

- Short walk from major commuter train & several CTA elevated rail stations
- Direct access to five different CTA lines & numerous bus stops