

257 Park Avenue South

New York, NY 10010

23RD STREET	SPIN Starbucks Bath & Body Works CVS pharmacy	Vantage Strategic CLEANERS DOS TOROS EUROPEAN WAX CENTER
22ND STREET	Morton Williams NEW YORK HEALTH & RACQUET CLUB	FOTOGRAFISKA MUSEUM ST. GEORGES CHURCH
21ST STREET	NEMO BLOOMING NAILS & SPA THE SHADE STORE	BRAVO PIZZA BLUE BOTTLE COFFEE 257 Herman Miller
20TH STREET	GRAMMERCY TAVERN BARBOUNIA ligne roset Starbucks Bank of America	L'EXPRESS ISABELLE'S OSTERIA MOMO SUSHI UNION SQUARE CAFE
19TH STREET	CHASE	BOUCHERIE FLUSHING Bank
18TH STREET	ROTHMAN'S CLOTHING SALTBAE SEPHORA THE RED DOOR	CVS pharmacy FRAICHE MAXX IRVINGTON BAR & RESTAURANT
17TH STREET		



At 21st Street

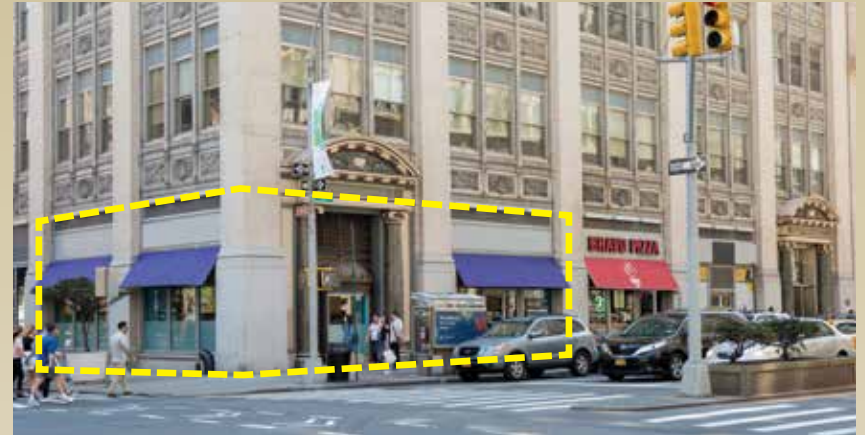

Prime Corner Retail Space in Midtown South Up to 3,807 SF Available (Former FedEx Office)

Ground Floor 3,457 SF
 Mezzanine 350 SF
 Lower Level Also Available

Possession: Immediate
Rent: Upon Request

- Join Blue Bottle Coffee and Bravo Pizza
- Near Gramercy, Madison, and Union Square Parks, as well as the Union Square Greenmarket
- Subway transportation **N Q R L 4 5 6**



THE FEIL ORGANIZATION

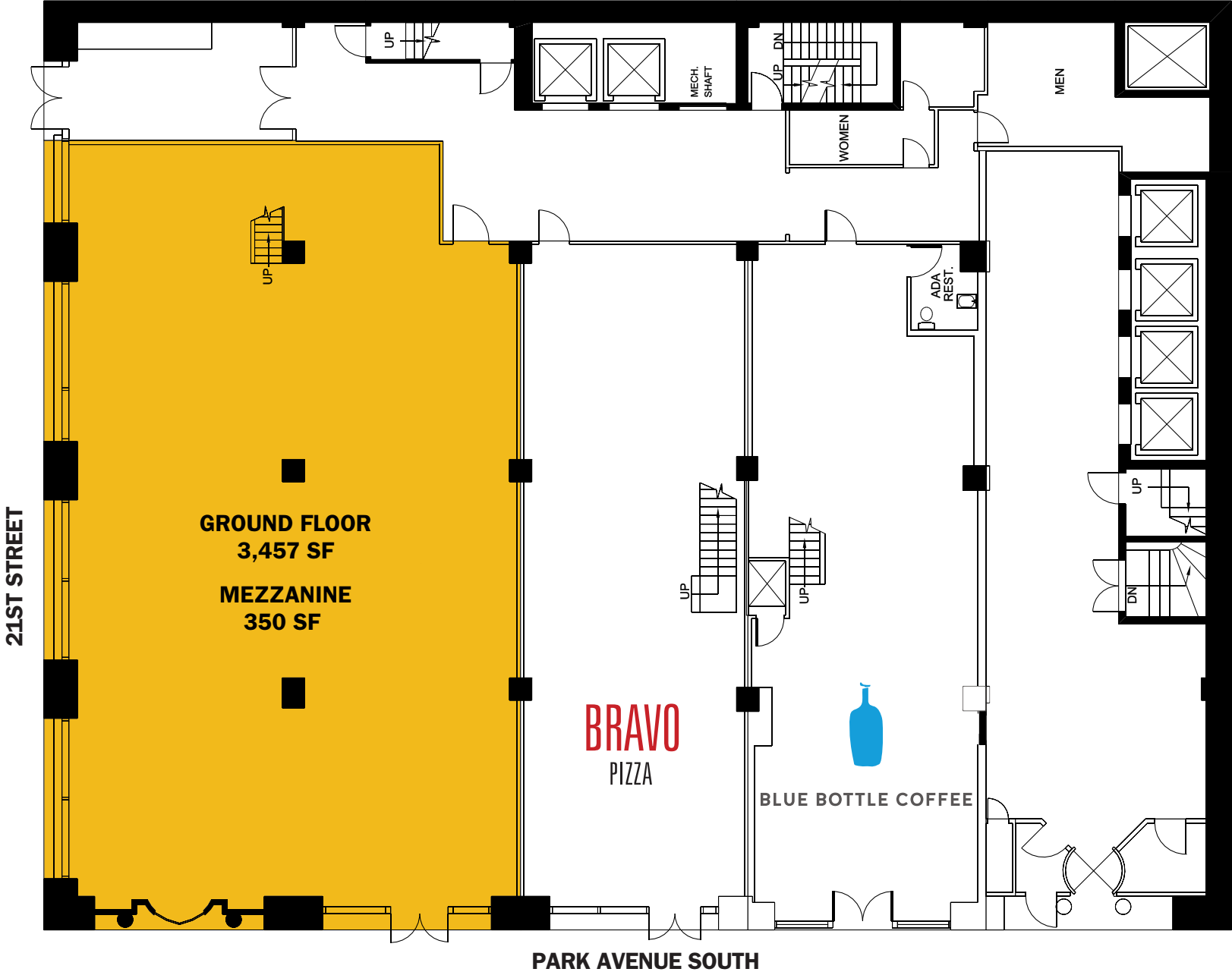

For leasing information, please contact Randall Briskin 212 609 8618 | rbriskin@feilorg.com or Nicholas Dries 212 609 8687 | ndries@feilorg.com

THE FEIL ORGANIZATION 7 Penn Plaza, New York, NY 10001 T 212 279 7600 www.feilorg.com