



## PRE-LEASING MONROE'S CROSSING PHASE 3

### LEASE OVERVIEW

**AVAILABLE** | 1230, 1222, 1218, 1214

**END CAP PRICE** | \$24 PER SF

**IN-LINE UNIT PRICE** | \$22 PER SF

**SQUARE FEET** | 1,500 - 4,500 +/- SF

**LEASE TYPE** | NNN

**ZONING** | HIGHWAY C

UNDER CONSTRUCTION! Great potential for retail or office space on Fayetteville Rd/401, the main corridor between Fayetteville and Raeford. Monroe's Crossing Phase 3 has 1,500 - 4,500 +/- square feet of remaining space available. Location allows for great signage and visibility. Ample Parking. Do not miss this opportunity! Terms negotiable. Tenant is responsible for their proportionate share of taxes, insurance, and common area maintenance, plus all utilities for their unit.

**GEORGE MANLEY**  
NC BROKER  
C: 910.603.8395  
GEORGE@CSGNC.COM

CAROLINA SUMMIT GROUP  
235 E Pennsylvania Ave.  
Southern Pines, NC 28387  
910.684.5353  
carolinasummitgroup.com

**LARRY BERGIN**  
NC BROKER  
C: 910.633.7215  
LARRY@CSGNC.COM

**AERIAL**



**GEORGE MANLEY**  
 NC BROKER  
 C: 910.603.8395  
 GEORGE@CSGNC.COM

**CAROLINA SUMMIT GROUP**  
 235 E Pennsylvania Ave.  
 Southern Pines, NC 28387  
 910.684.5353  
 carolinasummitgroup.com

**LARRY BERGIN**  
 NC BROKER  
 C: 910.633.7215  
 LARRY@CSGNC.COM

**SITE PLAN**

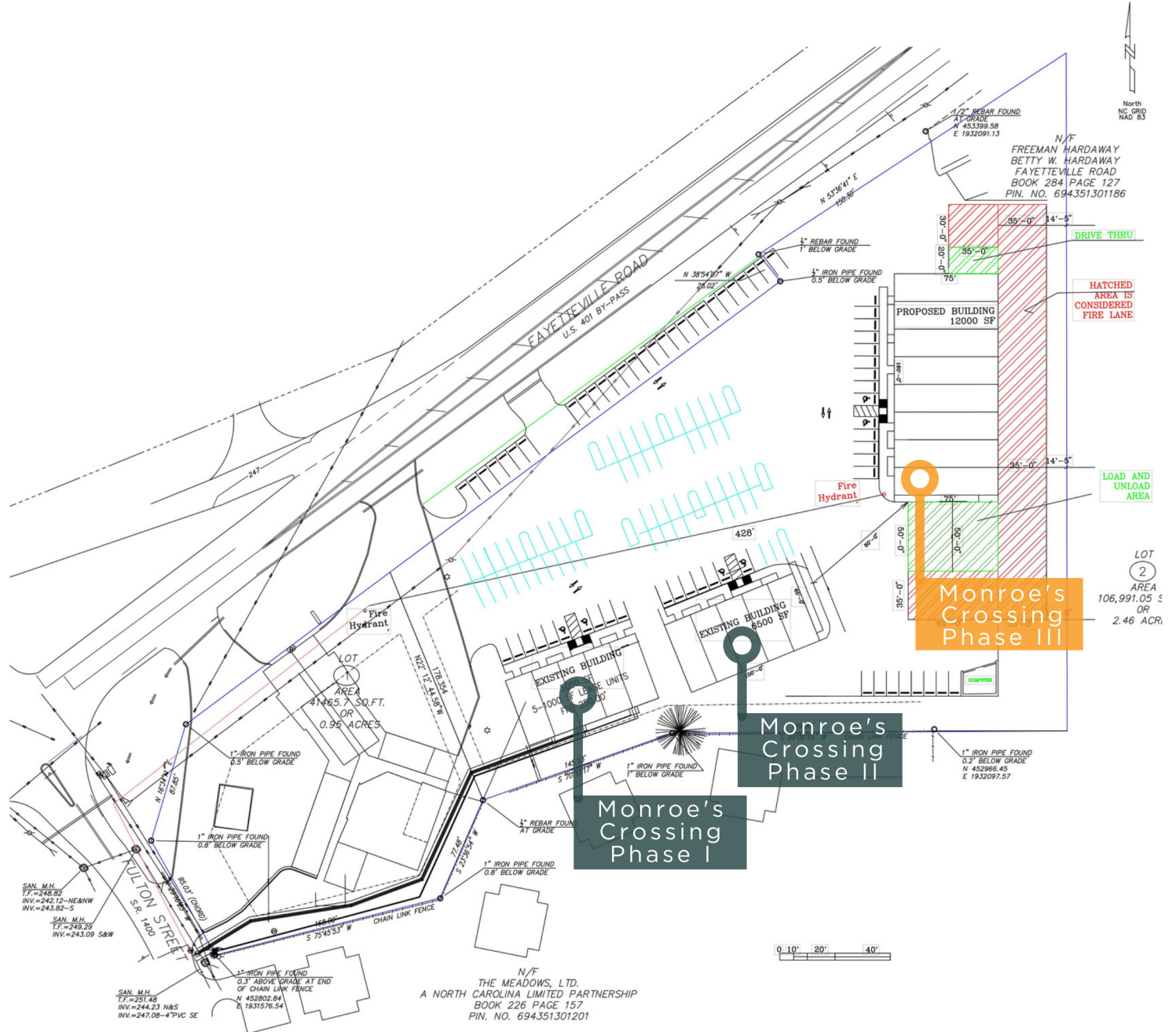

NOTE: Site Plan is for illustrative purposes only.  
Actual dimensions & details may vary.

**GEORGE MANLEY**  
NC BROKER  
C: 910.603.8395  
GEORGE@CSGNC.COM

**CAROLINA SUMMIT GROUP**  
235 E Pennsylvania Ave.  
Southern Pines, NC 28387  
910.684.5353  
carolinasummitgroup.com

**LARRY BERGIN**  
NC BROKER  
C: 910.633.7215  
LARRY@CSGNC.COM