

175 LENNON LANE

WALNUT CREEK | CALIFORNIA



SUITES AVAILABLE:

- GROUND FLOOR (SUITE 100): ±14,865 SF
- SUITE 200: ±2,583 SF

JOHN FENNEL

Managing Director
+1 925-274-2802

John.Fennell@cushwake.com

CA LICENSE # 00902673

SUITE 100

THE ENTIRE GROUND FLOOR:

Suite 100:

- ±14,865 SF
- Nice, open plan
- Great window line
- Renovated mens and womens restrooms
- Lunch Room
- IT Room

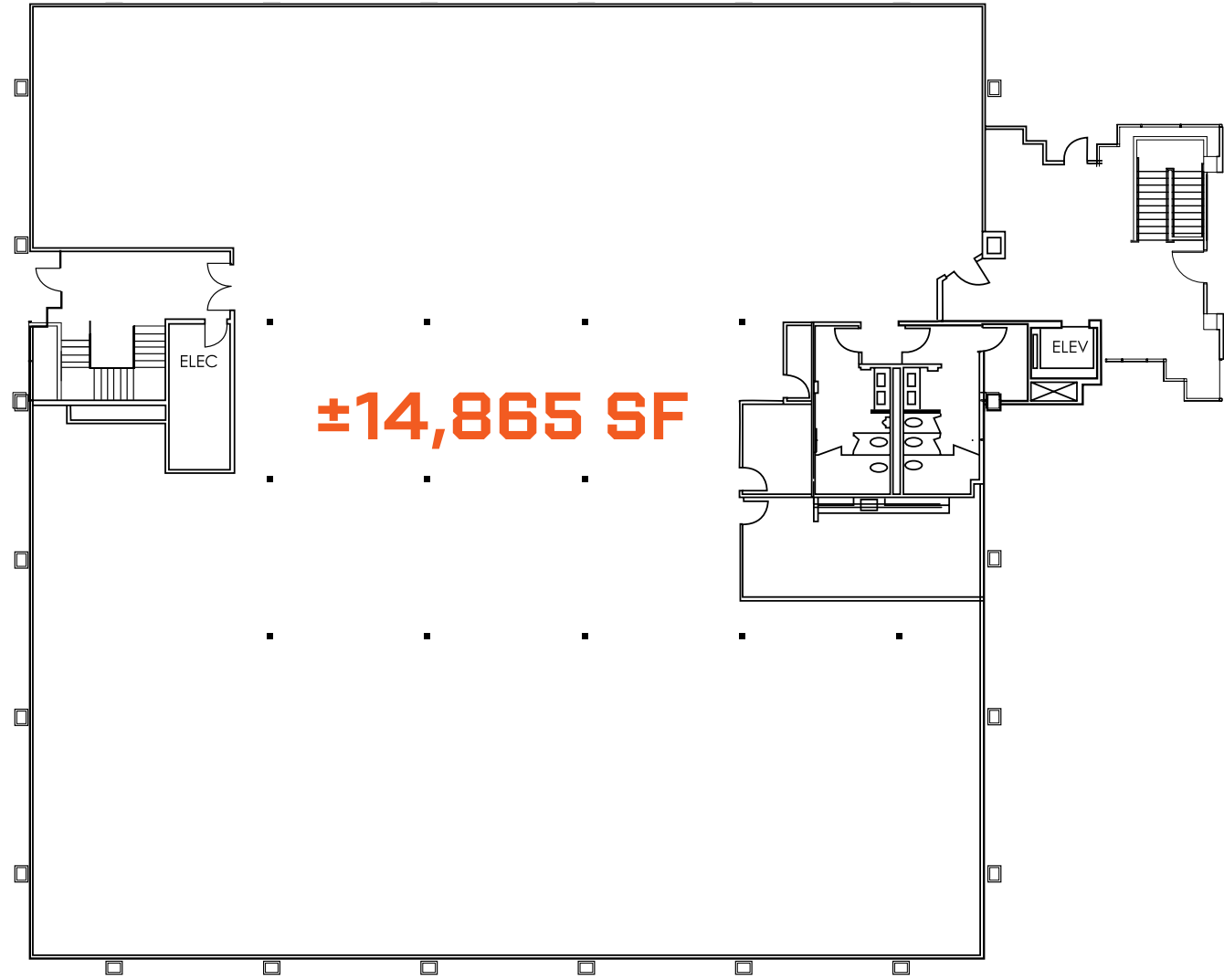

±14,865 SF

SUITE 200

THE 2ND FLOOR:

Suite 200

- ±2,583 SF
- Open plan conference room

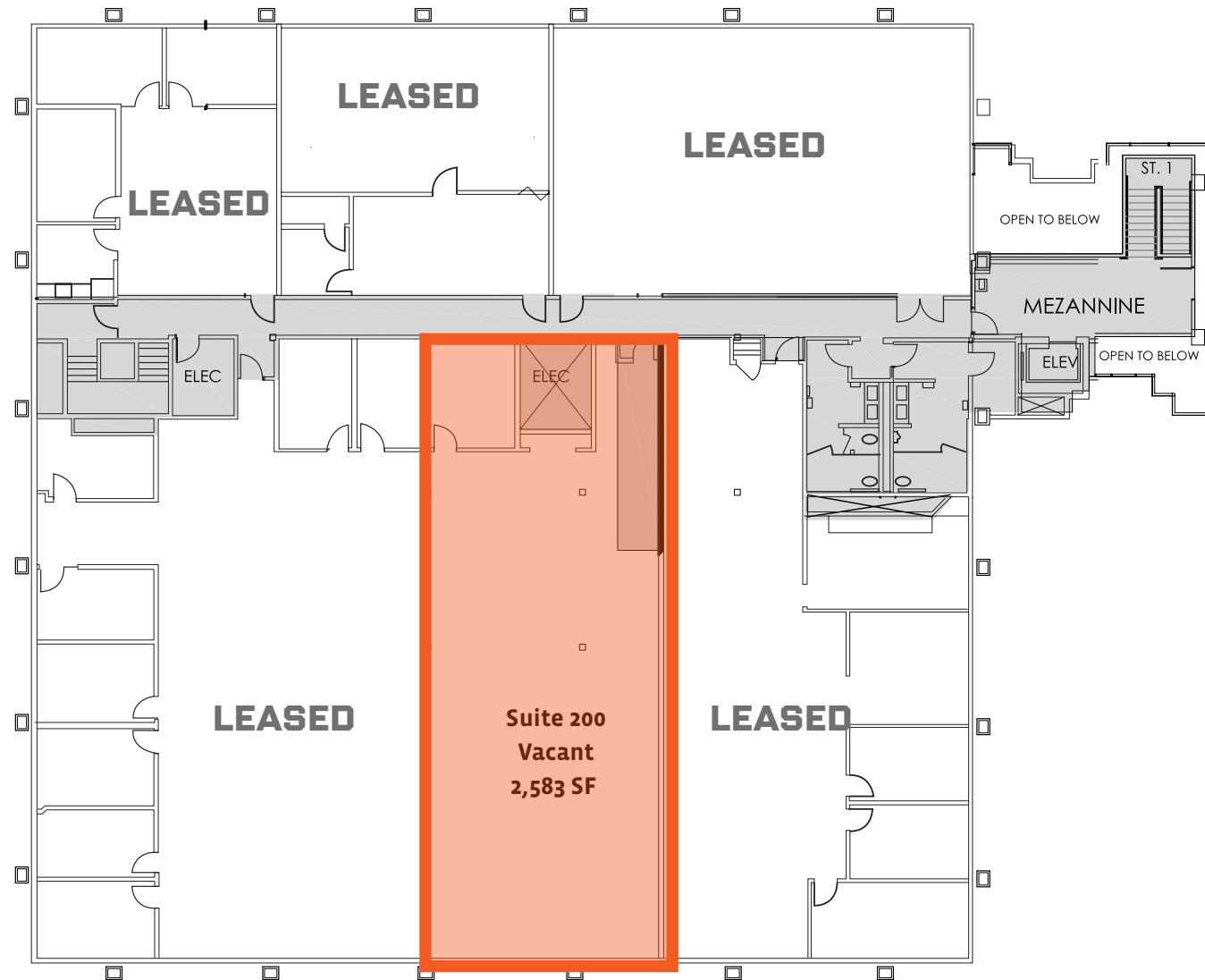

LOCATION MAP

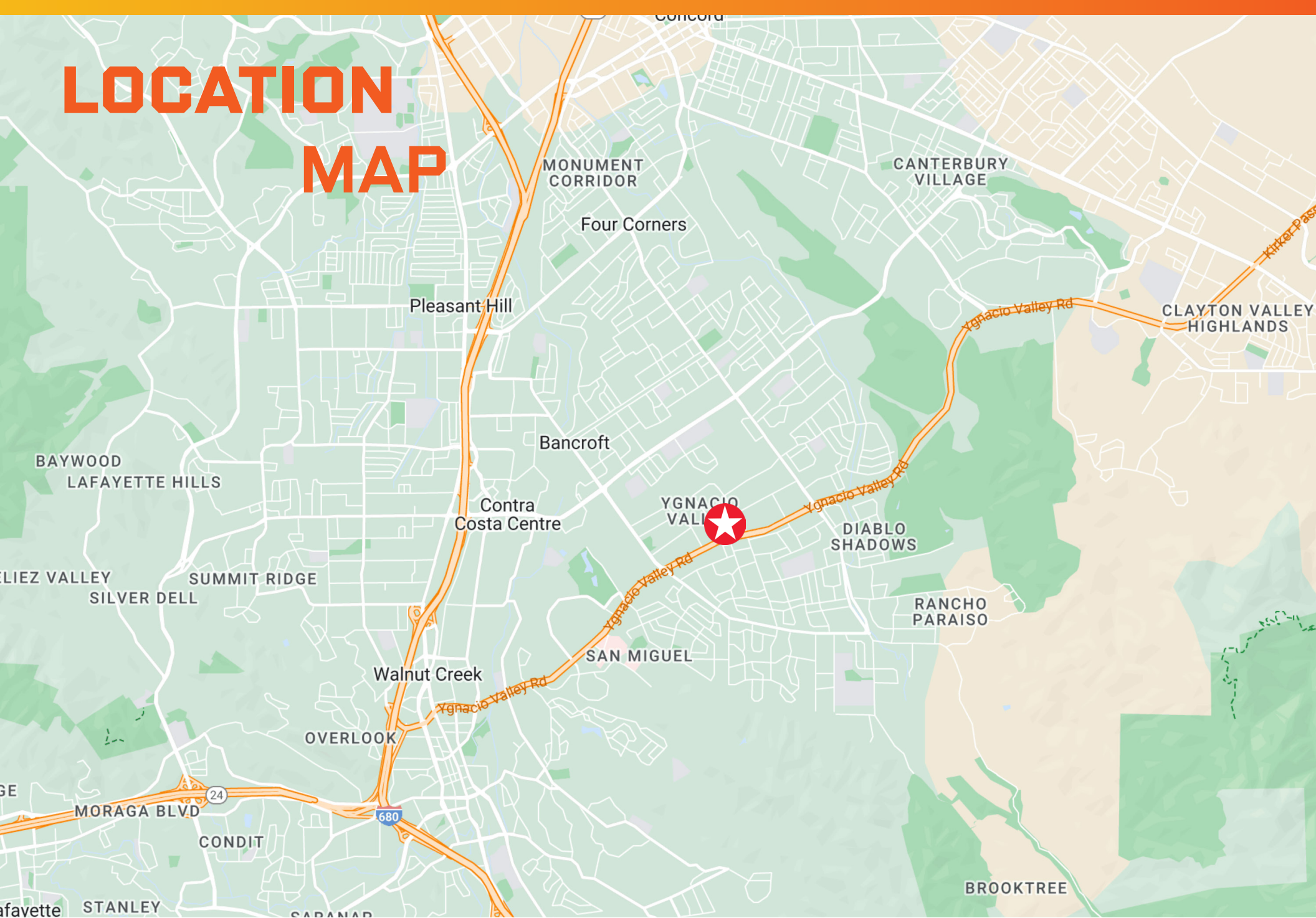

AMENITIES MAP



































www.sportsbasement.com

175 LENNON LANE
 WALNUT CREEK | CALIFORNIA

©2023 Cushman & Wakefield. All rights reserved. The information contained in this communication is strictly confidential. This information has been obtained from sources believed to be reliable but has not been verified. NO WARRANTY OR REPRESENTATION, EXPRESS OR IMPLIED, IS MADE AS TO THE CONDITION OF THE PROPERTY (OR PROPERTIES) REFERENCED HEREIN OR AS TO THE ACCURACY OR COMPLETENESS OF THE INFORMATION CONTAINED HEREIN, AND SAME IS SUBMITTED SUBJECT TO ERRORS, OMISSIONS, CHANGE OF PRICE, RENTAL OR OTHER CONDITIONS, WITHDRAWAL WITHOUT NOTICE, AND TO ANY SPECIAL LISTING CONDITIONS IMPOSED BY THE PROPERTY OWNER(S). ANY PROJECTIONS, OPINIONS OR ESTIMATES ARE SUBJECT TO UNCERTAINTY AND DO NOT SIGNIFY CURRENT OR FUTURE PROPERTY PERFORMANCE.