

# AME TELGE *BUSINESS PARK*

Tomball, Texas | Northwest Harris County

**±5,000 - ±11,000 SF OF SPEC WAREHOUSE SPACE AVAILABLE FOR SALE OR LEASE**



**CBRE**

# Development Details

April 2024 Completion

LEASE RATE: \$0.97 PER FOOT / \$0.27 OPEX

SALE PRICE: CALL BROKER FOR DETAILS

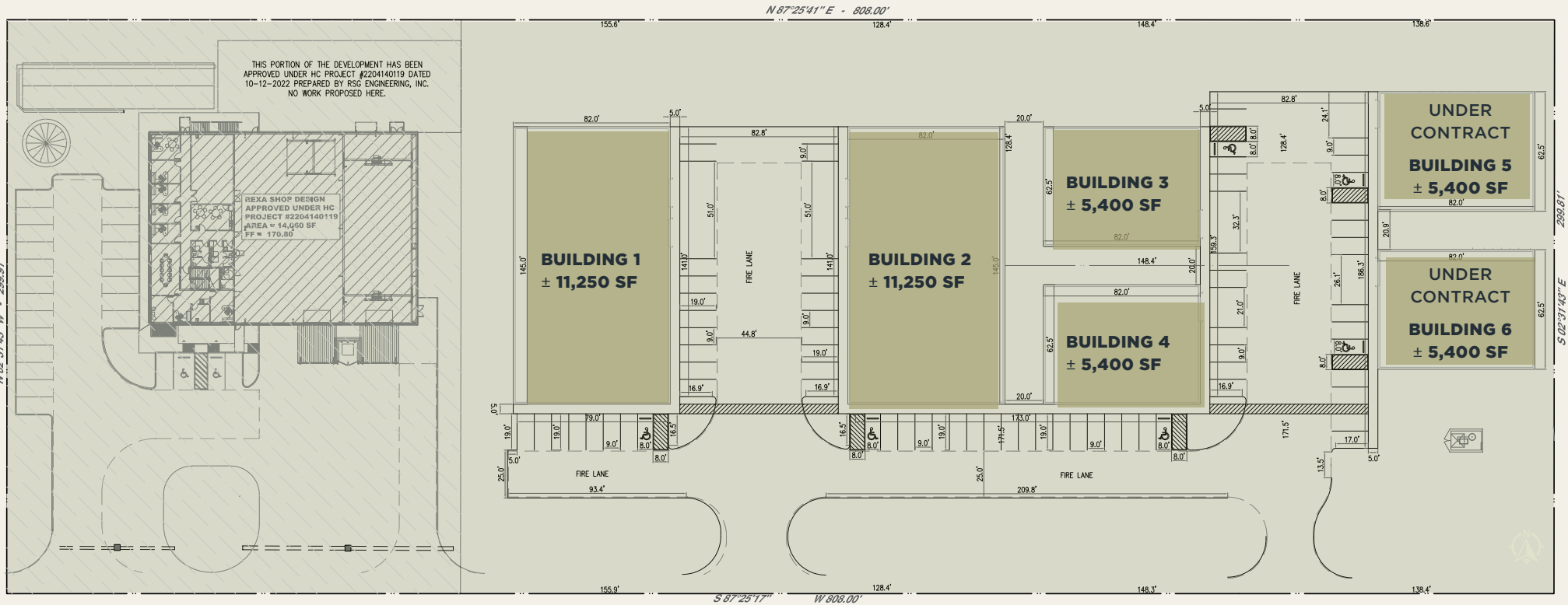

## BUILDINGS 1 & 2

- 10-ton crane ready
- 28' eaves
- Canopy over storefront
- 4 windows (2-street; 2-court)
- 4' wainscoting on street side and store front
- 14' x 16' overhead doors
- 400-amp power / 3 phase

## BUILDINGS 3-6

- 20' eaves
- Single slope
- 4 windows
- Parapet walls
- 4' wainscoting on street side and store front
- 14' x 16' overhead doors
- 420-amp power / 3 phase

# Conveniently located in Northwest Harris County near TX 99/Grand Parkway and TX SH 249

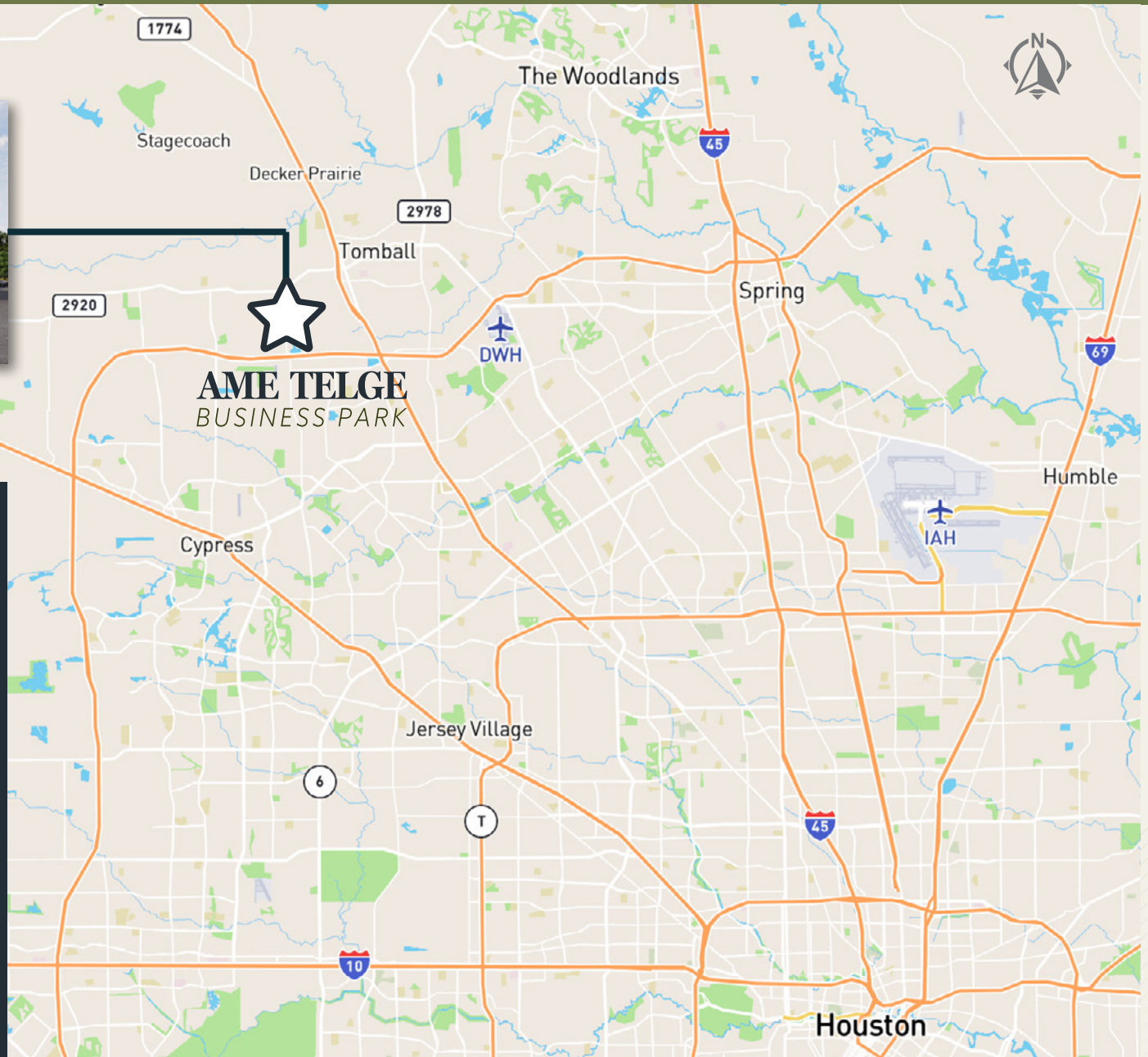

**AME TELGE**  
BUSINESS PARK

## DESTINATION

## MILES

TX 99/GRAND PARKWAY

.9

TX 249

3.9

THE WOODLANDS

21.6

KATY

26.8

IAH

27

DOWNTOWN

33

GALLERIA

32

CONROE

32

AUSTIN

140

SAN ANTONIO

196

DALLAS-FORT WORTH

224



# AME TELGE

## BUSINESS PARK

FOR MORE INFORMATION,  
PLEASE CONTACT:

**Boomer White**  
Industrial Leasing & Sales  
+1 713 577 1676  
boomer.white@cbre.com



© 2024 CBRE, Inc. All rights reserved. This information has been obtained from sources believed reliable, but has not been verified for accuracy or completeness. You should conduct a careful, independent investigation of the property and verify all information. Any reliance on this information is solely at your own risk. CBRE and the CBRE logo are service marks of CBRE, Inc. All other marks displayed on this document are the property of their respective owners. Photos herein are the property of their respective owners. Use of these images without the express written consent of the owner is prohibited.