

# OXFORD CENTER

3548 W 8th St, Los Angeles, CA 90005



## Highlights:

- Ground floor and Second floor spaces available for lease
- Conveniently located in Koreatown near Western Avenue & 8th Street
- Plenty of parking on site
- Elevator access
- Excellent visibility on 8th Street
- Across the street from The Rise Koreatown, a 364-unit apartment building (currently under construction)

## Asking:

- Ground Floor Asking Rate: \$3.75/sf
- Second Floor Asking Rate: \$2.75/sf
- NNN: approx. \$1.06/sf



**Ryan Oh**  
(213) 804-7548  
roh@cbcwilshire.com  
BRE 01082638

**JW Baelly**  
(818) 321-6373  
jw@cbcwilshire.com  
BRE 01865026



# OXFORD CENTER

3548 W 8th St, Los Angeles, CA 90005



Coldwell Banker Commercial Wilshire Properties have obtained the information in this brochure from sources that they believe to be reliable. However, they have not verified its accuracy and make no guarantee, warranty or representation about it. It is submitted subject to the possibility of errors, omissions, change of price, rental or other conditions, prior sale, lease or financing, or withdrawal without notice. Coldwell Banker Commercial Wilshire Properties has included projections, opinions, assumptions or estimates for example only, and they may not represent current or future performance of the property. You and your tax and legal advisors should conduct your own investigation of the property and transaction.

# OXFORD CENTER

3548 W 8th St, Los Angeles, CA 90005

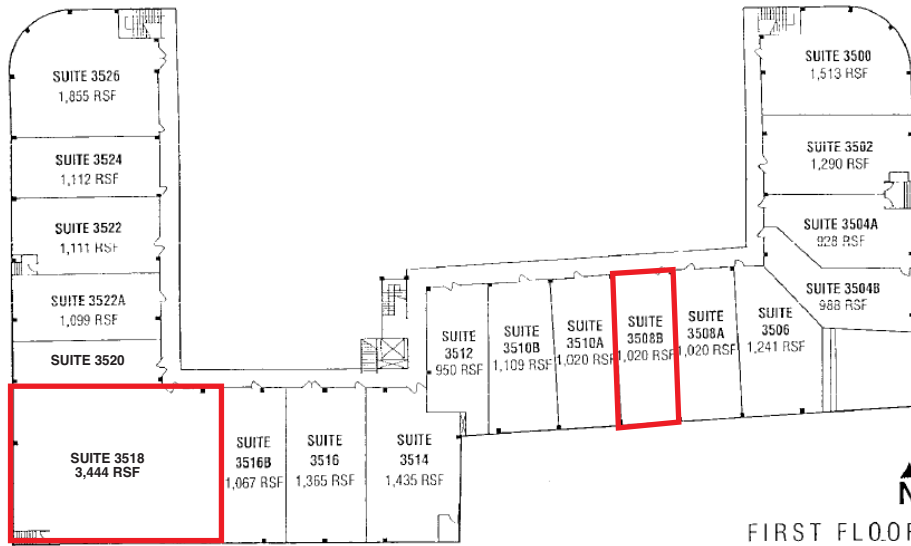

FIRST FLOOR

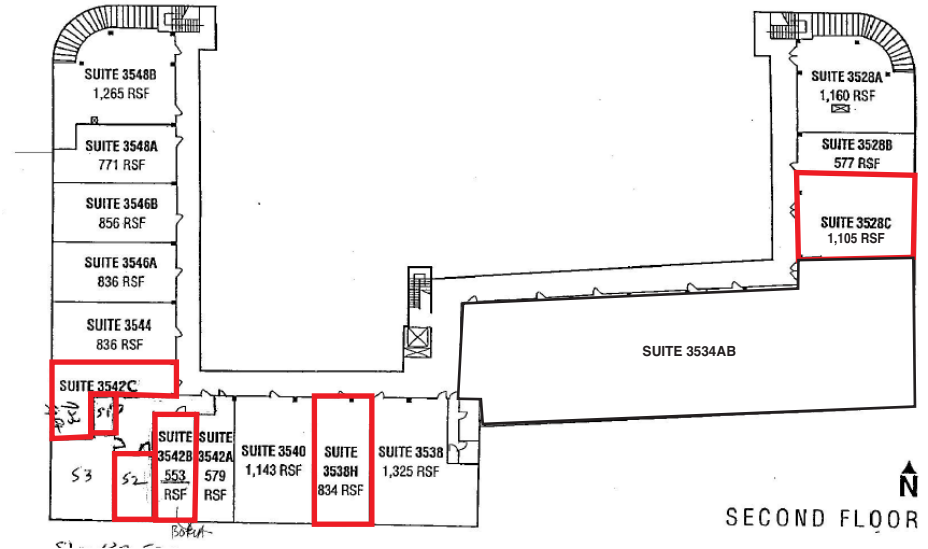

SECOND FLOOR

## First Floor Tenants:

- Suite 3526: Honey Night
- Suite 3524: Halgatteok
- Suite 3522: Thank Pho
- Suite 3522A: K&C Hair
- Suite 3520: Jung Kwan Jang Ginseng Shop
- Suite 3518: **Vacant (3,444 sf)**
- Suite 3516B: Hyo Yeon Lau & Steve Lau
- Suite 3616: Two Zone Chicken
- Suite 3514: Potions & Poisons
- Suite 3512: I Love Boba
- Suite: 3510B: Shila Jewelry
- Suite 3510A: Damo Tea House
- Suite 3508B: **Vacant (1,020 sf)**
- Suite 3508A & 3506: Cconma Shopping Mall
- Suite 3504AB: Cconma
- Suite 3502: Liquor Market
- Suite 3500: Slurping Ramen

## Second Floor Tenants:

- Suite 3548B: Pilates
- Suites 3548A: Head Spa
- Suite 3546B: Hyun Dai Amiwon
- Suite 3546A: Barbershop
- Suite 3544: Dentistry
- Suite 3542C: **Vacant (728 sf)**
- Storage 51: **Vacant (137 sf)**
- Storage 52: **Vacant (403 sf)**
- Storage 53: J-Town
- Suite 3542B: **Vacant (553 sf)**
- Suite 3542A: Massage
- Suite 3540: MediSpa
- Suite 3538H: **Vacant (800 sf)**
- Suite 3538: Nail & Eyelash Salon
- Suite 3534AB: Karaoke
- Suite 3528C: **Vacant (1,055 sf)**
- Suite 3528B: Hair braiding
- Suite 3528A: Vape Shop

# OXFORD CENTER

3548 W 8th St, Los Angeles, CA 90005



**Demographics:**

- 42,684**  
Vehicles per day on Western Ave
- 113,052**  
Population (1-mile radius)
- 669,654**  
Population (3-mile radius)
- \$47,089**  
Median HH Income (1-mile radius)
- \$49,602**  
Median HH Income (3-mile radius)
- 37.7**  
Median Age

Coldwell Banker Commercial Wilshire Properties have obtained the information in this brochure from sources that they believe to be reliable. However, they have not verified its accuracy and make no guarantee, warranty or representation about it. It is submitted subject to the possibility of errors, omissions, change of price, rental or other conditions, prior sale, lease or financing, or withdrawal without notice. Coldwell Banker Commercial Wilshire Properties has included projections, opinions, assumptions or estimates for example only, and they may not represent current or future performance of the property. You and your tax and legal advisors should conduct your own investigation of the property and transaction.