

Scottsdale Place

5705 & 5725 N. Scottsdale Rd.
Scottsdale, AZ 85250
Maricopa County



key features

- built-out office suites
- prime "Old Scottsdale" location, bordering downtown Paradise Valley, just north of Scottsdale
- covered parking, basement storage, and monument signage also available
- daily traffic count: 46,142 on Scottsdale Road

demographics

	1 mile	3 miles	5 miles
population	10,746	80,627	189,574
households	6,325	42,292	93,320
avg. household income	\$207,437	\$180,908	\$175,329
daytime population	11,948	91,587	200,540

2025 Estimates. Source: Applied Geographic Solutions 5/2025, TIGER Geography

office space for lease 351 – 2,531 sf

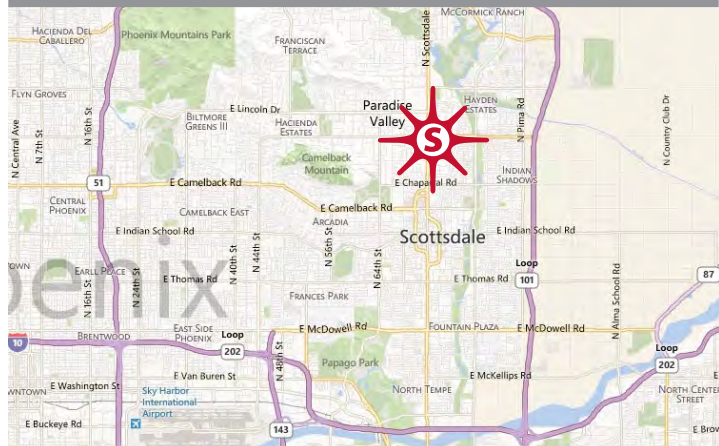

www.sandordev.com

sandor

Nick Orozco 480.385.1316 norozco@sandordev.com

5725 N. Scottsdale Rd., Suite C-195, Scottsdale, AZ 85250

Scottsdale Place

5705 & 5725 N. Scottsdale Rd.
Scottsdale, AZ 85250
Maricopa County

building c

building d

UNIT	TENANT	S.F.
C-100	CITY TO CITY COMMERCIAL	4,297
C-105	ADDISON TAYLOR FINE JEWELRY	1,200
C-110	AVAILABLE	2,531
C-120	PWI CONSTRUCTION	760
C-135	PWI CONSTRUCTION	1,811
C-150	AVALON DEVELOPMENT	2,292
C-155	AVAILABLE	635
C-160	AVAILABLE	351
C-173	EDWARD JONES	814
C-195	SANDOR / SAND CAPITAL	5,595

UNIT	TENANT	S.F.
D-100	COMPLIANT DATA SERVICES	2,695
D-110	MILLENIUM DENTAL	2,115
D-120	ESTHETIC FINESSE	5,555

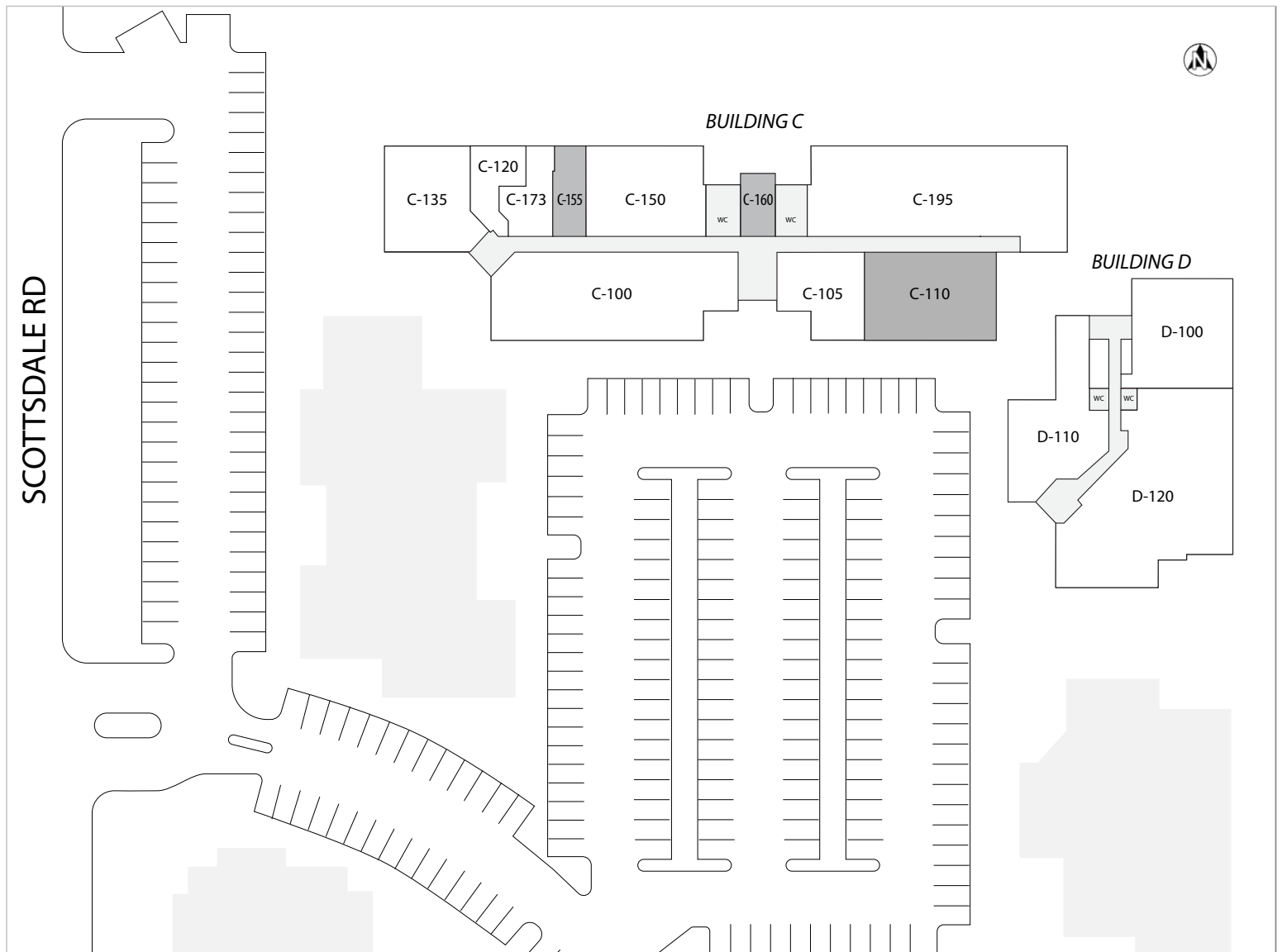

Nick Orozco 480.385.1316 norozco@sandordev.com

5725 N. Scottsdale Rd., Suite C-195, Scottsdale, AZ 85250

www.sandordev.com
sandor