

20 28 21

INFORMATION
SUBDIVISION ACRES
SEC. 642.00
ALL IN 14 45.00
BLVDYB OF RECORD

1000

[illegible][illegible]

1000

52 1047> GREENACHES W 1 L2
 52 1244> GREENACHES W 1 L6
 52 1245> GREENACHES W 1 ACC STRIP
 52 1246> GREENACHES W 1 L5
 52 1547> SAN
 52 1785> ZH
 52 1882> RJ, FJC

69

10274-26, RTMT
11144-82 RTMT
11893-36C, GC, ROW
12254-7J BLA
17600-1F RTMT
18089-36C, HC, ROW
18090-1E ROW
18294-3A, AGRICULTURE, HC, ROW
19460-1E, AIRPORT, RD, ROW
19460-16A, BMA, OCC SALE
17717-1 GREENGLA LA BZ, OCC SALE
17794-24A, ZANU, OCC SALE
21211-1 ERD, SWE, SPANIA RTMT
21212-1 RTMT
21849-3C, HC, ROW
21849-16A, BMA, OCC SALE
22011-30, BMA, YCD, OCC SALE
22011-30, YAC, ACCESS
22050-7J, OA, OCC SALE
22479-44A, BLA
26279-1 SCIFA, OCC SALE
26344-1 GREENACRES LA19, 20 RTMT
27500-2ANHA, LMS, 70 OVER 20
28194-1 TWIN, RD, AC, L2, BZ RTMT
28194-19A, PHA, OCC SALE
28194-19A, OCC SALE
28194-19A, RTMT
29344-ANNE, OCC SALE
29344-ANNE, OCC SALE
29344-ANNE, OCC SALE

2535S-700 BLA
 2639S-70F BLA
 3037S- GREENHORNES LA 82 FT
 3348S-700 OCC SALE
 3353S-700 OCC SALE
 3357S-700 BLA
 3373S-700 BLA
 3373S-700S OVER 20
 3684S-70K RTMT
 3692S-70D BLA
 3730S-70J RTMT
 3731S-70A, 70SA FT
 3758S-700 BLA
 3934S-700A OCC SALE
 3951S-2, 2AG, 70A OCC SALE
 4033S-00DA, 30A, 30A1A
 BLA/OCC SALE
 4210S-700 OCC SALE
 4577S-WALKER AVE FT
 462S-4AB, 4ABA MT, OCC SALE
 4148S-9FT, 9CMT RTMT
 469S-4ABA/50G
 469S-88F RTMT
 469S-700 OCC SALE
 486S-30 AG
 486S-70AG, 40VLY BE/2AG
 502S-70A RTMT
 507S-20AG
 508S-37S OCC SALE
 5144S-7AB, 7AB, 7AB, 7AB RTMT
 5145S-7, 7G, 7G, 7G, 7AG, 7AG, 7H
 5145S-7, 7G, 7G, 7G, 7G, 7G, 7G
 5013S-37, 3U, 40A RTA

[illegible][illegible]

30000: SCOTT FIELD PARK AVE L4 L4 ALZ
 30000: SCOTT FIELD PARK AVE L4 L4 ALZ
 30077: MURRAY BLOUGH TWINN HMT
 30090: SCOL HMT
 30090: 13 E. BLA
 30090: 3E, 3RD AVE
 30090: 2AA, 2AM, 2AP BLA
 30090: 05, 6E BLA
 30090: 160 FT
 30090: TWIN ACRES LA WYOM BL HMT
 30101: E. DR AG
 30114: 2AC, 2ACA HMT
 30224: 9C2A, 9C2E, 9C2K, 9C2EA BLA, HMT
 30251: 0E, 0A BLA
 30259: 3A LEASE
 30259: 8EA, 8EBA, 8ECA HMT
 30259: 750B, 752D, 753A, 752A, 758C HMT

SUBJECT

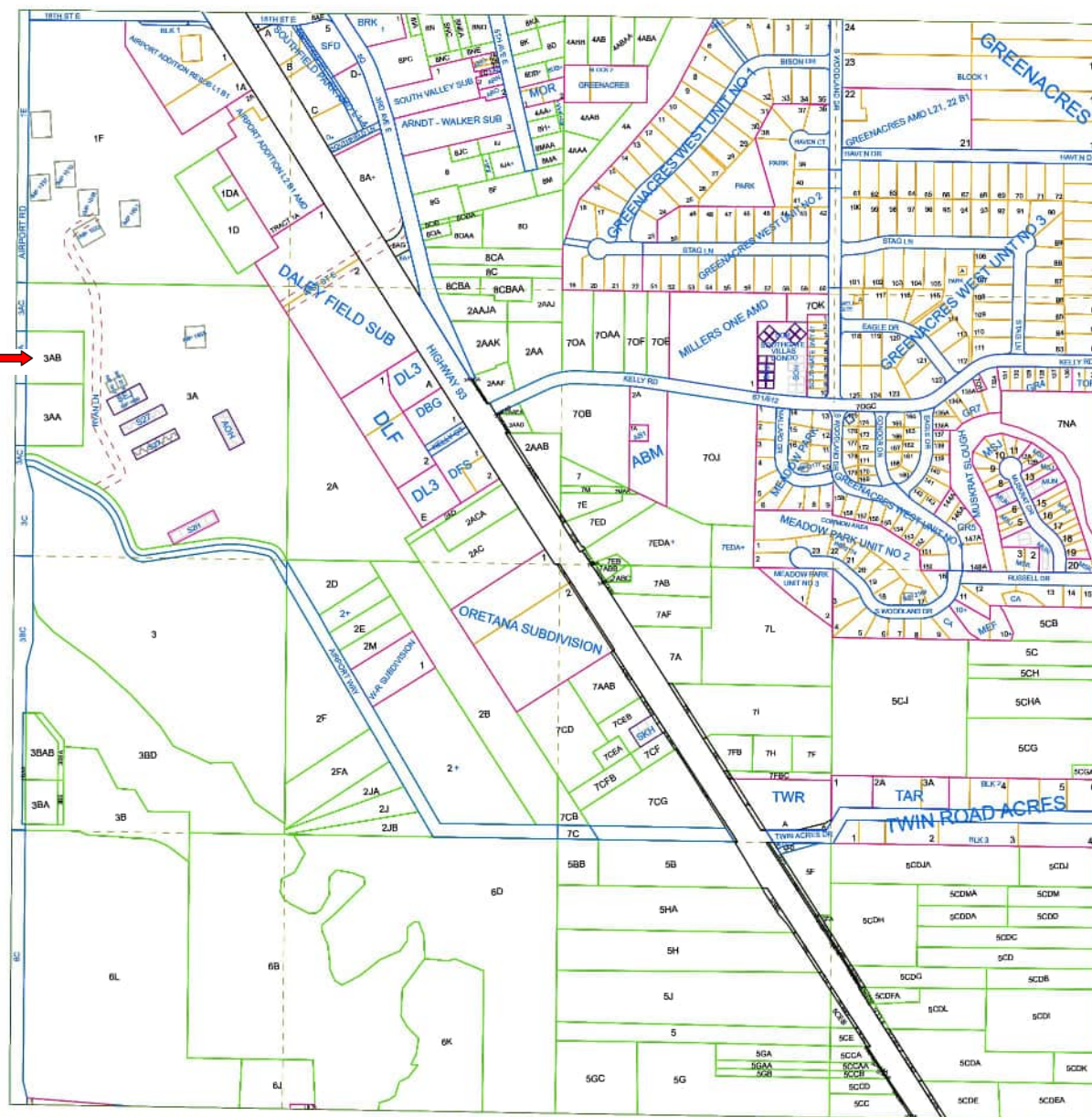

5/02/25