

CENTRAL PLAZA

1,178 – 5,677 SF | RETAIL FOR LEASE

9880-9914 COLERAIN AVE
CINCINNATI, OHIO 45251



LAURI STEFANOU

SENIOR VICE PRESIDENT

MOBILE 513.604.1414 | **DIRECT** 513.842.9504
LSTEFANOU@EQUITY.NET

equity | **brokerage**

The information contained herein has been obtained from the property owner or other sources that we deem reliable. Although we have no reason to doubt its accuracy, no representation or warranty is made regarding the information, and the property is offered "as is". The submission may be modified or withdrawn at any time by the property owner.

PROPERTY HIGHLIGHTS

- Excellent location on high-traffic Colerain Ave across from Stonecreek Towne Center
- 1,178± SF and 4499± SF Retail space available in this busy neighborhood center
- Join Hobby Lobby, Outback Steakhouse, Verizon, Porter Paint, Central Liquors, Neptune Eye, Merry Maids, A Better Life Chiropractic, Minuteman Press, Huntington Learning, Bob Evans and more
- Highly visible signage opportunity along Colerain Ave
- NNN lease (rate negotiable)
- Over 35,000 VPD on US Hwy 27

CENTRAL PLAZA RETAIL FOR LEASE

9880-9914 COLERAIN AVE
CINCINNATI, OHIO 45251



LAURI STEFANOU
SENIOR VICE PRESIDENT

MOBILE 513.604.1414 | **DIRECT** 513.842.9504
LSTEFANOU@EQUITY.NET

LOCATION & SIGNAGE

CENTRAL PLAZA RETAIL FOR LEASE

9880-9914 COLERAIN AVENUE
CINCINNATI, OHIO 45251



LAURI STEFANO
SENIOR VICE PRESIDENT

MOBILE 513.604.1414 | DIRECT 513.842.9504
LSTEFANO@EQUITY.NET

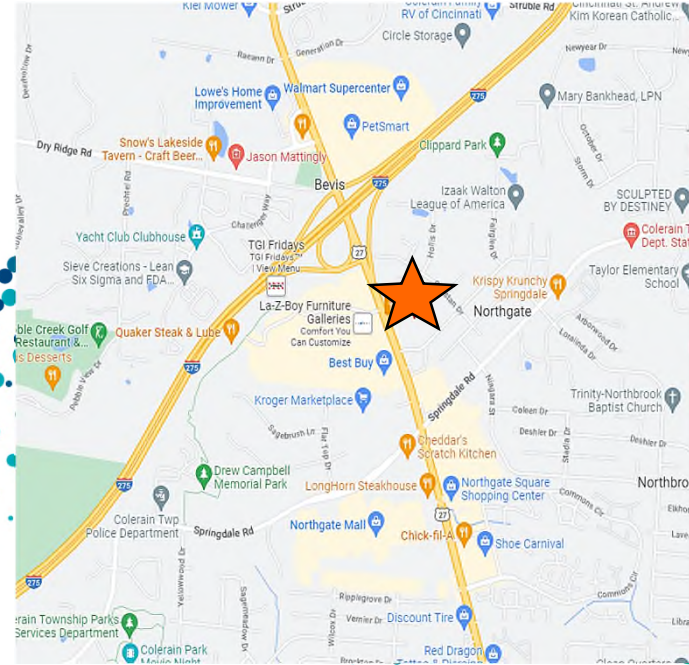

SPACE AVAILABLE



9898

1,178 SF

9881

4,499 SF



LAURI STEFANOU
SENIOR VICE PRESIDENT

MOBILE 513.604.1414 | DIRECT 513.842.9504
LSTEFANOU@EQUITY.NET

SITE PLAN

9898 (105)
1,178 SF

9881
4,499 SF

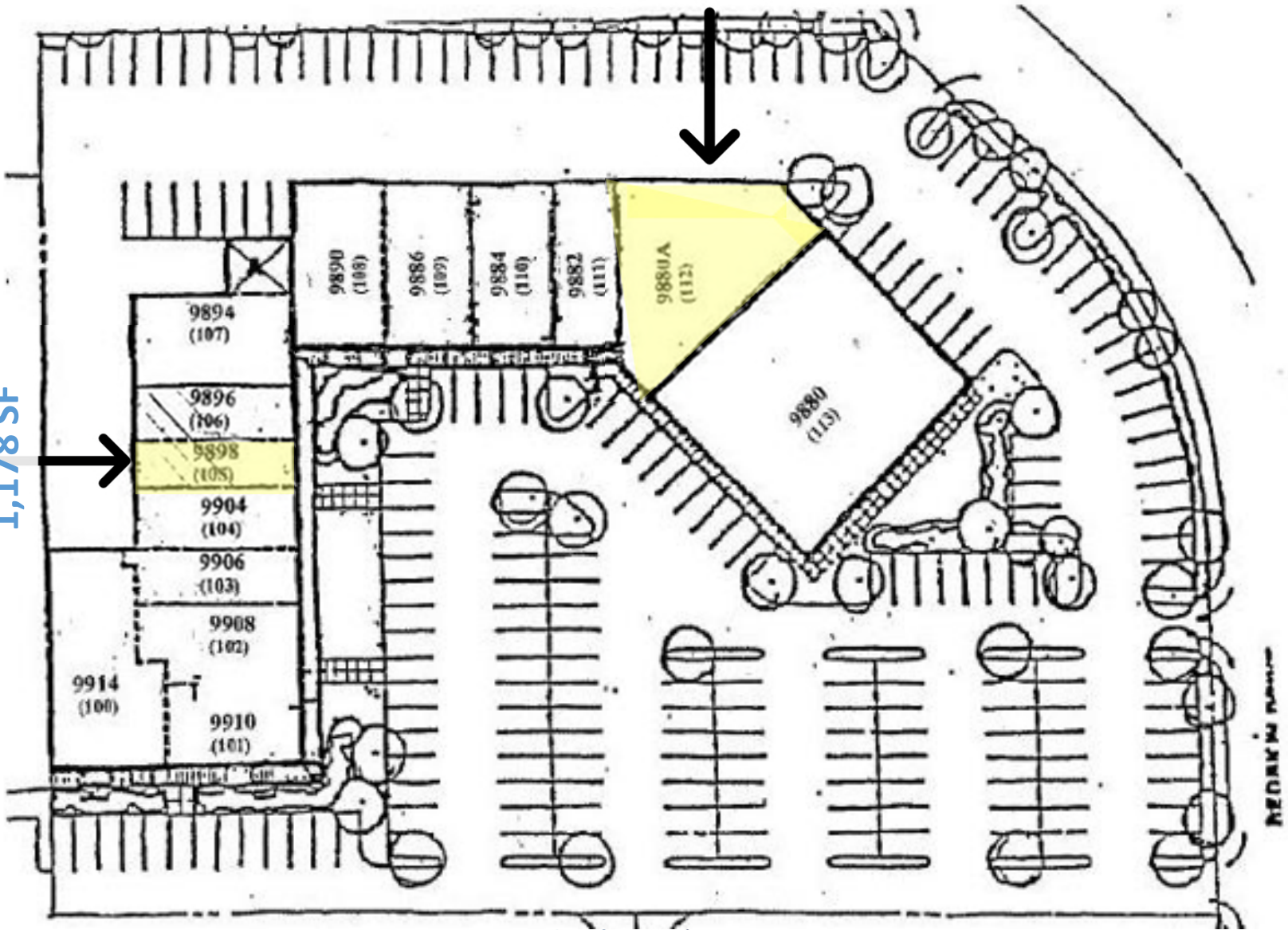

KEY FACTS

CENTRAL PLAZA RETAIL FOR LEASE

9880 - 9914 COLERAIN Ave
CINCINNATI, OHIO 45251



LAURI STEFANO
SENIOR VICE PRESIDENT

MOBILE 513.604.1414 | **DIRECT** 513.842.950
LSTEFANO@EQUITY.NET

Key Facts

9914 Colerain Ave, Cincinnati, Ohio, 45251
Ring: 3 mile radius

KEY FACTS

54,200

Population



Average
Household Size

39.9

Median Age

\$63,747

Median Household
Income

EDUCATION

8%

No High School
Diploma



35%

High School
Graduate



34%

Some College



23%

Bachelor's/Grad/Prof
Degree

BUSINESS



1,300

Total Businesses



17,365

Total Employees

EMPLOYMENT

58.7%

White Collar



24.2%

Blue Collar



17.1%

Services

3.1%

Unemployment
Rate

INCOME



\$63,747

Median Household
Income



\$34,181

Per Capita Income



\$168,128

Median Net Worth

Households By Income

The largest group: \$50,000 - \$74,999 (22.6%)

The smallest group: \$200,000+ (4.5%)

Indicator ▲	Value	Diff	
<\$15,000	5.9%	-4.6%	
\$15,000 - \$24,999	9.3%	+0.4%	
\$25,000 - \$34,999	8.0%	-0.2%	
\$35,000 - \$49,999	12.2%	+1.9%	
\$50,000 - \$74,999	22.6%	+6.0%	
\$75,000 - \$99,999	13.1%	+1.7%	
\$100,000 - \$149,999	17.8%	+1.2%	
\$150,000 - \$199,999	6.7%	-1.2%	
\$200,000+	4.5%	-5.1%	

Bars show deviation from Hamilton County