



±38,753 SF BUILDING  
ON ±2.66 ACRES OF LAND

5472 E. LA PALMA AVENUE  
ANAHEIM

AVAILABLE FOR SALE



COMMERCIAL REAL ESTATE SERVICES

Corporate ID: 01044791

LEASED INVESTMENT

**BOBBY MARTINEZ**

Associate

License ID# 02204507

949.790.3104

[bmartinez@leeirvine.com](mailto:bmartinez@leeirvine.com)

**STEFFAN MORRIS**

Senior Vice President

License ID# 02010049

949.790.3190

[smorris@leeirvine.com](mailto:smorris@leeirvine.com)

**DANIELLE HEBERT**

Broker Assistant

License ID# 02227534

949.790.3166

[dhebert@leeirvine.com](mailto:dhebert@leeirvine.com)

All information furnished regarding property for sale, rental or financing is from sources deemed reliable, but no warrant or representation is made to the accuracy thereof and same is submitted to errors, omissions, change of price, rental or other conditions prior to sale, lease or financing or withdrawal without notice. No liability of any kind is to be imposed on the broker herein.

# PROPERTY HIGHLIGHTS

5472 E. LA PALMA AVENUE | ANAHEIM

- Leased Investment Sale
- ±38,753 Sq. Ft. (Divisible) Industrial Building
- ±3,000 Sq. Ft. of New Creative Office Training Room
- ±2.66 Acres of Land Area
- 3.27:1,000 Surface Parking
- ±1,600 Amps of Power (Verify)
- .60/2,000 Sprinkler System (Verify)
- ±20' Clear Height
- Fully Fenced Property
- 3 Ground Level Doors
- Building Renovations Complete in 2020
- Improvements Include:
  - › New Office and Restrooms
  - › New HVAC
  - › Parking Lot Slurry Stripe
  - › New Roof Coating System (2022)



For More Information, Please Contact:

**BOBBY MARTINEZ**  
Associate  
License ID# 02204507  
949.790.3104  
bmartinez@leeirvine.com

**STEFFAN MORRIS**  
Senior Vice President  
License ID# 02010049  
949.790.3190  
smorris@leeirvine.com

**DANIELLE HEBERT**  
Broker Assistant  
License ID# 02227534  
949.790.3166  
dhebert@leeirvine.com

**LEE & ASSOCIATES**  
COMMERCIAL REAL ESTATE SERVICES  
Corporate ID: 01044791



5472 E. LA PALMA AVENUE | ANAHEIM

E. LA PALMA AVENUE

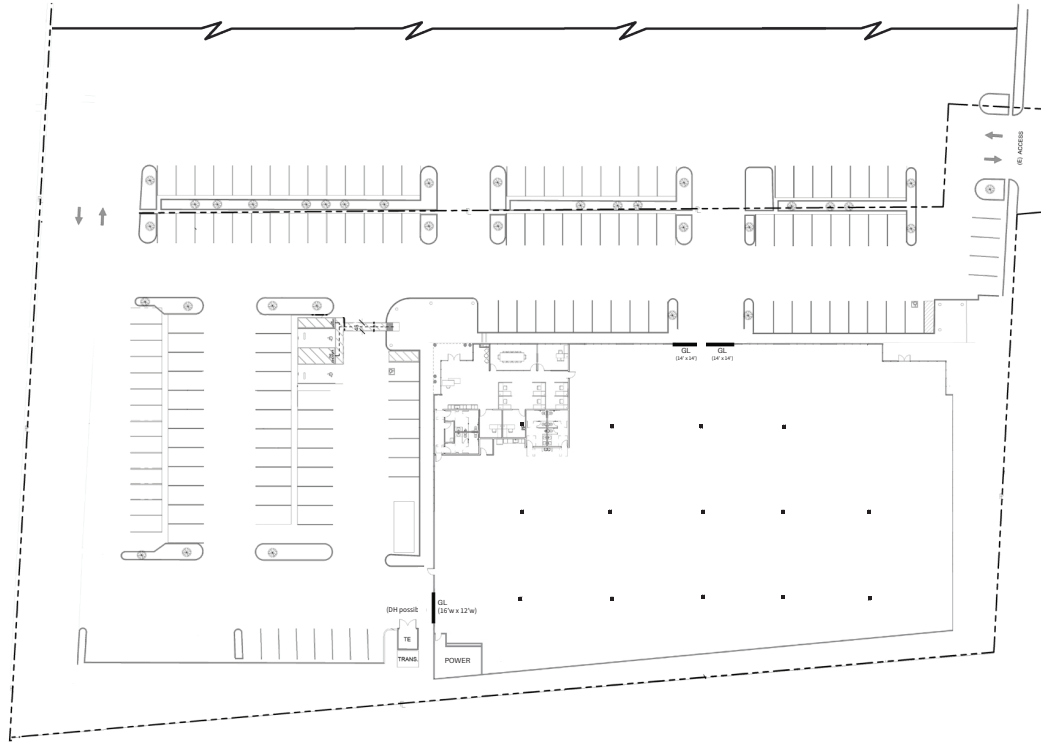

Tenant:	NexGen
Lease Commencement:	5/5/2022
Lease Expiration:	4/30/2027
2025 NOI:	\$532,192
Annual Increases:	3% Per Year
Options:	One 5-yr Option

NexGen is a leading HVAC and plumbing service provider in Southern California. With eight locations, NexGen delivers top-tier installations, repairs, and maintenance backed by experienced professionals and a lifetime warranty on their branded products. Committed to competitive pricing and customer satisfaction, NexGen has been proudly serving the region since 2016.

**NEXGEN**  
AIR CONDITIONING • HEATING • PLUMBING

For More Information, Please Contact:

**BOBBY MARTINEZ**  
Associate  
License ID# 02204507  
949.790.3104  
bmartinez@leeirvine.com

**STEFFAN MORRIS**  
Senior Vice President  
License ID# 02010049  
949.790.3190  
smorris@leeirvine.com

**DANIELLE HEBERT**  
Broker Assistant  
License ID# 02227534  
949.790.3166  
dhebert@leeirvine.com

**LEE & ASSOCIATES**  
COMMERCIAL REAL ESTATE SERVICES  
Corporate ID: 01044791

# SITE LOCATOR

5472 E. LA PALMA AVENUE | ANAHEIM



For More Information, Please Contact:

**BOBBY MARTINEZ**  
Associate  
License ID# 02204507  
949.790.3104  
bmartinez@leeirvine.com

**STEFFAN MORRIS**  
Senior Vice President  
License ID# 02010049  
949.790.3190  
smorris@leeirvine.com

**DANIELLE HEBERT**  
Broker Assistant  
License ID# 02227534  
949.790.3166  
dhebert@leeirvine.com

**LEE & ASSOCIATES**  
COMMERCIAL REAL ESTATE SERVICES  
Corporate ID: 01044791