

PALM BEACH MARKETPLACE

1900-1960 OKEECHOBEE BLVD, WPB FL 33409

Prime Retail Space Available



DEZIEL COMPANY

PROPERTY HIGHLIGHTS

- Located at Okeechobee Blvd and I-95, which is the gateway to West Palm Beach.
- 100,000 SF mixed use development (retail and restaurant).
- Located on a strong business and commercial corridor.
- Excellent co-tenancy and ideal location for premium national and regional retailers & restaurants.
- Close proximity to Wall St South businesses and upscale residents in Palm Beach, City Place, and Downtown WPB.
- Strong morning and daytime population, with traffic counts exceeding 60,000 ADT.
- Ample parking with 5 access points from Okeechobee Blvd.

DEMOGRAPHICS (3 MILES)

POPULATION
113,725

DAYTIME POPULATION
160,983

MEDIAN AGE
40.2

AVG. HH INCOME
\$117,897





AVAILABLE SPACES

RETAIL AND RESTAURANT

1,000 - 3,000 SF

**1.5 MILES TO
DOWNTOWN WEST PALM BEACH**

**2.5 MILES TO
PALM BEACH**

.1 MILE TO I-95



OKEECHOBEE BOULEVARD

**PALM BEACH
MARKETPLACE**



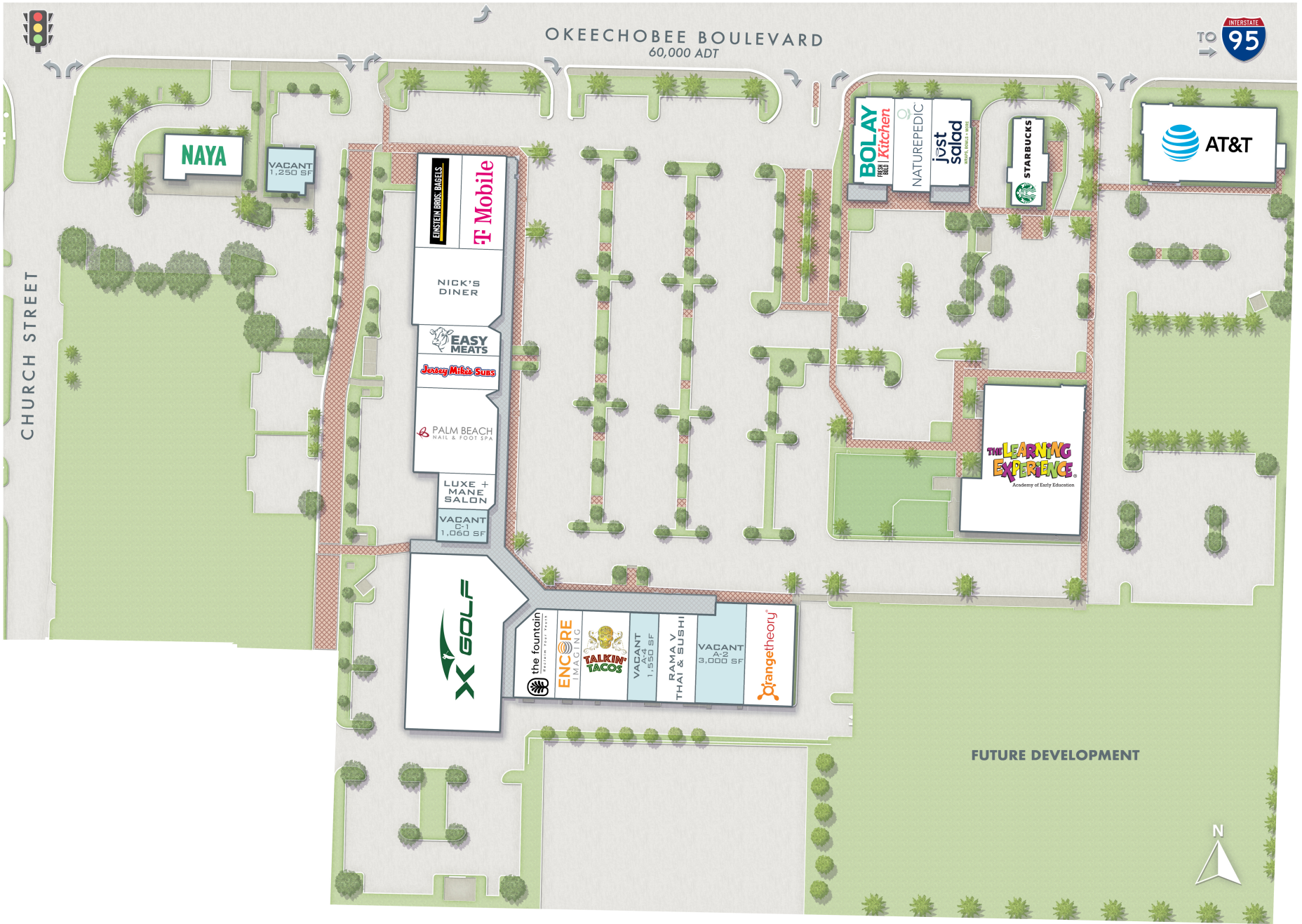

PROJECT TENANTS





PALM BEACH MARKETPLACE

DEZIEL COMPANY



CONTACT

LEWIS THOMPSON
LEWIS@DEZIELCOMPANY.COM
561.602.9491

DEZIEL COMPANY