

1375

N FIESTA BLVD

GILBERT, AZ 85233



CBRE

MIKE PARKER

Executive Vice President
+1 602 614 7877
mike.parker6@cbre.com

EVAN KOPLAN, SIOR, CCIM

Executive Vice President
+1 602 735 5232
evan.koplan@cbre.com

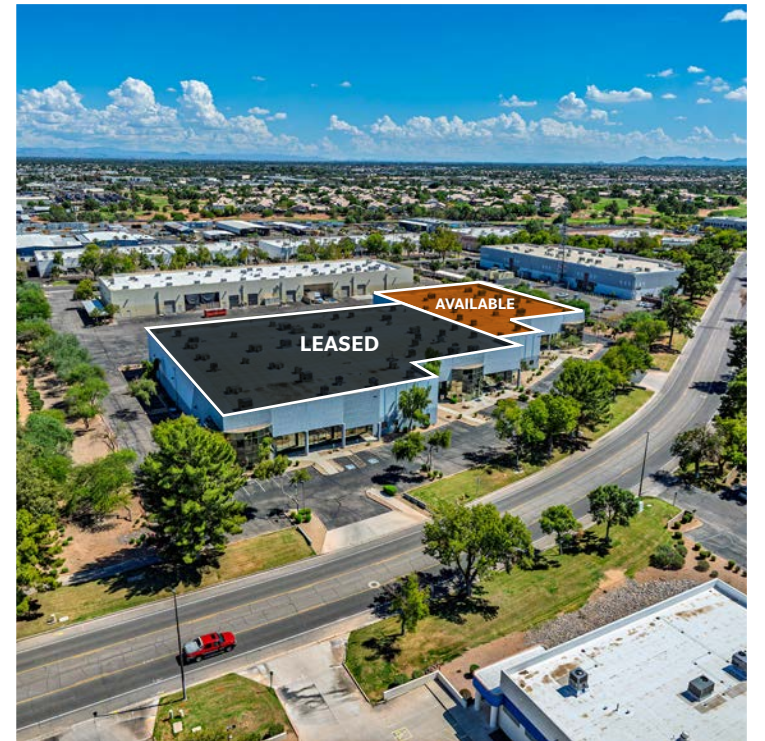

PROPERTY OVERVIEW

- + ±24,874 SF Available
- + ±26' clear height in warehouse
- + 100% air conditioned
- + Two (2) grade-level loading doors
- + ±2,200 amps 277/480 volt electrical service (SES)
- + ±312 parking stalls or ±4.26/1,000
- + Fire sprinklered
- + Constructed in 1998
- + Telecommunications provided by Cox Communications
- + Corporate image park with mature landscaped boulevards
- + Rental Rate: \$1.35/SF NNN



±0.5 MILES FROM
FULL DIAMOND
INTERCHANGE AT
US-60 AND COUNTRY
CLUB DRIVE



AVAILABLE
IMMEDIATELY



ZONED LI
(LIGHT INDUSTRIAL)
TOWN OF GILBERT

FLOOR PLANS

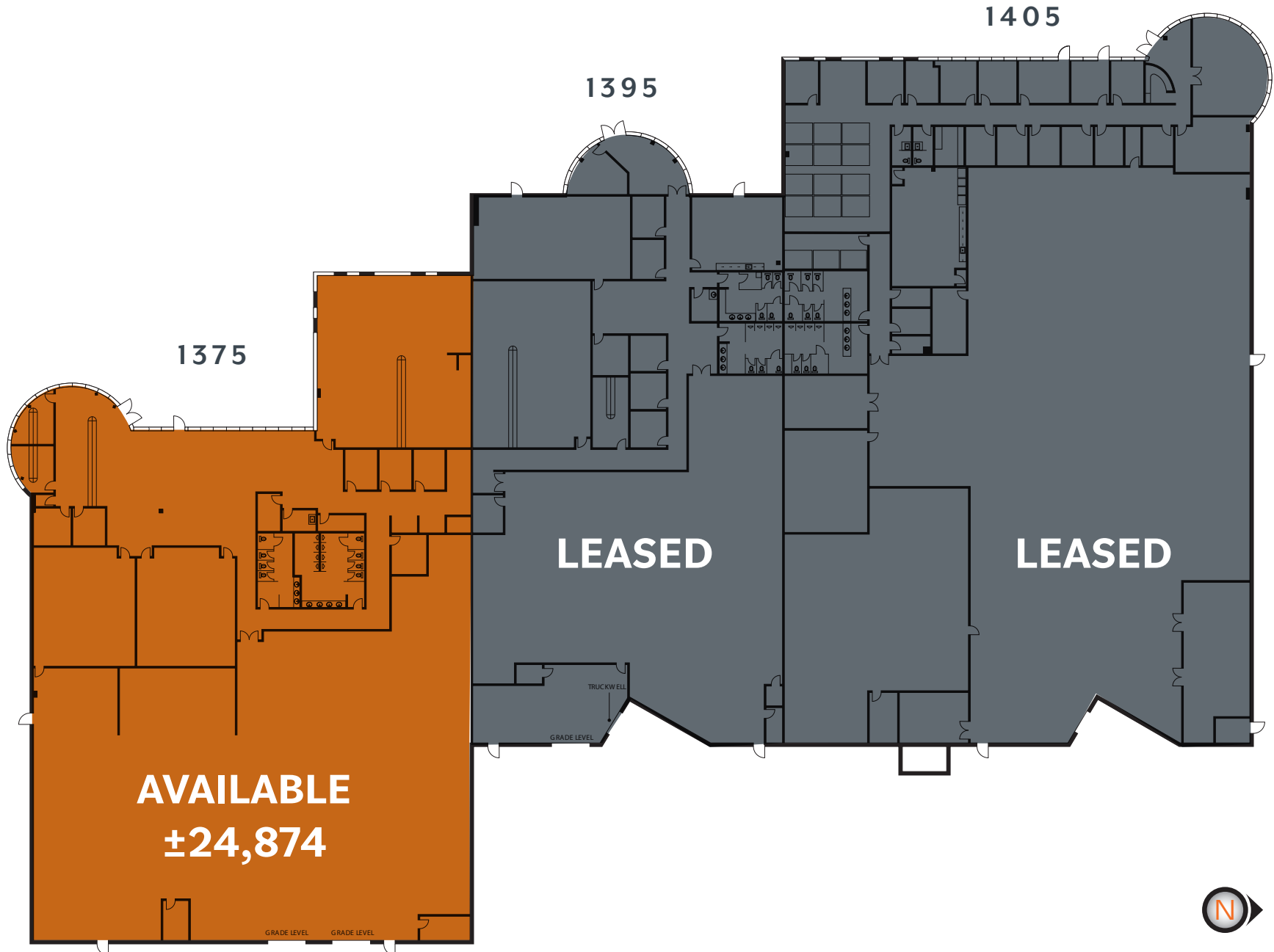

MAP



INTERIOR PHOTOS

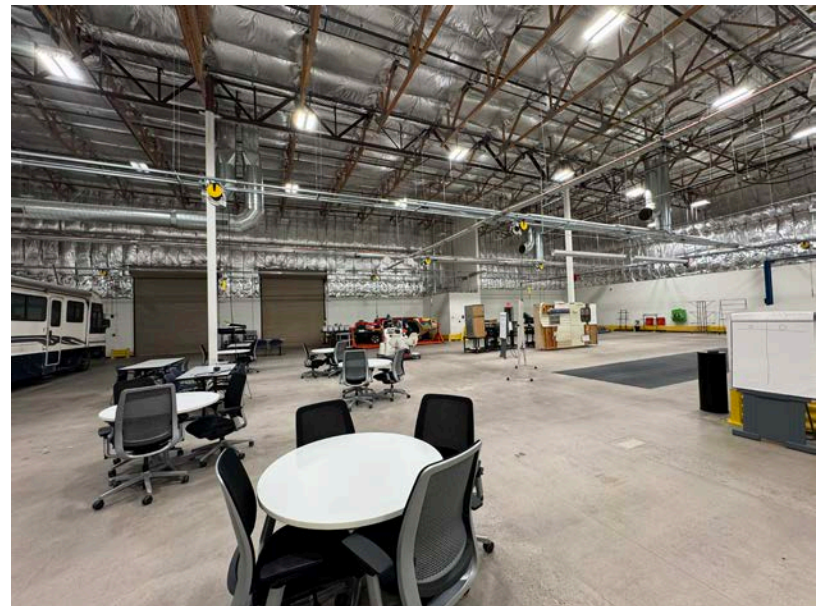
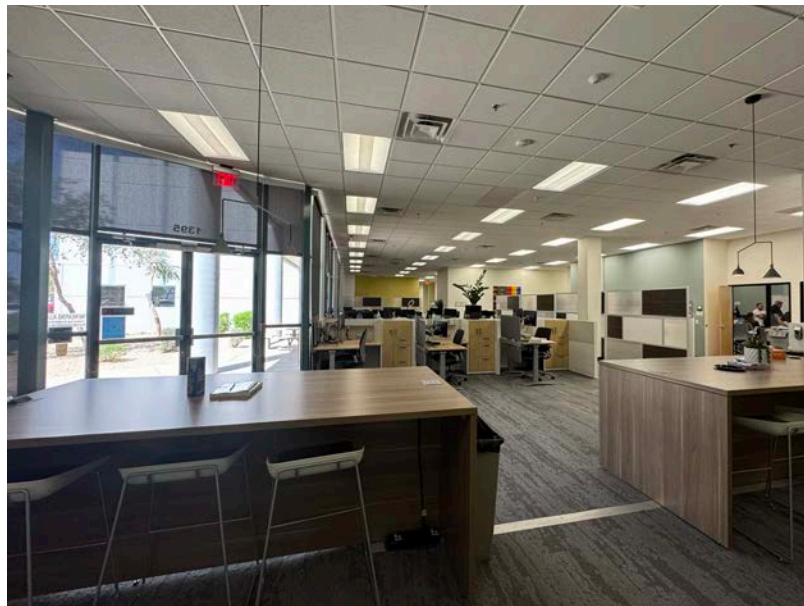

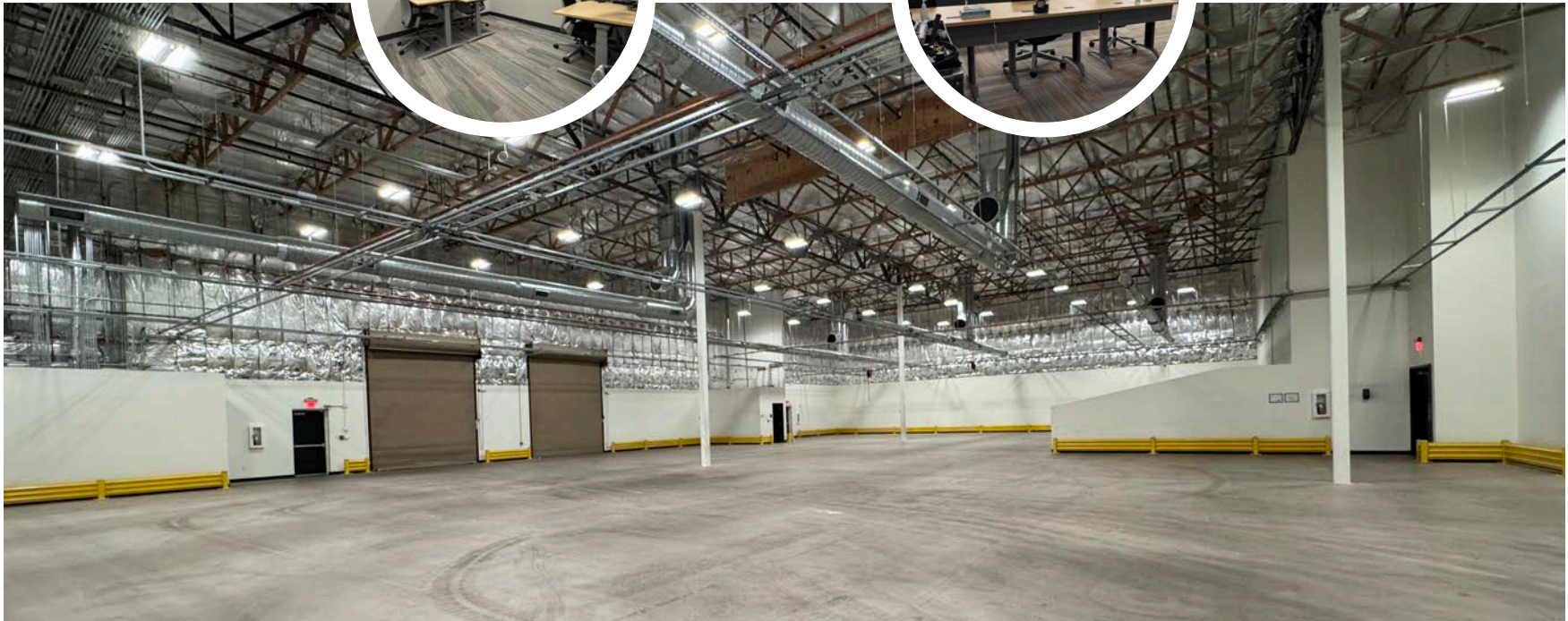



1375

N FIESTA BLVD

MIKE PARKER

Executive Vice President
+1 602 614 7877
mike.parker6@cbre.com

EVAN KOPLAN, SIOR, CCIM

Executive Vice President
+1 602 735 5232
evan.koplan@cbre.com

© 2026 CBRE, Inc. All rights reserved. This information has been obtained from sources believed reliable but has not been verified for accuracy or completeness. CBRE, Inc. makes no guarantee, representation or warranty and accepts no responsibility or liability as to the accuracy, completeness, or reliability of the information contained herein. You should conduct a careful, independent investigation of the property and verify all information. Any reliance on this information is solely at your own risk. CBRE and the CBRE logo are service marks of CBRE, Inc. All other marks displayed on this document are the property of their respective owners, and the use of such marks does not imply any affiliation with or endorsement of CBRE. Photos herein are the property of their respective owners. Use of these images without the express written consent of the owner is prohibited.

CBRE