

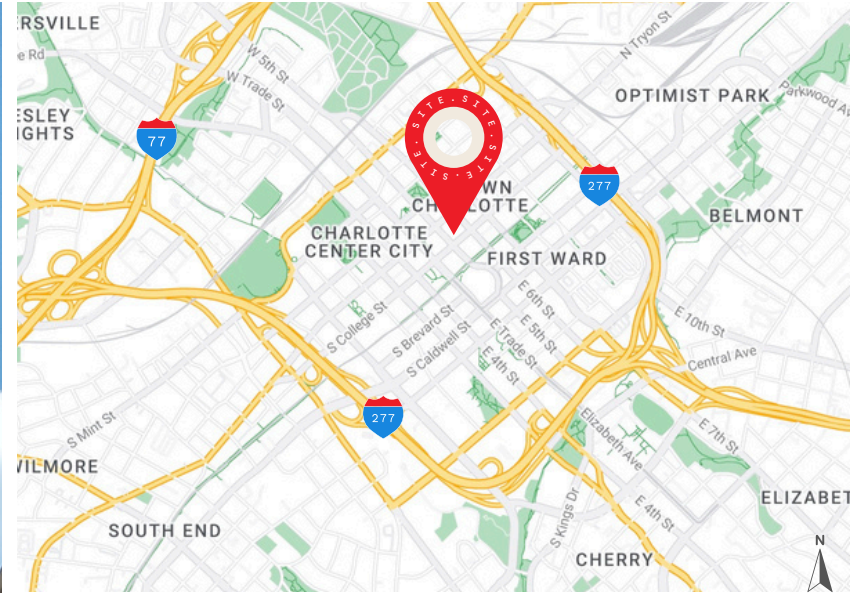

 RETAIL FOR LEASE

Truist Center

Charlotte, NC, 28202



INTRODUCTION

LOCATION

SITE PLAN

CONTACT

PROPERTY DETAILS ▼

Charlotte's Uptown district is at your doorstep. This prime retail space places you in the heart of a thriving urban landscape, surrounded by office towers, luxury residences, and cultural attractions that draw diverse crowds every day.

 214 N. Tryon Street Charlotte, NC 28202

Space Available 807 - 2,871 SF

Delivery Condition 2nd Generation

Use Retail/Restaurant

Delivery Date 30 Days

Neighborhood Uptown



Prime Uptown Location

Bordered by N Tryon Street, N. College Street, and 5th and 6th Streets, Truist Center sits in a hub of activity with direct access to Overstreet Mall, a skywalk system that connects 8 office buildings, restaurants, shops, hotels and parking garages with entrances along Tryon and College streets.

Skyline Defining Art Deco Architecture

Currently the third tallest building in Uptown Charlotte, the iconic architecture of Truist Center draws attention to and enhances the visibility of this prime ground-level retail space.

A Cultural and Business Epicenter

Uptown Charlotte is known for its vibrant cultural scene, anchored by theaters, museums, concert halls and sporting venues. This area experiences constant activity thanks to its proximity to popular attractions like Discovery Place, Blumenthal Performing Arts Center, and the Mint Museum. It's also steps away from office towers and high-end hotels, ensuring a steady flow of potential customers.





INTRODUCTION

LOCATION

SITE PLAN

CONTACT

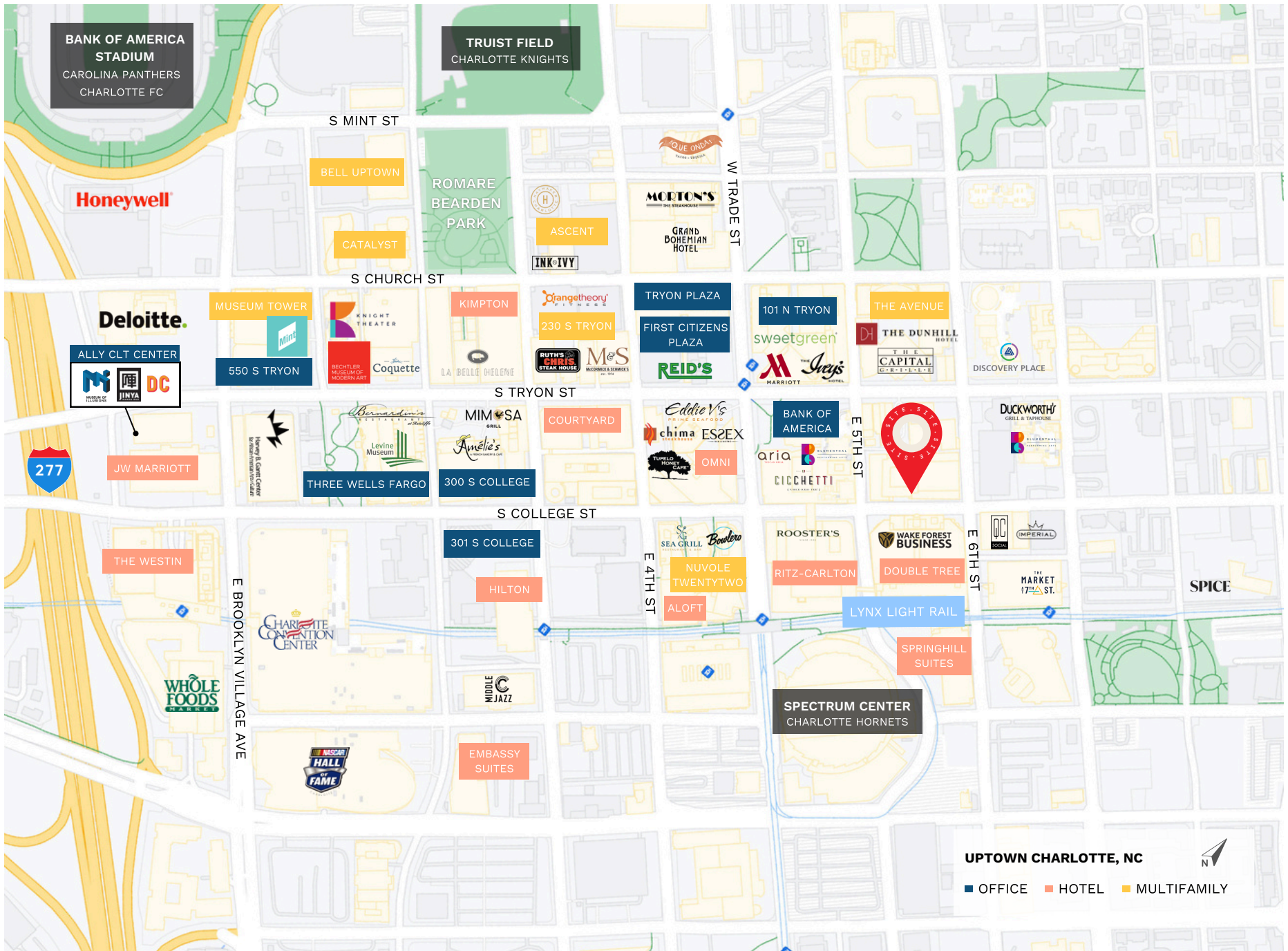

214 N. TRYON ST | CHARLOTTE, NC



INTRODUCTION

LOCATION

SITE PLAN

CONTACT

TRUIST CENTER

N. College Street Level

- Suite 100: Signed Lease
- Suite 110: Soho Bistro
- Suite 130: 2,871 SF Available**
- Suite B2: NY Bagels Deli

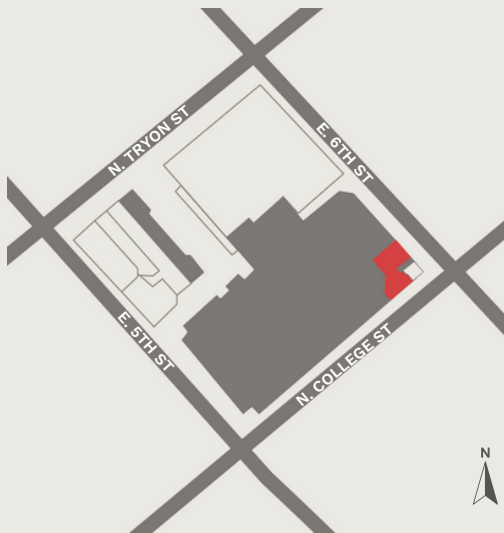
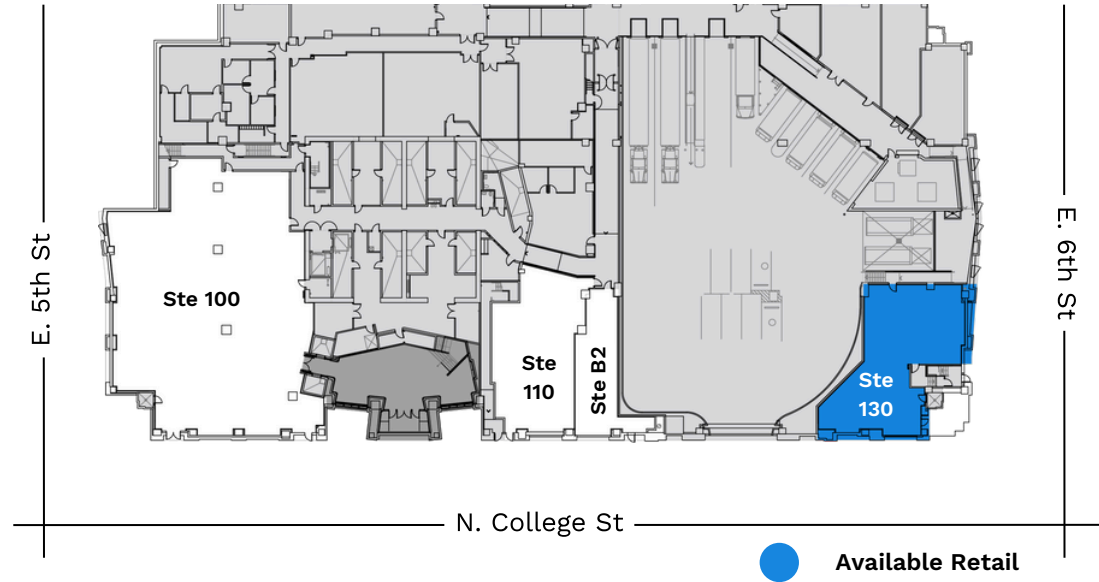



TRUIST CENTER

N. Tryon Street Level

Suite 220: Sea Level

Suite 240: Luce

PL-2: 1,607 SF Available

PL-J Truist Branch

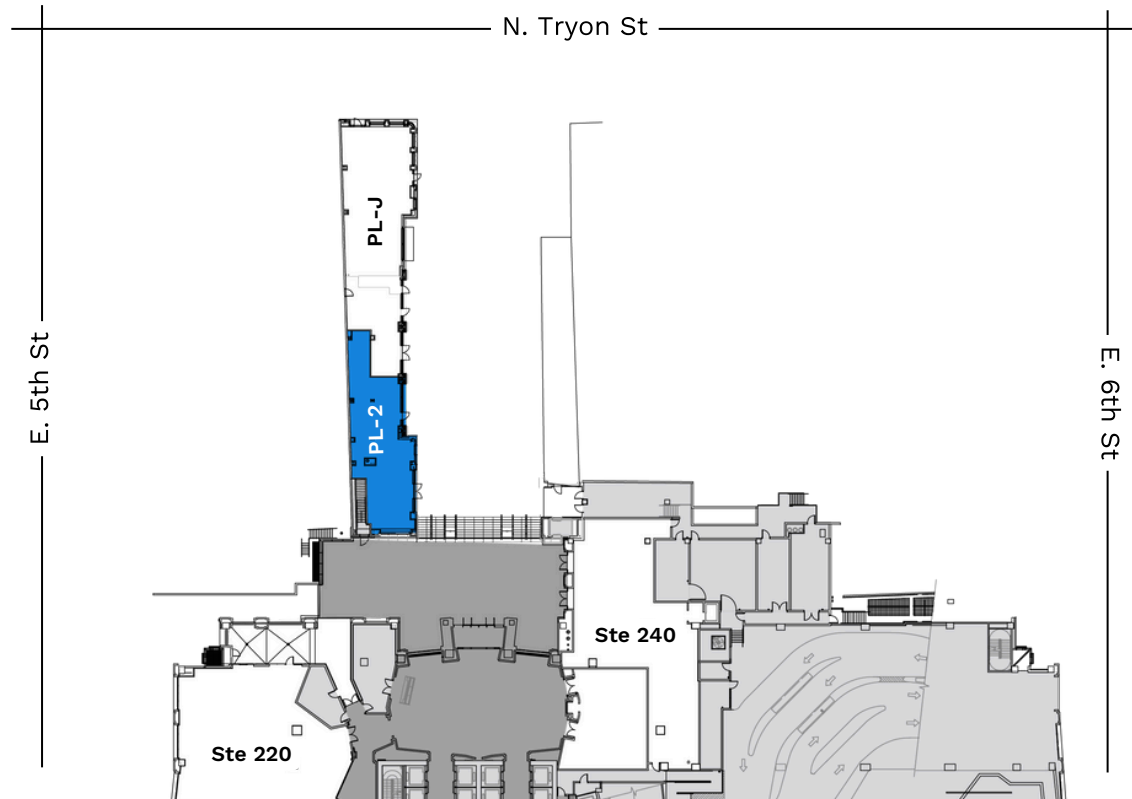
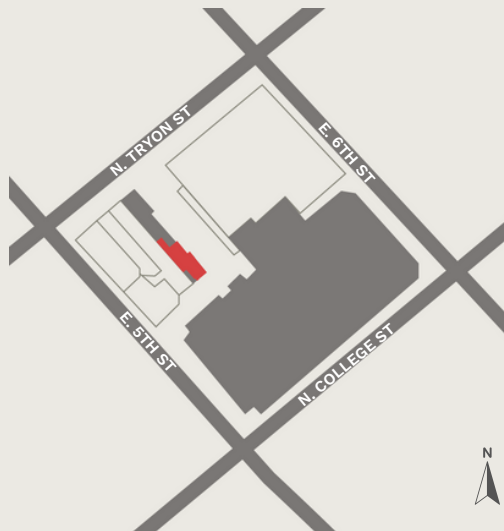

 Available Retail





INTRODUCTION

LOCATION

SITE PLAN

CONTACT

TRUIST CENTER

Overstreet Mall Level

Suite 300: 807 - 1,072 SF Available

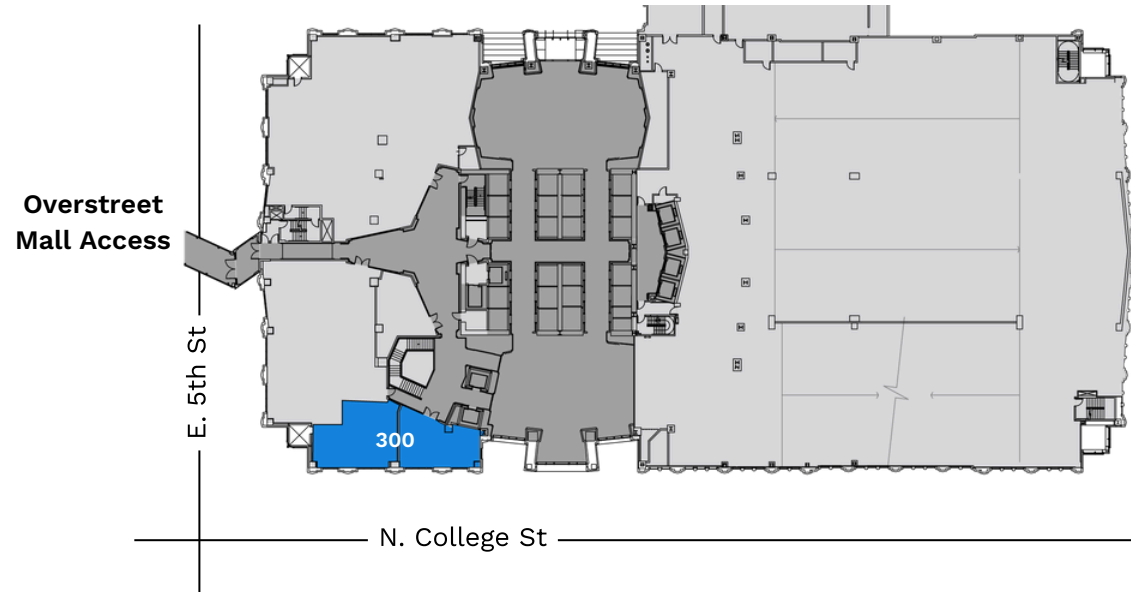

● Available Retail



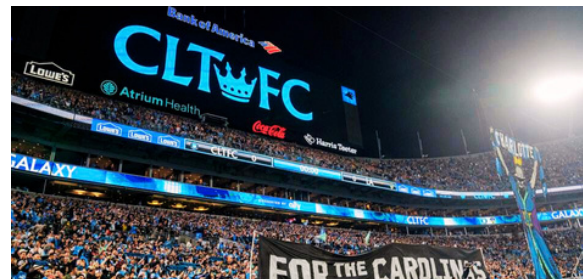
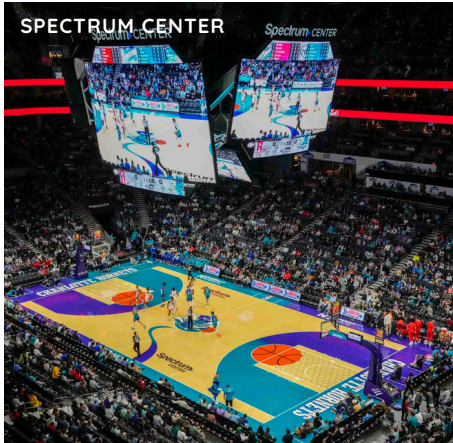

INTRODUCTION

LOCATION

SITE PLAN

CONTACT



GET IN TOUCH ▾



Cliff Benson

Cliff@ThriftCRES.com

704-989-5476