

# Warehouse

±17,160 SF Available

2255 W Desert Cove Ave  
Phoenix, AZ 85029



## Current Availability

Suite A ±17,160 SF

- 3 Dock-high Doors
- 2 Grade-level Doors

## Property Highlights

- + ±71,960 SF Facility Built in 2000
- + ±22' Clear Height
- + EVAP Cooled
- + 200A 277/480v
- + Sprinklered Warehouse
- + Fenced Yard
- + Secured Truck Court

# Truck Court



# Entrance & Parking



# Suite A ±17,160 SF

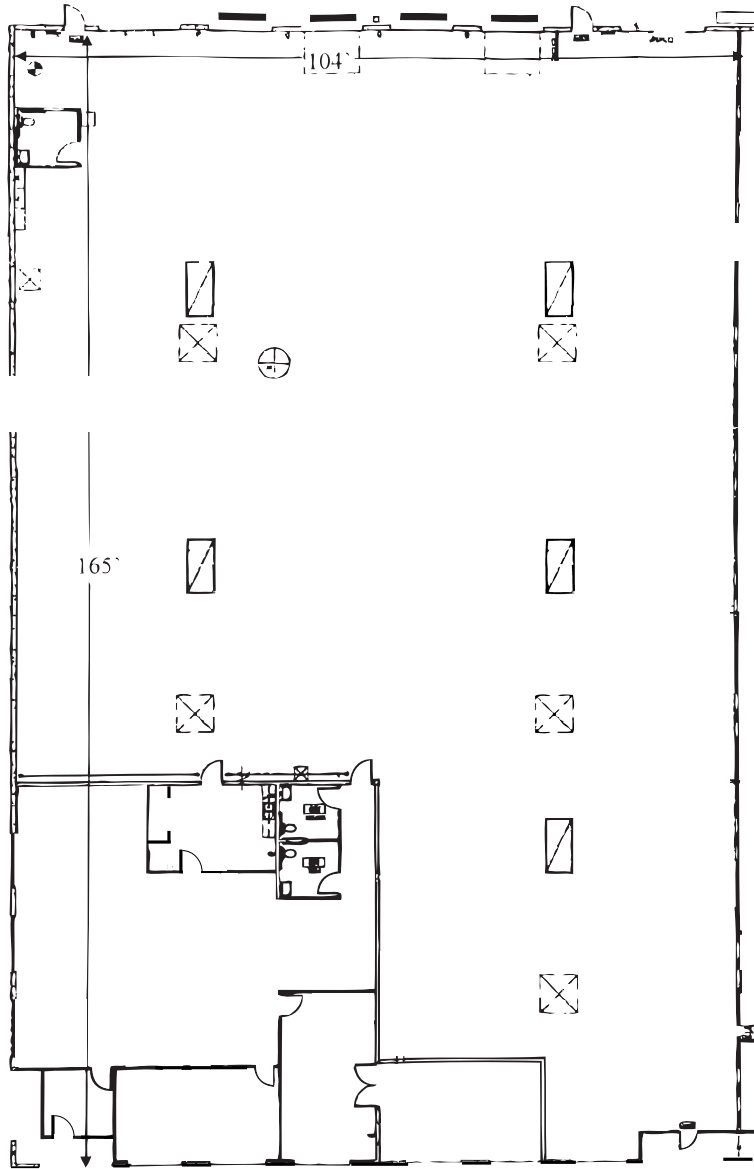

NOT TO SCALE



BUILDING PLAN



NOT TO SCALE



## Suite A ±17,160 SF

- 3 Dock-high Doors
- 2 Grade-level Doors
- 2 Private Offices
- Open Office Area
- Reception Area
- Break Room

±1 mile to Interstate 17



LEASE RATE:  
\$1.30 SF/MONTH NNN

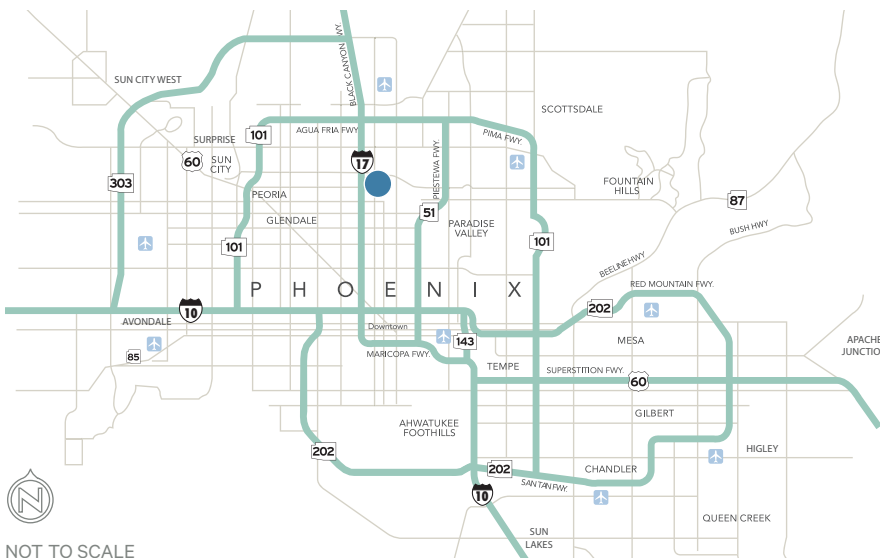

© 2024 CBRE, Inc. All rights reserved. This information has been obtained from sources believed reliable, but has not been verified for accuracy or completeness. You should conduct a careful, independent investigation of the property and verify all information. Any reliance on this information is solely at your own risk. CBRE and the CBRE logo are service marks of CBRE, Inc. All other marks displayed on this document are the property of their respective owners, and the use of such logos does not imply any affiliation with or endorsement of CBRE. Photos herein are the property of their respective owners. Use of these images without the express written consent of the owner is prohibited.

## Contact Us

**Bill Bayless**  
Senior Vice President  
+1 602 735 5652  
bill.bayless@cbre.com

