

FOR LEASE

325 N. SHEPARD ST

ANAHEIM, CA

±8,233 SQ. FT. INDUSTRIAL BUILDING
FULLY REFURBISHED



PROPERTY FEATURES

- ±8,233 Sq. Ft. Freestanding Industrial Building
- ±1,200 Sq. Ft. of Office Space
- 800 Amps, 120/208 Volt Power (Verify)
- Two (2) Ground Level Doors
- 16' Warehouse Clearance
- 2:1,000 Parking Ratio
- Fire Sprinklered (.17/3,000 GPM)
- Four (4) Restrooms
- Large Breakroom/Kitchen
- Fully Refurbished
- Convenient Access to the 91, 57 and 55 Freeways



MIKE VERNICK, CCIM, SIOR

Senior Vice President, Partner

714.935.2354

mvernick@voitco.com

Lic. # 01420885

Voit
REAL ESTATE SERVICES

HV
HEFNER
VERNICK
TEAM

2400 E. Katella Avenue
Suite 750
Anaheim, CA 92806
www.VoitCo.com

FOR LEASE

325 N. SHEPARD ST

ANAHEIM, CA

±8,233 SQ. FT. INDUSTRIAL BUILDING

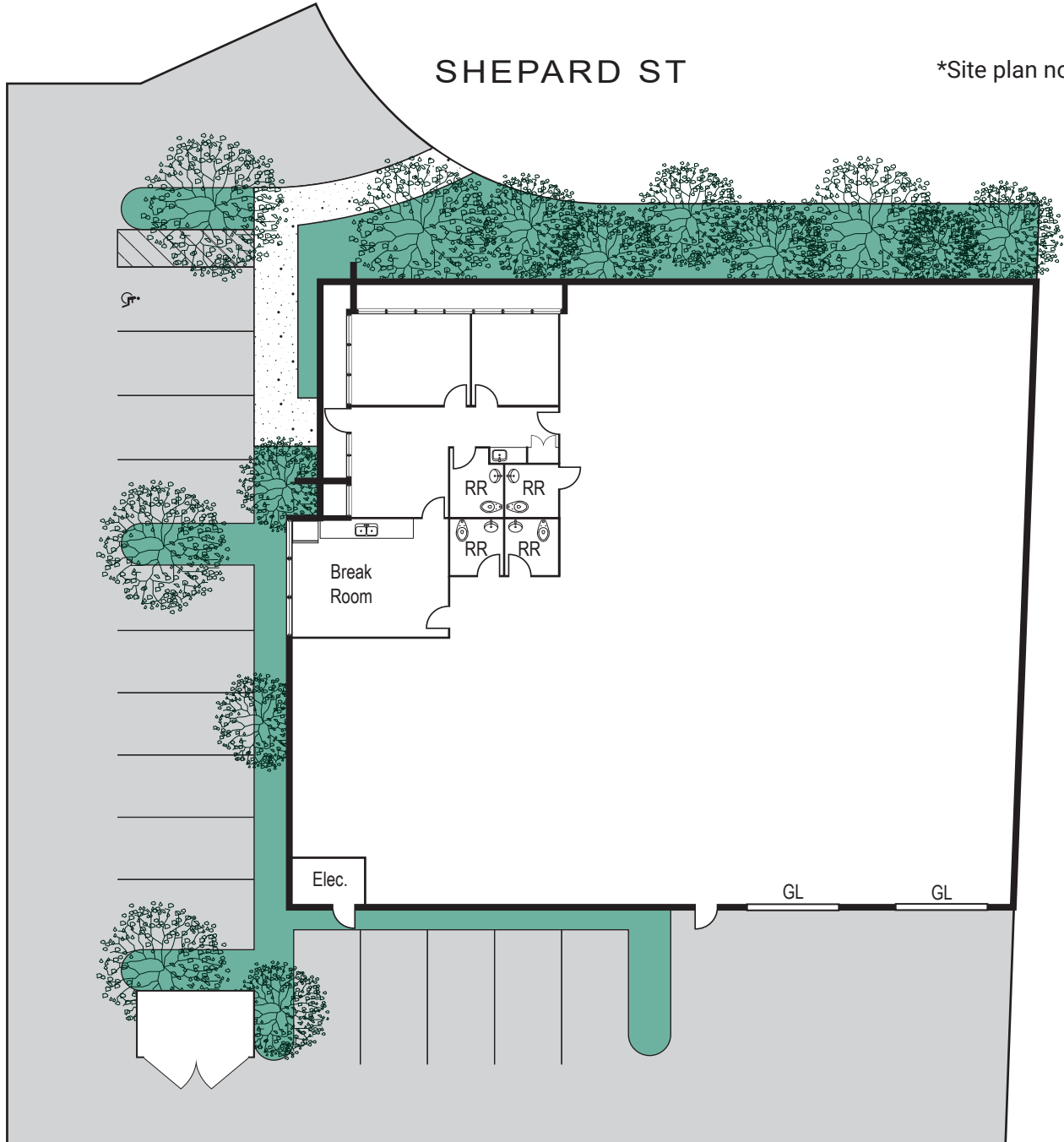

MIKE VERNICK, CCIM, SIOR

Senior Vice President, Partner

714.935.2354

mvernick@voitco.com

Lic. # 01420885

Voit
REAL ESTATE SERVICES



**HEFNER
VERNICK
TEAM**

2400 E. Katella Avenue
Suite 750
Anaheim, CA 92806
www.VoitCo.com

FOR LEASE

325 N. SHEPARD ST

ANAHEIM, CA

±8,233 SQ. FT. INDUSTRIAL BUILDING



MIKE VERNICK, CCIM, SIOR

Senior Vice President, Partner

714.935.2354

mvernick@voitco.com

Lic. # 01420885

Voit
REAL ESTATE SERVICES



2400 E. Katella Avenue
Suite 750
Anaheim, CA 92806
www.VoitCo.com