

# 204

WYTHE AVENUE

BETWEEN NORTH 4TH & NORTH 5TH STREETS  
WILLIAMSBURG

A NAIL SHOP



**ksr**  
**RETAIL SPACE  
FOR LEASE**  
Mayer Ghonoja 212.548.3945 MG@ksrny.com  
Elliot Stein 917.993.1442 EStein@ksrny.com  
Barry Fishbach 917.273.6752 Fishbach@ksrny.com



Paintbucket

A NAIL SHOP





# 204

## WYTHE AVENUE

BETWEEN NORTH 4TH & NORTH 5TH STREETS  
WILLIAMSBURG

SIZE: 1,400 SF Ground Floor

FRONTAGE: 36'

CEILING HEIGHT: 13'

POSSESSION: Immediate

ASKING RENT: Upon Request

TRANSPORTATION: 

### HIGHLIGHTS:

- Paint bucket space
- High foot traffic area
- Dense residential neighborhood
- Neighboring tenants include:  
*Aland, Chip City, FedEx, J.Crew, MUJI, Nike, Patagonia, Pure Barre, Shake Shack, Trader Joe's, Urban Outfitters, Van Leeuwen*



All information supplied in this marketing presentation and/or flyer is from sources deemed reliable and is furnished subject to errors, omissions, modifications, removal of listings from sale/lease and to any listing condition. Any square footage, dimensions, floor plans and/or technical data set forth are approximations and are subject to further elaboration/confirmation.

# 204

## WYTHE AVENUE

FLOOR PLANS:  
GROUND FLOOR - 1,400 SF

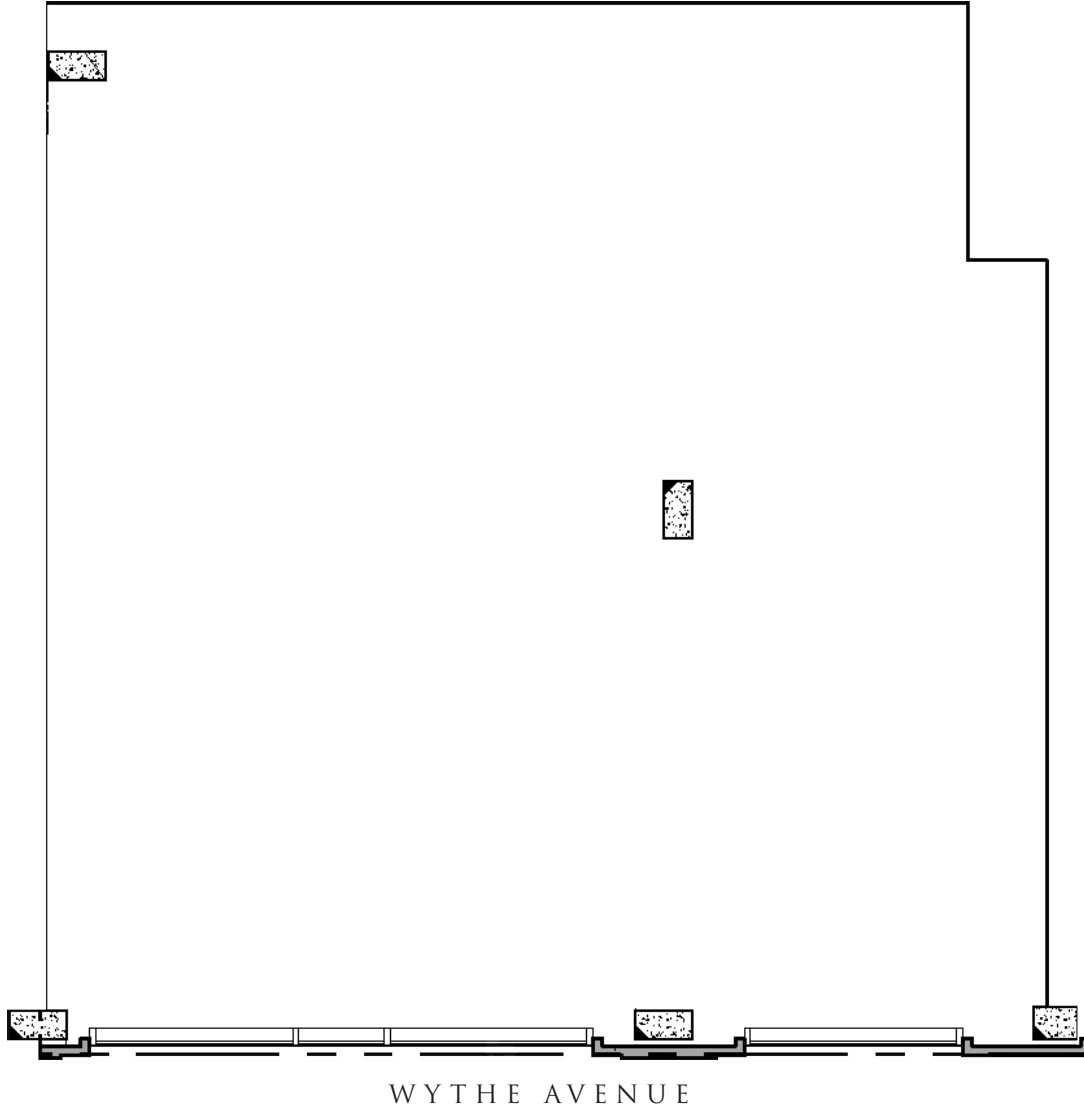

### INTERIORS:



All information supplied in this marketing presentation and/or flyer is from sources deemed reliable and is furnished subject to errors, omissions, modifications, removal of listings from sale/lease and to any listing condition. Any square footage, dimensions, floor plans and/or technical data set forth are approximations and are subject to further elaboration/confirmation.

# 204

## WYTHE AVENUE

BETWEEN NORTH 4TH & NORTH 5TH STREETS  
WILLIAMSBURG

FOR MORE INFORMATION,  
PLEASE CONTACT:

**MAYER GHONOJA**

212.548.3945 | [MG@ksrny.com](mailto:MG@ksrny.com)

**BARRY FISHBACH**

917.273.6752 | [Fishbach@ksrny.com](mailto:Fishbach@ksrny.com)

**ELLIOT STEIN**

917.993.1442 | [EStein@ksrny.com](mailto:EStein@ksrny.com)

