



# MARKET 42

Brunswick, Ohio

Citiroc Real Estate  
Jon Mavrakis

216.245.3343 / [jon@citiroc.com](mailto:jon@citiroc.com)



## ABOUT US

Introducing Market 42, the newest addition to Brunswick, Ohio's thriving landscape. This innovative market and food hall provide a unique opportunity to meet the growing demand for artisanal retail and culinary experiences in the region. With a strong demographic profile in proximity, Market 42 is ideally situated to become the go-to destination for carefully curated local artisan brands and restaurant concepts. Our focus is on sourcing farm-fresh grocery and sundry retail offerings from all corners of Ohio, creating an unparalleled experience for both visitors and locals.



# MARKET OVERVIEW

14

Retail Food Stalls

11

Food Hall Restaurants

1

Full Bar serving local beer + craft cocktails



## DIMENSIONS

Total Market Size – 25,610 square feet

Ample Parking – 133 parking spaces

Approx 8,000 square feet of indoor/outdoor dining





# SITE PLAN

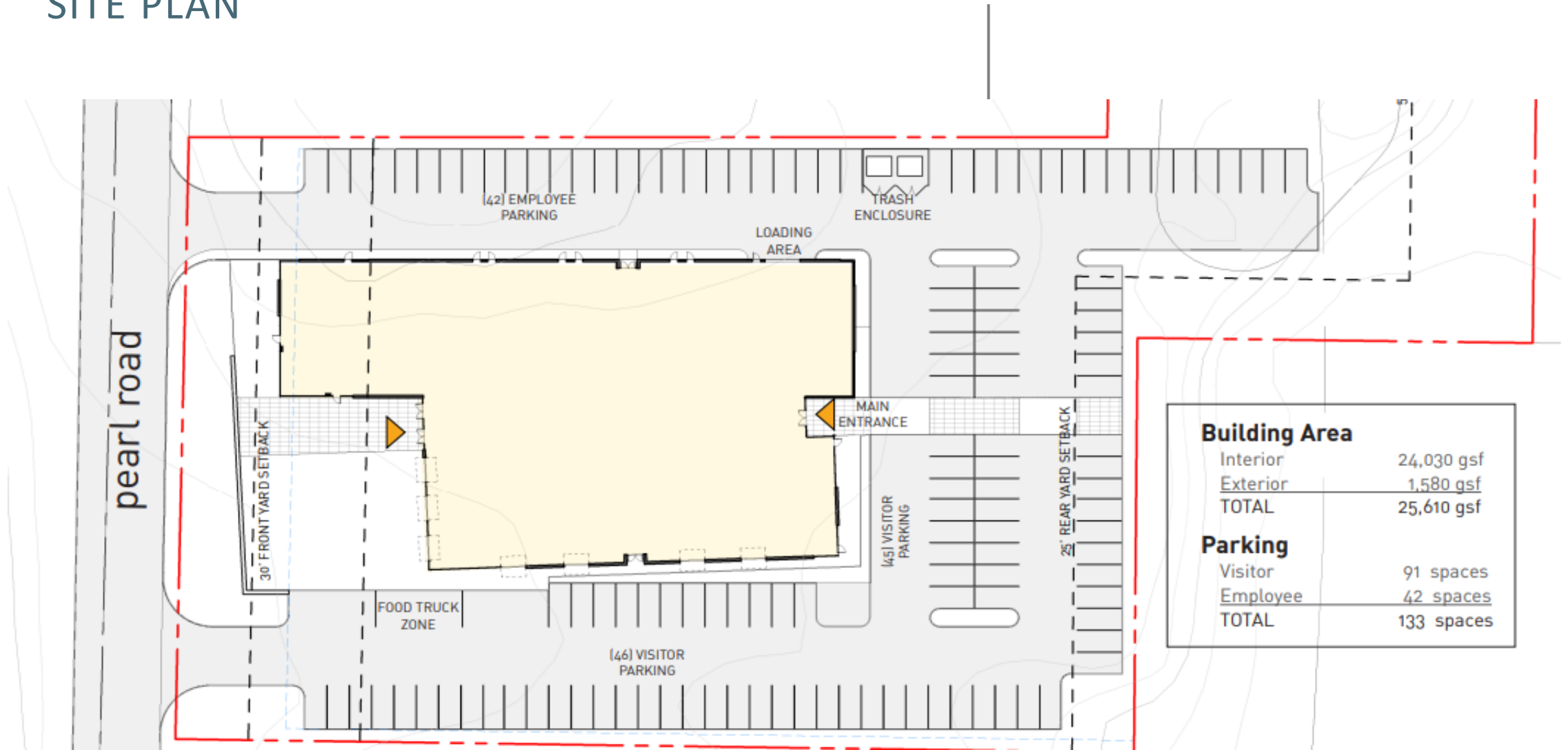

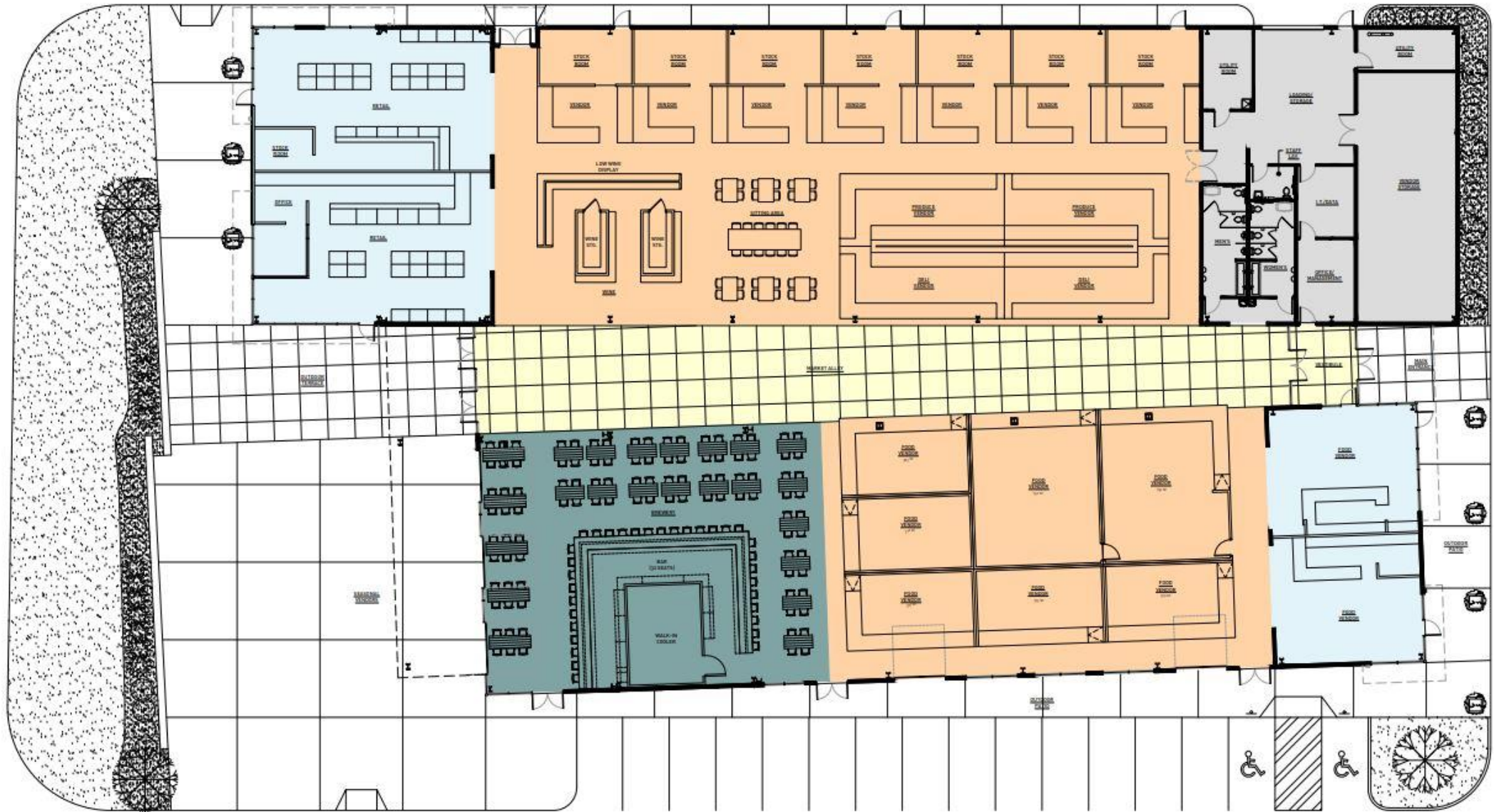

Click here for Virtual Tour: <https://1drv.ms/v/s!AtrAjDgIhJoj7zojmKqm5HAumMCA?e=w2LSH9>



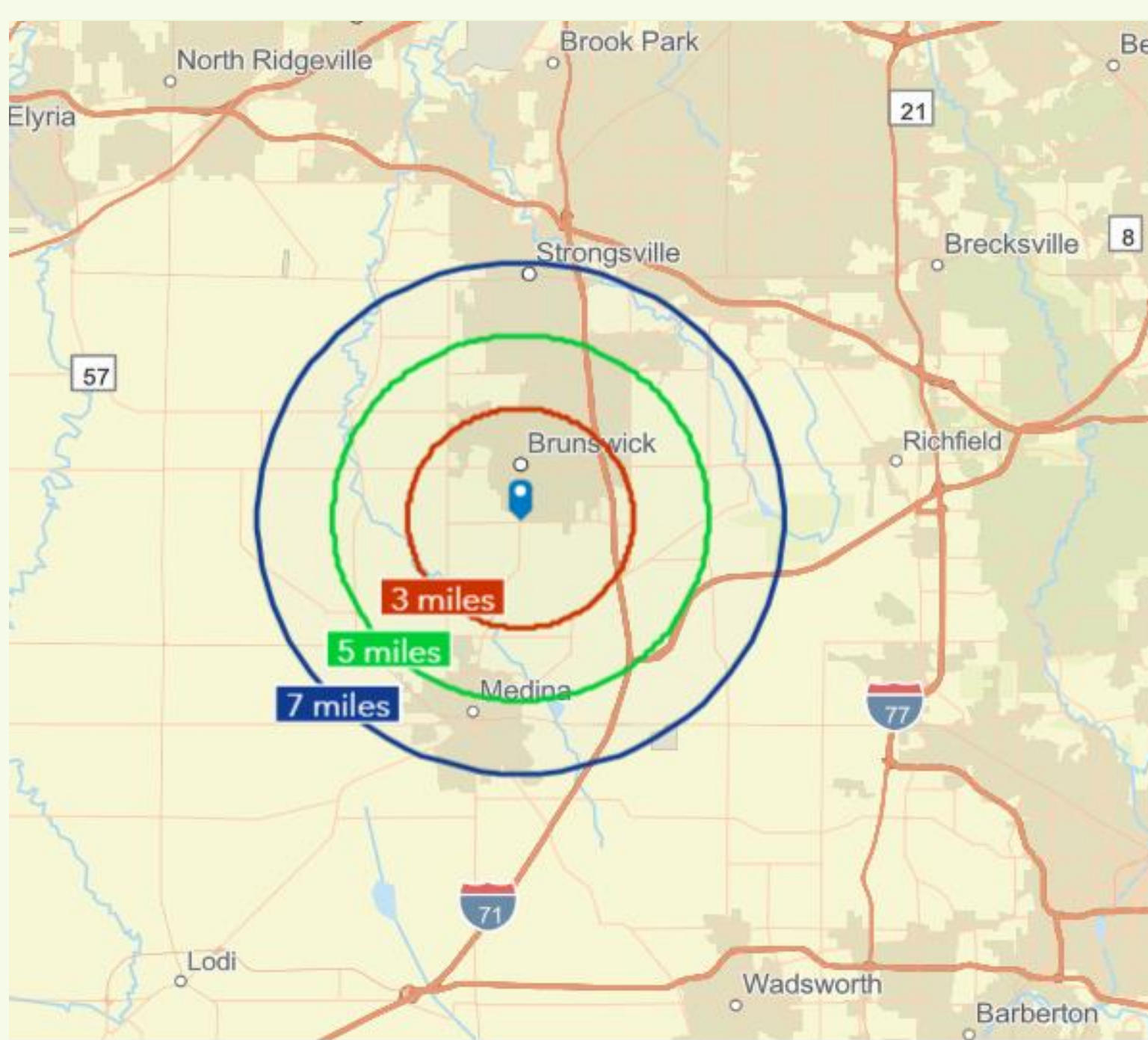

## BRUNSWICK, OHIO

- Located 20 miles southwest of Cleveland.
- 13 square miles with a population of 35,272.
- Accessible via I-71 & multiple major thoroughfares
- Rapidly growing community & household formation.
- Proximity to large population with above average income

# LOCATION



Southpark Mall

High School, Rec Center and Sports Fields

Logos for Brunswick, Burger King, getGo, KFC, Steak 'n Shake, Liberty, Subaru, Jersey Mike's, Bob Evans, and Marcs.

Logos for The Home Depot, Starbucks, Dunkin', Chipotle, Giant Eagle, Comfort Suites, Chick-fil-A, Scene, McDonald's, and Quality.

COSTCO

Logos for AutoZone, Walgreens, ALDI, and DG.

meijer

drees HOMES  
18 New Homes

Logos for Walmart, The Home Depot, Hobby Lobby, Marshalls, Kohl's, Giant Eagle, Target, Staples, and Tractor Supply Co.

MAPLESIDE  
FARMS

CONRAD'S

Redwood  
105 Single Family Rentals

BUNKER HILL  
GOLF COURSE

Shale Creek

MAIN STREET  
MEDINA

### KEY FACTS

111,968

Population



Average Household Size

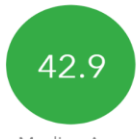

Median Age

\$78,377

Median Household Income

### EDUCATION



No High School Diploma



27%

High School Graduate



31%

Some College



38%

Bachelor's/Grad/Pr of Degree

### BUSINESS



3,777

Total Businesses



44,766

Total Employees

### EMPLOYMENT



White Collar



Blue Collar



Services

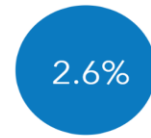

Unemployment Rate

### INCOME



\$78,377

Median Household Income



\$38,660

Per Capita Income



\$271,459

Median Net Worth

### Households By Income

The largest group: \$100,000 - \$149,999 (21.1%)

The smallest group: <\$15,000 (4.9%)

Indicator ▲	Value	Diff	
<\$15,000	4.9%	-0.3%	█
\$15,000 - \$24,999	5.6%	0	█
\$25,000 - \$34,999	7.2%	-0.3%	█
\$35,000 - \$49,999	12.1%	-0.5%	█
\$50,000 - \$74,999	17.9%	-0.2%	█
\$75,000 - \$99,999	13.1%	-0.2%	█
\$100,000 - \$149,999	21.1%	+0.5%	█
\$150,000 - \$199,999	9.9%	+1.0%	█
\$200,000+	8.1%	0	█

Bars show deviation from Medina County



# MARKET DEMAND

\$102M

Total Retail Demand  
5-minute drive

\$671M

Total Retail Demand  
10-minute drive

\$1.6B

Total Retail Demand  
15-minute drive

\*Esri 2023



# FOOD + DRINK

## Market Demand

\$11.01M

5 Minute Drive

\$72.66M

10 Minute Drive

\$174M

15 Minute Drive



# MARKET OPPORTUNITIES



## FOOD HALL

Spaces available from  
383 SF - 700 SF



## INDOOR MARKET

Spaces available from  
446 Sf – 1,200 SF



## OUTDOOR MARKET

Various seasonal  
opportunities  
Inquire for pricing

# PARTNER WITH US!