

Summary

Parcel Number 15030750
Location Address 1040 1044 EASTLAND DR
 LEXINGTON KY 40505
Tax District District 01
Tax Rate 1.2643
Acres 0.72
Legal Description K-189 LOT 10 11 12
Property Class C - COMMERCIAL
PVA Neighborhood 721 - WINCHESTER
Land Use Code (410) C-INDUSTRIAL
USA/RSA Map 26
Map Block 034
Lot 10 11 12
Subdivision PICKLESIMER UNIT-1
Cabinet/Slide K-189
ND-1 Zone
Overlay
PDR
Map Scale 200
Block B
LFUCG Zoning I-1 - LIGHT INDUSTRIAL
Deeded SqFt 31,363
Frontage / Out of 141.3 /



Owner

[EASTLAND DRIVE INDUSTRIAL LLC](#)
 3509 CAICOS CT
 LEXINGTON KY 40509
January 1, 2024 Owner
 EASTLAND DRIVE INDUSTRIAL LLC

Commercial Improvement Information

Card	1	Year Built	1970
Building No	1	Above Grade Sqft	17,892
Structure Code/Desc	397-OFIC WRHSE	Total Basement Sqft	
Units	1		

Accessory Information

Card 1

Description	Year Built	Size	Area	Grade
PAVING ASPHALT PARKING	1970		10,000	C -AVERAGE

Sales

Sale Date	Sale Price	Deed Book	Deed Page	Sales Validity	Owner	Previous Owner	Recording
4/8/2022	\$1,800,000	3930	103	MULTIPLE PROPERTIES	EASTLAND DRIVE INDUSTRIAL LLC	MCB ENTERPRISES LLC	3930 103
4/6/2001	\$508,500	2196	711	MULTIPLE PROPERTIES	MCB ENTERPRISES LLC	PICKLESIMER F M SR	2196 711
3/30/1971	\$0	1011	221	ARMS LENGTH TRANSACTION	PICKLESIMER F M SR	PICKLESIMER F M JR	1011 221

Valuation

	2023	2022	2021	2020
Fair Cash Value	\$1,062,000	\$1,078,200	\$536,700	\$536,700
Agricultural Value Land	\$0	\$0	\$0	\$0
Agricultural Value Total	\$0	\$0	\$0	\$0
Exempt	\$0	\$0	\$0	\$0
Taxable Value	\$1,062,000	\$1,078,200	\$536,700	\$536,700

Sketches

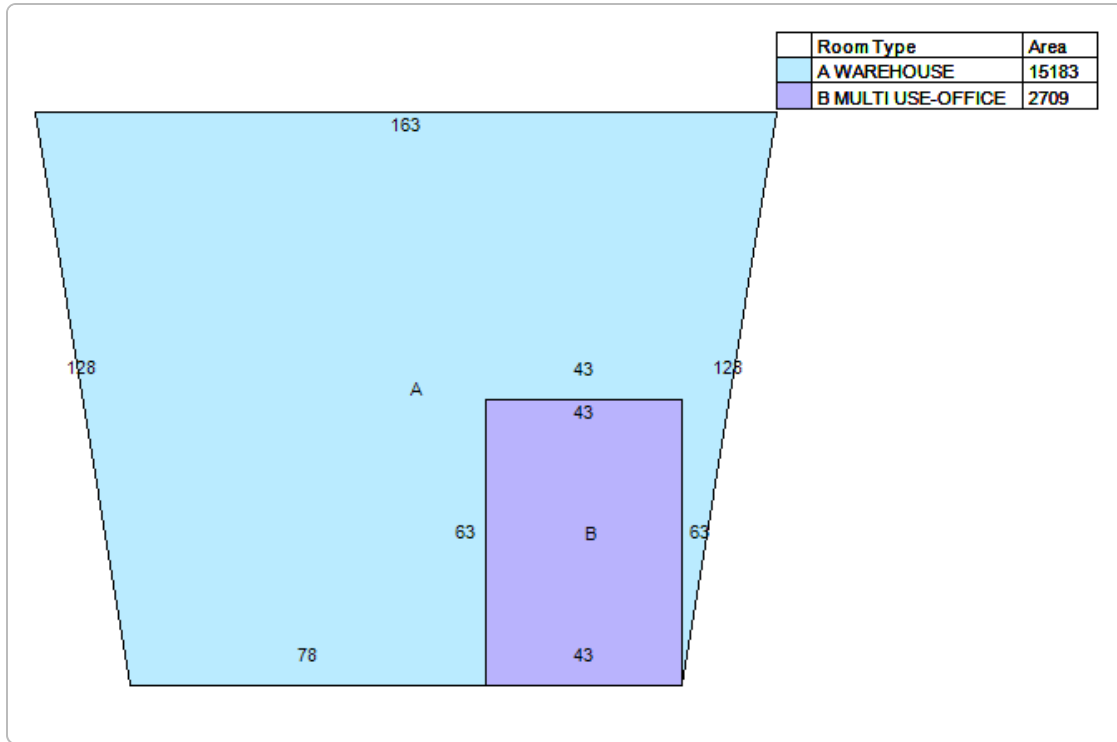

Photos



No data available for the following modules: Assessment Notice, Residential Improvement Information, Comparable Sales List, .

The Fayette County Property Valuation Administrator's Office makes every effort to produce the most accurate information possible. No warranties, expressed or implied, are provided for the data herein, its use or interpretation.
 | [User Privacy Policy](#) | [GDPR Privacy Notice](#)
 Last Data Upload: 4/9/2024, 5:38:14 AM

[Contact Us](#)

Developed by
 Schneider
 GEOSPATIAL