

# INDUSTRIAL BUILDING FOR LEASE

## 60 E 4TH STREET

SOMERVILLE, NJ 08876



## PROPERTY OVERVIEW

<b>BUILDING SF:</b>	16,842 SF
<b>AVAILABLE SF:</b>	16,842 SF
<b>MIXED OFFICE &amp; FINISHED AREA:</b>	3,000 - 3,500 SF
<b>WAREHOUSE/SHOP AREA:</b>	10,842 SF - 11,842 SF
<b>ASKING RATE:</b>	New Pricing - CALL FOR PRICING
<b>TAXES &amp; PROPERTY INSURANCE:</b>	\$3.01/SF
<b>CEILING HEIGHT:</b>	16' Clear
<b>LOADING:</b>	2 Drive-Ins, 1 Tailgate
<b>POWER:</b>	Heavy
<b>SPRINKLER:</b>	Wet
<b>AVAILABILITY:</b>	Immediate

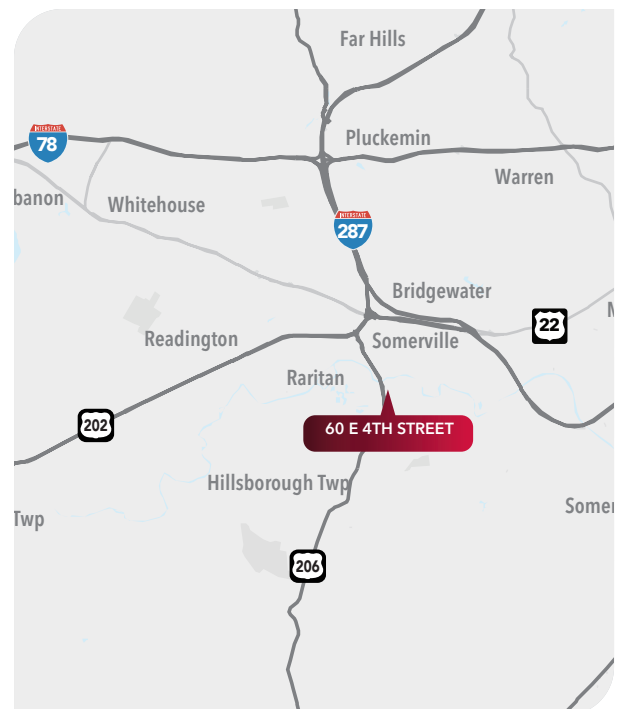

## FOR MORE INFORMATION CONTACT EXCLUSIVE BROKERS:

**Jeffrey Furey**  
jeffrey.furey@lee-associates.com  
C 609.915.1285

**Lori Zuck**  
lori.zuck@lee-associates.com  
C 201.259.8888

All information furnished regarding property for sale, rental or financing is from sources deemed reliable, but no warranty or representation is made to the accuracy thereof and same is submitted to errors, omissions, change of price, rental or other conditions prior to sale, lease or financing or withdrawal without notice. Buyer acknowledges that Lee & Associates of New Jersey, LLC ("Broker") has not verified the information contained herein and does not make any representation about its accuracy. Buyer should confirm information contained in the Offering using its own sources. No liability of any kind is to be imposed on Broker herein.

# INDUSTRIAL BUILDING FOR LEASE

## 60 E 4TH STREET

SOMERVILLE, NJ 08876

### FLOORPLAN

60 4th Street, Somerville, NJ

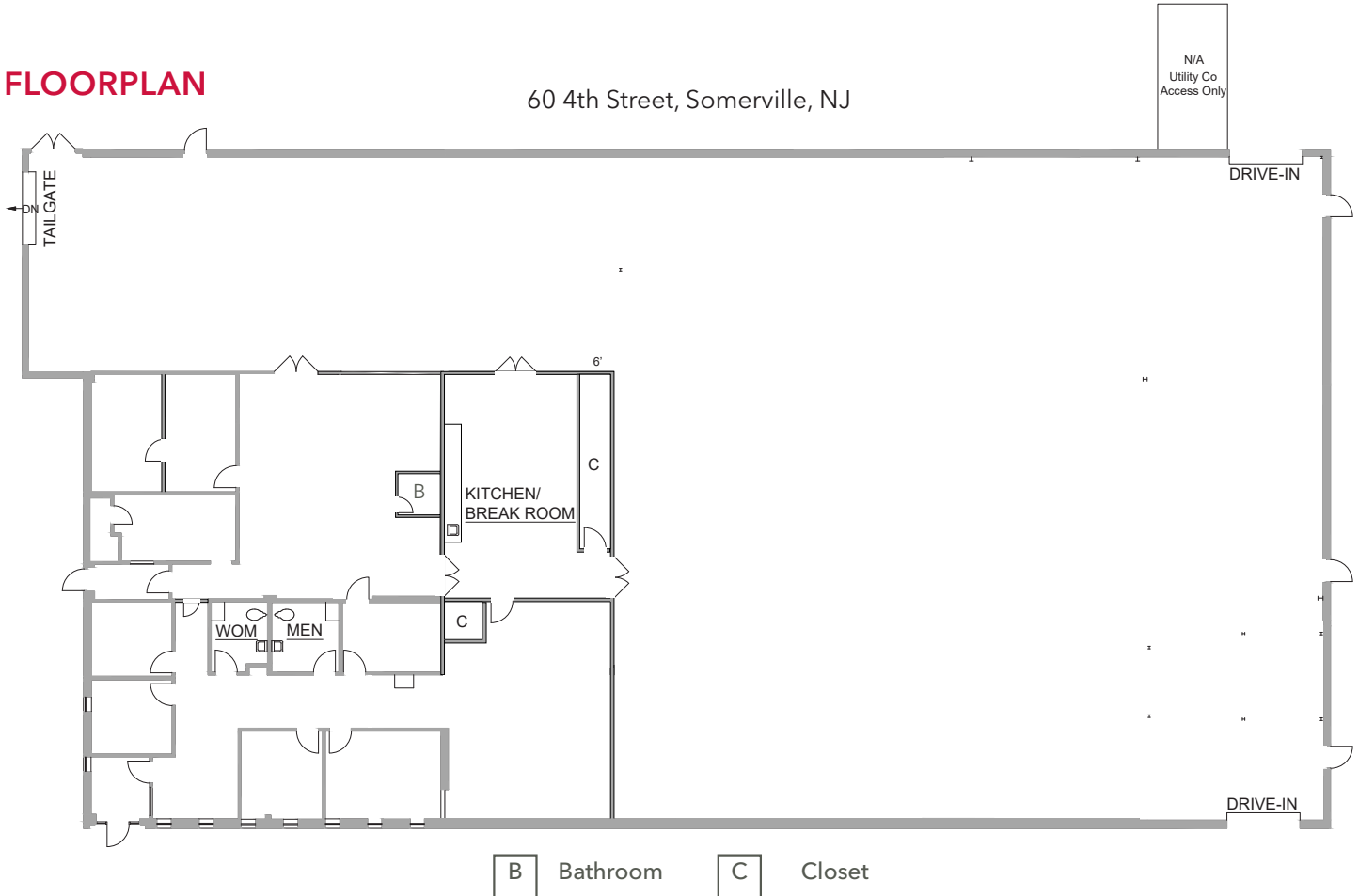

### PROPERTY PHOTOS



### FOR MORE INFORMATION CONTACT EXCLUSIVE BROKERS:

**Jeffrey Furey**  
jeffrey.furey@lee-associates.com  
C 609.915.1285

**Lori Zuck**  
lori.zuck@lee-associates.com  
C 201.259.8888

All information furnished regarding property for sale, rental or financing is from sources deemed reliable, but no warranty or representation is made to the accuracy thereof and same is submitted to errors, omissions, change of price, rental or other conditions prior to sale, lease or financing or withdrawal without notice. Buyer acknowledges that Lee & Associates of New Jersey, LLC ("Broker") has not verified the information contained herein and does not make any representation about its accuracy. Buyer should confirm information contained in the Offering using its own sources. No liability of any kind is to be imposed on Broker herein.