



MEDICAL PROFESSIONAL
OFFICE FOR LEASE
DOWNTOWN NAPERVILLE



Property Overview

The Property is conveniently located on the east side of Washington Street Downtown Naperville and abuts the Riverwalk. The 5 spots per 1,000 square feet provides the best parking in downtown Naperville. Inclusive of on-site property management and prompt communication.

The downtown location provides unique family-owned shops, nationally recognized retailers, distinctive restaurants and picturesque Riverwalk.

Property Facts

Building Type	Office
Year Build/Renovated	1982 / 2022
Building Height	2 Stories
Building Siize	30,000 SF
Buildinig Class	B
Typical Floor Size	15,000 SF
Unfinished Ceiling Height	12'
Parking	110 Surface Parking Space

Select Tenants

Cassey Tool LTD
Cassano & Calvo Law
Edward-Elmhurst Memorial Hospital
Ellsworth Partners
First American Title
Kuhn, Heap & Monson
Law Office of Pihliip R. Nathe
Patric Commercial Real Estate
Proper Title, LLC



Matt Calvo
Broker- Ellsworth Partners, LLC
630 995 3605
matt@ellsworthpartnersllc.com



Charlie Calvo
Broker- Ellsworth Partners, LLC
630 995 3605
charlie@ellsworthpartnersllc.com





Suite 209

- 492.93 SQUARE FEET
 - \$26 /SF/YR BASE RENT
 - ABOUT \$7 /SQUARE FOOT ADDITIONAL RENT
-

- \$16,266 ANNUAL RENT
 - \$1,355 MONTHLY RENT
-

- AVAILABLE NOW
- LANDLORD OFFERING GENEROUS TENANT IMPROVEMENT



Suite 218

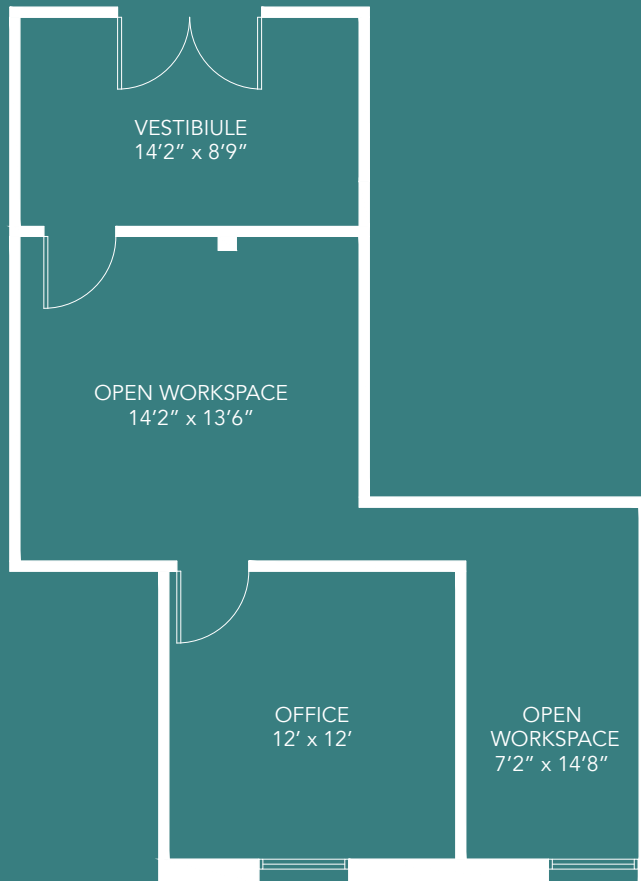

- 752 SQUARE FEET
 - \$22 /SF/YR BASE RENT
 - ABOUT \$7.00 /SQUARE FOOT ADDITIONAL RENT
-

- \$21,808 ANNUAL RENT
 - \$1,817.33 MONTHLY RENT
-

- AVAILABLE NOW
- LANDLORD OFFERING GENEROUS TENANT IMPROVEMENT



552 S. Washington St. Naperville, Illinois 60540

Suite 220

- 1,442.81 SQUARE FEET
- \$24 /SF/YR BASE RENT
- ABOUT \$7.00 /SQUARE FOOT ADDITIONAL RENT

-
- \$44,727 ANNUAL RENT
 - \$3,727 MONTHLY RENT

-
- AVAILABLE NOW
 - RECENTLY REMODELED HIGH END DENTIST SUITE

